



**JANUARY 1ST**

**2018**

**INDUSTRIAL  
EQUIPMENT  
PRICE GUIDE**

# Made in the USA

Amid all the hustle and bustle of one of the fastest growing towns in Iowa, you'll find the Mi-T-M Corporation. The thriving community of Peosta is home to this American manufacturing success story. From the very first pressure washer built in 1971 in the garage of company founder and CEO, AJ Spiegel, to 2018 where equipment is manufactured in a modern one million square foot complex, the success is defined by nearly 400 dedicated employees. Employees who, with the help of state-of-the-art equipment, bend and laser-cut steel, weld, powder coat and assemble equipment every day. The rhythmic and steady hum of manufacturing reminds us of what the opportunity to build equipment in Peosta really means. It means agility and flexibility and never compromising the quality of Mi-T-M equipment.

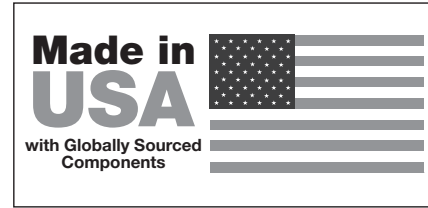

We're fortunate to have partnered with outstanding companies who supply high quality components for our equipment. We demand the best and we get the best. Engines, pumps, hoses and a variety of parts are delivered to Peosta and assembled in the best built equipment in our industry.

Manufacturing equipment right here in the middle of America has a special meaning to all of us, but most importantly, it means an economic future for 400 loyal employees. Mi-T-M is committed to our local workers and building stronger economies. We are proud to state we manufacture and assemble our products here in the USA.

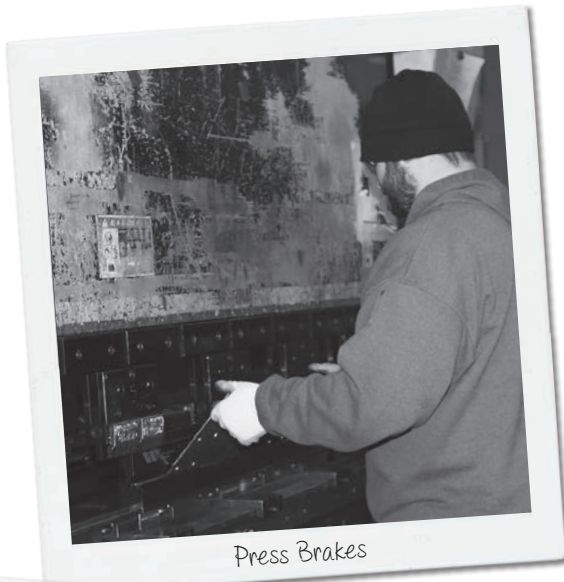

Press Brakes

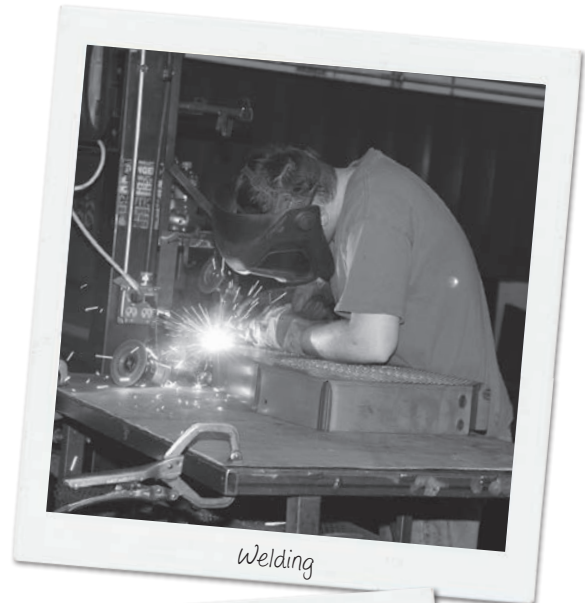

Welding



Powder Coat Line



Production Lines

## CD Series Gasoline Direct Drive



CD-2003-3MHH

- Performance-proven OHV engine with low-oil shutdown
- Direct drive triplex piston AR pump with ceramic plungers
- Powder coated steel mounting plate with center balanced lift and four rubber isolators
- 3 year limited Honda engine warranty
- 7 year limited AR pump warranty

MODEL NUMBER	PSI	GPM	DISPLACEMENT/ENGINE	PUMP	SHIP WT.	NET WT.	LIST PRICE
CD-2003-3MHH	2000	2.7	196cc Honda GX200 OHV	AR	75 lb.	56 lb.	\$1,660.00

### Accessories:

PART NUMBER	DESCRIPTION	FITS MODEL	LIST PRICE
50-0161	High pressure detergent injector - High pressure washer mixes with detergent to clean even the toughest build-up	CD-2003-3MHH	\$107.00
851-0338	50-ft. x 3/8-in. non-marking hose - For when you need extra hose for added mobility	CD-2003-3MHH	\$274.00

## JP Series Gasoline Direct Drive



JP-3504-3MHB

- Direct drive triplex piston AR or Mi-T-M pump with ceramic plungers
- Stainless-steel and brass Mi-T-M unloader with adjustable pressure
- Powder coated steel frame and base plate with 1 1/4-inch tube handles
- 13-inch flat-free tires (10-inch on 2400, 2700 and 3000-PSI models)
- 1 year limited Mi-T-M unloader warranty
- 3 year limited Honda engine warranty
- 7 year limited AR and Mi-T-M pump warranties

MODEL NUMBER	PSI	GPM	DISPLACEMENT/ENGINE	PUMP	SHIP WT.	NET WT.	LIST PRICE
JP-2403-3MHB	2400	2.4	196cc Honda GX200 OHV	Mi-T-M	100 lb.	75 lb.	\$1,820.00
JP-2703-3MHB	2700	2.4	196cc Honda GX200 OHV	Mi-T-M	110 lb.	85 lb.	\$1,910.00
JP-3003-3MHB	3000	3.0	270cc Honda GX270 OHV	AR	180 lb.	130 lb.	\$2,555.00
JP-3504-3MHB	3500	3.5	389cc Honda GX390 OHV	AR	192 lb.	142 lb.	\$3,035.00
JP-4004-3MHB	4000	3.5	389cc Honda GX390 OHV	AR	192 lb.	142 lb.	\$3,195.00

### Accessories & Options:

PART NUMBER	DESCRIPTION	FITS MODELS	LIST PRICE
50-0161	High pressure detergent injector - High pressure water mixes with detergent to clean even the heaviest build-up	All models	\$107.00
851-0338	50-ft. x 3/8-in. non-marking hose - For when you need extra hose for added mobility	All models	\$274.00
AW-8400-0021	Low pressure detergent injector - Allows the user to apply the recommended detergents	All models	\$87.00
CX-0005	36-in. insulated dual lance - Has high and low pressure tips that allow you to switch to the low pressure detergent injector without having to change tips	2400 to 3000-PSI models	\$200.00
CX-0083	External bypass system - Allows more water into the system to protect from heat build-up	2400 to 2700-PSI models	\$222.00
CX-0084	External bypass system - Allows more water into the system to protect from heat build-up	3500 to 4000-PSI models	\$191.00

**CA Aluminum Series**  
 Gasoline Direct Drive



CA-3003-1MAK

- Direct drive triplex piston AR, General or Mi-T-M pump with ceramic plungers
- Stainless-steel and brass Mi-T-M unloader with adjustable pressure
- Patented vibration isolation plate
- Aluminum frame and base plate with 1¼-inch tube handles
- 13-inch flat-free tires (10-inch on 2400, 2700 and 3000-PSI models)
- 1 year limited Mi-T-M unloader warranty
- 3 year limited Honda and Kohler engine warranties
- 7 year limited AR and Mi-T-M pump warranties

MODEL NUMBER	PSI	GPM	DISPLACEMENT/ENGINE	PUMP	SHIP WT.	NET WT.	LIST PRICE
CA-2403-1MMH	2400	2.4	196cc Honda GX200 OHV	Mi-T-M	100 lb.	73 lb.	\$1,885.00
CA-2703-1MMH	2700	2.4	196cc Honda GX200 OHV	Mi-T-M	100 lb.	73 lb.	\$1,970.00
CA-2703-1MMK	2700	2.4	208cc Kohler CH270 OHV	Mi-T-M	100 lb.	73 lb.	\$1,760.00
CA-3003-1MAH	3000	3.0	270cc Honda GX270 OHV	AR	155 lb.	105 lb.	\$2,725.00
CA-3003-1MAK	3000	3.0	277cc Kohler CH395 OHV	AR	155 lb.	105 lb.	\$2,375.00
CA-3504-1MAH	3500	3.5	389cc Honda GX390 OHV	AR	175 lb.	125 lb.	\$3,045.00
CA-3504-1MGH*	3500	4.0	389cc Honda GX390 OHV	General	175 lb.	125 lb.	\$3,245.00
CA-4004-1MAH	4000	3.5	389cc Honda GX390 OHV	AR	175 lb.	125 lb.	\$3,150.00
CA-4004-1MAK	4000	3.5	429cc Kohler CH440 OHV	AR	175 lb.	125 lb.	\$2,715.00
CA-4004-1MGH*	4000	4.0	389cc Honda GX390 OHV	General	175 lb.	125 lb.	\$3,310.00

\*Model comes standard with external bypass system.

**Accessories & Options:**

PART NUMBER	DESCRIPTION	FITS MODELS	LIST PRICE
50-0161	High pressure detergent injector - High pressure water mixes with detergent to clean even the heaviest build-up	All models	\$107.00
851-0338	50-ft. x ¾-in. non-marking hose - For when you need extra hose for added mobility	All models	\$274.00
AW-8400-0021	Low pressure detergent injector - Allows the user to apply the recommended detergents	All models	\$87.00
CX-0005	36-in. insulated dual lance - Has high and low pressure tips that allow you to switch to the low pressure detergent injector without having to change tips	2400 to 3000-PSI models	\$200.00
CX-0097	External bypass system - Allows more water into the system to protect from heat build-up	2400 to 2700-PSI models	\$119.00
CX-0098	External bypass system - Allows more water into the system to protect from heat build-up	3500 to 4000-PSI models except 1MGH	\$135.00
CX-0099	External bypass system - Allows more water into the system to protect from heat build-up	3000-PSI models	\$135.00

**CBA Aluminum Series**  
 Gasoline Belt Drive



CBA-4004-1MGH

- Belt drive triplex piston AR or General pump with ceramic plungers
- Stainless-steel and brass Mi-T-M unloader with adjustable pressure
- Patented vibration isolation plate
- Aluminum frame and base plate with 1¼-inch tube handles
- Two-piece belt guard
- 13-inch flat-free tires
- 1 year limited Mi-T-M unloader warranty
- 3 year limited Honda and Kohler engine warranties
- 7 year limited AR and General pump warranties

MODEL NUMBER	PSI	GPM	DISPLACEMENT/ENGINE	PUMP	SHIP WT.	NET WT.	LIST PRICE
CBA-3504-1MAH	3500	3.7	389cc Honda GX390 OHV	AR	215 lb.	165 lb.	\$3,620.00
CBA-3504-1MAK	3500	3.7	429cc Kohler CH440 OHV	AR	215 lb.	165 lb.	\$3,175.00
CBA-3504-1MGH*	3500	4.0	389cc Honda GX390 OHV	General	215 lb.	165 lb.	\$3,990.00
CBA-4004-1MAH	4000	3.4	389cc Honda GX390 OHV	AR	215 lb.	165 lb.	\$3,660.00
CBA-4004-1MAK	4000	3.4	429cc Kohler CH440 OHV	AR	215 lb.	165 lb.	\$3,205.00
CBA-4004-1MGH*	4000	4.0	389cc Honda GX390 OHV	General	215 lb.	165 lb.	\$4,045.00

\*Model comes standard with external bypass system.

**Accessories & Options:**

PART NUMBER	DESCRIPTION	FITS MODELS	LIST PRICE
50-0161	High pressure detergent injector - High pressure water mixes with detergent to clean even the heaviest build-up	All models	\$107.00
851-0338	50-ft. x ¾-in. non-marking hose - For when you need extra hose for added mobility	All models	\$274.00
AW-8400-0021	Low pressure detergent injector - Allows the user to apply the recommended detergents	All models	\$87.00
CX-0082	External bypass system - Allows more water into the system to protect from heat build-up	All models except 1MGH	\$274.00

## JCW Series Gasoline Belt Drive

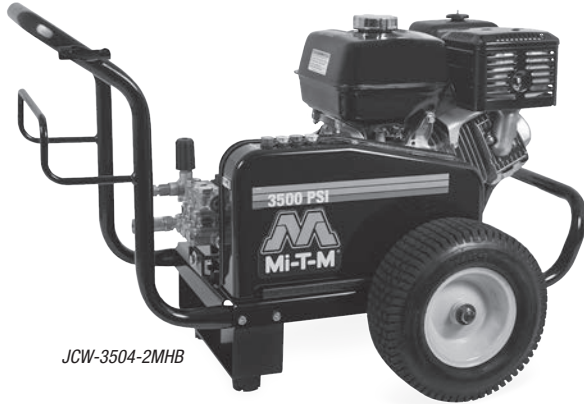

JCW-3504-2MHB

- Belt drive triplex piston AR pump with ceramic plungers
- Stainless-steel and brass unloader with adjustable pressure (3000, 3500 and 4000-PSI models feature Mi-T-M unloader)
- Powder coated steel frame and base plate with 1¼-inch tube handles
- 13-inch flat-free tires (10-inch on 2400, 2700 and 3000-PSI models)
- 1 year limited Mi-T-M unloader warranty (3000, 3500 and 4000-PSI models)
- 3 year limited Honda engine warranty
- 7 year limited AR pump warranty

MODEL NUMBER	PSI	GPM	DISPLACEMENT/ENGINE	PUMP	SHIP WT.	NET WT.	LIST PRICE
JCW-2403-0MHB	2400	2.8	196cc Honda GX200 OHV	AR	171 lb.	121 lb.	\$2,215.00
JCW-2703-0MHB	2700	2.4	196cc Honda GX200 OHV	AR	171 lb.	121 lb.	\$2,330.00
JCW-3003-2MHB	3000	3.0	270cc Honda GX270 OHV	AR	232 lb.	178 lb.	\$2,930.00
JCW-3504-2MHB	3500	3.7	389cc Honda GX390 OHV	AR	245 lb.	191 lb.	\$3,345.00
JCW-4004-2MHB	4000	3.5	389cc Honda GX390 OHV	AR	249 lb.	195 lb.	\$3,395.00

### Accessories & Options:

PART NUMBER	DESCRIPTION	FITS MODELS	LIST PRICE
50-0161	High pressure detergent injector - High pressure water mixes with detergent to clean even the heaviest build-up	All models	\$107.00
851-0338	50-ft. x ¾-in. non-marking hose - For when you need extra hose for added mobility	All models	\$274.00
AW-8400-0021	Low pressure detergent injector - Allows the user to apply the recommended detergents	All models	\$87.00
CX-0005	36-in. insulated dual lance - Has high and low pressure tips that allow you to switch to the low pressure detergent injector without having to change tips	2400 to 3000-PSI models	\$200.00
CX-0082	External bypass system - Allows more water into the system to protect from heat build-up; attaches to pump	3000 to 4000-PSI models	\$274.00
CX-0085	External bypass system - Allows more water into the system to protect from heat build-up; attaches to base plate	3000 to 4000-PSI models	\$598.00

## CW Premium Series Gasoline Belt Drive



CW-4004-5MGH

- Belt drive triplex piston General pump with ceramic plungers
- Stainless-steel and brass unloader with preset pressure (3500 and 4000-PSI models feature Mi-T-M unloader)
- Heavy-duty dual cogged belt drive system
- Powder coated steel frame and base plate with 1¼-inch tube handles
- 13-inch flat-free tires
- 1 year limited Mi-T-M unloader warranty (3500 and 4000-PSI models)
- 3 year limited Honda and Vanguard engine warranties
- 10 year limited General pump warranty

MODEL NUMBER	PSI	GPM	DISPLACEMENT/ENGINE	PUMP	SHIP WT.	NET WT.	LIST PRICE
CW-2505-4MGH	2500	4.4	389cc Honda GX390 OHV	General	290 lb.	216 lb.	\$3,605.00
CW-3004-4MGH	3000	3.5	389cc Honda GX390 OHV	General	290 lb.	216 lb.	\$3,640.00
CW-3504-5MGH	3500	3.8	389cc Honda GX390 OHV	General	290 lb.	216 lb.	\$4,175.00
CW-4004-5MGH	4000	3.5	389cc Honda GX390 OHV	General	290 lb.	216 lb.	\$4,515.00
CW-4004-5MVO	4000	4.0	480cc Vanguard OHV, electric start - battery included	General	330 lb.	256 lb.	\$6,385.00

### Accessories & Options:

PART NUMBER	DESCRIPTION	FITS MODELS	LIST PRICE
50-0161	High pressure detergent injector - High pressure water mixes with detergent to clean even the heaviest build-up	All models	\$107.00
851-0338	50-ft. x ¾-in. non-marking hose - For when you need extra hose for added mobility	All models	\$274.00
AW-8400-0021	Low pressure detergent injector - Allows the user to apply the recommended detergents	All models	\$87.00
CX-0005	36-in. insulated dual lance - Has high and low pressure tips that allow you to switch to the low pressure detergent injector without having to change tips	CW-2505-4MGH & CW-3004-4MGH	\$200.00
CX-0045	Electric start - battery included - For easy starting	All Honda models	\$851.00
CX-0054	Roll cage - Designed for cold water pressure washers to protect equipment, comes with a lifting hook, 1¼-inch powder coated steel tubing	All Honda models	\$483.00
CX-0055	Roll cage - Designed for cold water pressure washers to protect equipment, comes with a lifting hook, 1¼-inch powder coated steel tubing	CW-4004-5MVO	\$472.00

# Cold Water Pressure Washers

## CWC Premium Series Gasoline Belt Drive



Intertek  
 Certified  
 to UL-1776  
 CWC-5004-4MAH  
 CWC-5004-4MGH  
 CWC-5005-4MGH



CWC-7004-4MGH

- Belt drive triplex piston AR or General pump with ceramic plungers
- Stainless-steel and brass unloader
- Industrial frame design includes powder coated steel frame with 1¼-inch roll cage, handles and lifting hook
- 13-inch flat-free tires
- 13-gallon powder coated and aluminized steel fuel tank
- 3 year limited Honda engine warranty
- 7 year limited AR and General pump warranties

MODEL NUMBER	PSI	GPM	DISPLACEMENT/ENGINE	PUMP	SHIP WT.	NET WT.	LIST PRICE
CWC-3008-4MGH	3000	8.0	688cc Honda GX630 OHV	General	531 lb.	408 lb.	\$9,485.00
CWC-5004-4MAH	5000	4.0	688cc Honda GX630 OHV	AR	521 lb.	398 lb.	\$7,925.00
CWC-5004-4MGH	5000	4.0	688cc Honda GX630 OHV	General	521 lb.	398 lb.	\$8,760.00
CWC-5005-4MGH	5000	5.0	688cc Honda GX630 OHV	General	531 lb.	408 lb.	\$8,945.00
CWC-6004-4MGH	6000	3.7	688cc Honda GX630 OHV	General	531 lb.	408 lb.	\$11,190.00
CWC-7004-4MGH	7000	3.8	688cc Honda GX690 OHV	General	521 lb.	398 lb.	\$11,675.00

Note: All models feature electric start - battery included.

### Accessories:

PART NUMBER	DESCRIPTION	FITS MODELS	LIST PRICE
851-0089	50-ft. x ½-in. high pressure hose - For when you need extra hose for added mobility	CWC-3008-4MGH	\$327.00
851-0317	50-ft. x ¾-in. non-marking hose - For when you need extra hose for added mobility	CWC-5004, CWC-5005 & CWC-6004 models	\$346.00
851-0420	50-ft. x ¾-in. high pressure hose - For when you need extra hose for added mobility	CWC-7004-4MGH	\$388.00
AW-0018-0375	Rotating nozzle - Increase your cleaning power and decrease your cleaning time, 0° spray with 25° coverage	CWC-7004-4MGH	\$1,092.00
AW-7500-0035	Rotating nozzle - Increase your cleaning power and decrease your cleaning time, 0° spray with 25° coverage	CWC-5004 & CWC-6004 models	\$309.00

## CW Premium Series Diesel Belt Drive



Intertek  
 Certified  
 to UL-1776



CW-3004-0MKD

- Professional Kohler diesel engine
- Belt drive triplex piston General pump with ceramic plungers
- Stainless-steel and brass unloader with preset pressure
- Powder coated steel frame and base plate with 1¼-inch tube handles
- 13-inch flat-free tires
- 3 year limited Kohler engine warranty
- 10 year limited General pump warranty

MODEL NUMBER	PSI	GPM	HORSEPOWER/ENGINE	PUMP	SHIP WT.	NET WT.	LIST PRICE
CW-3004-0MKD	3000	3.9	9.1 HP Kohler KD440 OHV, electric start - battery included	General	321 lb.	245 lb.	\$6,645.00

### Accessories & Options:

PART NUMBER	DESCRIPTION	FITS MODEL	LIST PRICE
50-0161	High pressure detergent injector - High pressure water mixes with detergent to clean even the heaviest build-up	CW-3004-0MKD	\$107.00
851-0338	50-ft. x ¾-in. non-marking hose - For when you need extra hose for added mobility	CW-3004-0MKD	\$274.00
AW-8400-0021	Low pressure detergent injector - Allows the user to apply the recommended detergents	CW-3004-0MKD	\$87.00
CX-0005	36-in. insulated dual lance - Has high and low pressure tips that allow you to switch to the low pressure detergent injector without having to change tips	CW-3004-0MKD	\$200.00
CX-0054	Roll cage - Designed for cold water pressure washers to protect equipment, comes with a lifting hook, 1¼-inch powder coated steel tubing	CW-3004-0MKD	\$483.00

## CD Series Electric Direct Drive



CD-1502-2MUH

- Totally enclosed fan-cooled electric motor
- Direct drive triplex piston AR or General pump with ceramic plungers
- Stainless-steel and brass unloader with adjustable pressure
- Powder coated steel mounting plate with center balanced lift
- 1 year limited electric motor warranty
- 7 year limited AR and General pump warranties

MODEL NUMBER	PSI	GPM	HORSEPOWER/MOTOR	PUMP	SHIP WT.	NET WT.	LIST PRICE
CD-1002-3MUH	1000	2.0	1.5 HP, 120V, 1Ø, 12.5A	AR	70 lb.	58 lb.	\$1,425.00
CD-1002-2MUH*	1000	2.0	1.5 HP, 120V, 1Ø, 12.5A	General	71 lb.	66 lb.	\$1,990.00
CD-1502-3MUH	1500	2.0	2.0 HP, 120V, 1Ø, 17.0A	AR	76 lb.	70 lb.	\$1,525.00
CD-1502-2MUH*	1500	2.0	2.0 HP, 120V, 1Ø, 17.0A	General	76 lb.	70 lb.	\$2,080.00

\*Pump accepts incoming water up to 175°F.

### Accessories & Options:

PART NUMBER	DESCRIPTION	FITS MODELS	LIST PRICE
18-0370	Rotating nozzle - Increase your cleaning power and decrease your cleaning time	CD-1502 models	\$92.00
18-0371	Rotating nozzle - Increase your cleaning power and decrease your cleaning time	CD-1002 models	\$92.00
50-0161	High pressure detergent injector - High pressure water mixes with detergent to clean even the heaviest build-up	All models	\$107.00
CX-0030	50-ft. x 3/8-in. non-marking hose - For when you need extra hose for added mobility	All models	\$88.00

## JP Series Electric Direct Drive



JP-1002-3ME1

- Totally enclosed fan-cooled electric motor
- Direct drive triplex piston AR or General pump with ceramic plungers
- Stainless-steel and brass unloader with adjustable pressure
- Powder coated steel frame and base plate with 1¼-inch tube handles
- 13-inch flat-free tires (10-inch on 1000, 1500 and 2000-PSI models)
- 1 year limited electric motor warranty
- 7 year limited AR and General pump warranties

MODEL NUMBER	PSI	GPM	HORSEPOWER/MOTOR	PUMP	SHIP WT.	NET WT.	LIST PRICE
JP-1002-3ME1^	1000	2.0	1.5 HP, 120V, 1Ø, 15.0A	AR	120 lb.	90 lb.	\$1,525.00
JP-1002-2ME1*^	1000	2.0	1.5 HP, 120V, 1Ø, 15.0A	General	120 lb.	90 lb.	\$2,155.00
JP-1502-3ME1^	1500	2.0	2.0 HP, 120V, 1Ø, 17.0A	AR	120 lb.	90 lb.	\$1,620.00
JP-1502-2ME1*^	1500	2.0	2.0 HP, 120V, 1Ø, 17.0A	General	120 lb.	90 lb.	\$2,255.00
JP-2003-3ME1^	2000	2.6	4.0 HP, 230V, 1Ø, 16.0A	AR	162 lb.	112 lb.	\$2,380.00
JP-2503-1ME1^	2500	3.2	6.0 HP, 230V, 1Ø, 24.1A	AR	275 lb.	225 lb.	\$3,430.00
JP-2503-0ME3	2500	3.2	6.0 HP, 230V, 3Ø, 15.0A or 6.0 HP, 460V, 3Ø, 7.5A	AR	275 lb.	225 lb.	\$3,725.00
JP-3004-1ME1	3000	3.9	8.0 HP, 230V, 1Ø, 34.5A	AR	275 lb.	225 lb.	\$3,790.00
JP-3004-0ME3	3000	3.9	8.0 HP, 230V, 3Ø, 20.0A or 8.0 HP, 460V, 3Ø, 10.0A	AR	275 lb.	225 lb.	\$3,940.00

^35-foot cord with ground fault circuit interrupter (GFCI).

\*Pump accepts incoming water up to 175°F.

### Accessories & Options:

PART NUMBER	DESCRIPTION	FITS MODELS	LIST PRICE
50-0161	High pressure detergent injector - High pressure water mixes with detergent to clean even the heaviest build-up	All models	\$107.00
CX-0005	36-in. insulated dual lance - Has high and low pressure tips that allow you to switch to the low pressure detergent injector without having to change tips	All models	\$200.00
CX-0030	50-ft. x 3/8-in. non-marking hose - For when you need extra hose for added mobility	1000 to 2000-PSI models	\$88.00
CX-0066	460V on 6.0-HP, 3-phase model - For when you have 460V of power available	JP-2503-0ME3	\$26.00
CX-0067	460V on 8.0-HP, 3-phase model - For when you have 460V of power available	JP-3004-0ME3	\$52.00

## CW Premium Series Electric Belt Drive



CW-3004-4ME3

- Totally enclosed fan-cooled electric motor
- Belt drive triplex piston General pump with ceramic plungers
- Stainless-steel and brass unloader with preset pressure (CW-4004-1ME3 features a Mi-T-M unloader)
- Powder coated steel frame and base plate with tube handles
- 13-inch flat-free tires
- 1 year limited Mi-T-M unloader warranty (CW-4004-1ME3)
- 1 year limited electric motor warranty
- 7 year limited General pump warranty (CW-4004-1ME3 and CW-5004-0ME3)
- 10 year limited General pump warranty (CW-2405, CW-3004 and CW-3005 models)

MODEL NUMBER	PSI	GPM	HORSEPOWER/MOTOR	PUMP	SHIP WT.	NET WT.	LIST PRICE
CW-2405-4ME1	2400	4.6	7.5 HP, 230V, 1Ø, 32.0A	General	345 lb.	333 lb.	\$4,785.00
CW-2405-4ME3*	2400	4.6	8.0 HP, 230V, 3Ø, 20.0A or 8.0 HP, 460V, 3Ø, 10.0A	General	355 lb.	343 lb.	\$4,250.00
CW-3004-4ME1	3000	3.5	7.5 HP, 230V, 1Ø, 32.0A	General	350 lb.	338 lb.	\$4,785.00
CW-3004-4ME3*	3000	3.5	8.0 HP, 230V, 3Ø, 20.0A or 8.0 HP, 460V, 3Ø, 10.0A	General	403 lb.	301 lb.	\$4,295.00
CW-3005-0ME1	3000	4.8	10.0 HP, 230V, 1Ø, 41.5A	General	470 lb.	396 lb.	\$5,315.00
CW-3005-0ME3*	3000	4.8	10.0 HP, 230V, 3Ø, 26.0A or 10.0 HP, 460V, 3Ø, 13.0A	General	450 lb.	376 lb.	\$5,745.00
CW-4004-1ME3*	4000	3.9	15.0 HP, 230V, 3Ø, 40.0A or 15.0 HP, 460V, 3Ø, 20.0A	General	505 lb.	431 lb.	\$7,315.00
CW-5004-0ME3*	5000	4.0	15.0 HP, 230V, 3Ø, 40.0A or 15.0 HP, 460V, 3Ø, 20.0A	General	505 lb.	431 lb.	\$7,635.00

\*460V motors available as options.

### Accessories & Options:

PART NUMBER	DESCRIPTION	FITS MODELS	LIST PRICE
50-0161	High pressure detergent injector - High pressure water mixes with detergent to clean even the heaviest build-up	All models	\$107.00
851-0317	50-ft. x 3/8-in. non-marking hose - For when you need extra hose for added mobility	CW-5004-0ME3	\$346.00
851-0338	50-ft. x 3/8-in. non-marking hose - For when you need extra hose for added mobility	2400 to 4000-PSI models	\$274.00
AW-8400-0021	Low pressure detergent injector - Allows the user to apply the recommended detergents	All models	\$87.00
CX-0003	460V on 8.0-HP, 3-phase models - For when you have 460V of power available	CW-2405-4ME3 & CW-3004-4ME3	No charge
CX-0005	36-in. insulated dual lance - Has high and low pressure tips that allow you to switch to the low pressure detergent injector without having to change tips	CW-2405, CW-3004 & CW-3005 models	\$200.00
CX-0057	460V on 15.0-HP, 3-phase models - For when you have 460V of power available	CW-4004-1ME3 & CW-5004-0ME3	No charge
CX-0062	460V on 10.0-HP, 3-phase model - For when you have 460V of power available	CW-3005-0ME3	\$62.00
CX-0093	Stationary option - This option will remove the existing tall handle and wheels, which will be replaced with a short handle and rubber feet for stationary applications	CW-2405 & CW-3004 models	No charge
CX-0094	Stationary option - This option will remove the existing tall handle and wheels, which will be replaced with a short handle and rubber feet for stationary applications	CW-3005, CW-4004 & CW-5004 models	No charge



# Cold & Hot Water Pressure Washers

## CW Premium Series Electric Belt Drive Stationary



CW-2004-SME1

- Open drip-proof motor (1000 and 3000-PSI models)
- Totally enclosed fan-cooled electric motor (2000-PSI models)
- Belt drive triplex piston General pump with ceramic plungers
- Pump accepts incoming water up to 175°F
- Stainless-steel and brass unloader with preset pressure
- Stainless-steel base and frame with removable panels
- 1 year limited electric motor warranty
- 10 year limited General pump warranty

MODEL NUMBER	PSI	GPM	HORSEPOWER/MOTOR	PUMP	SHIP WT.	NET WT.	LIST PRICE
CW-1003-SME1	1000	2.5	2.0 HP, 120V, 1Ø, 18.8A	General	222 lb.	172 lb.	\$4,075.00
CW-2004-SME1	2000	3.9	6.0 HP, 230V, 1Ø, 22.0A	General	272 lb.	214 lb.	\$5,015.00
CW-2004-SME3*	2000	3.9	6.0 HP, 230V, 3Ø, 15.0A	General	262 lb.	204 lb.	\$5,120.00
CW-3004-SME3*	3000	3.5	8.0 HP, 230V, 3Ø, 20.0A	General	292 lb.	234 lb.	\$4,915.00

\*460V motors available as options.

### Accessories & Options:

PART NUMBER	DESCRIPTION	FITS MODELS	LIST PRICE
AW-9501-0000	Stainless-steel wall mounting bracket - Provides a permanent location for your pressure washer in a shop or plant facility	All models	\$937.00
AW-9502-0000	Powder coated steel wall mounting bracket - Provides a permanent location for your pressure washer in a shop or plant facility	All models	\$351.00
AW-9502-0001	Powder coated steel floor stand - Provides a permanent location for your pressure washer in a shop or plant facility	All models	\$641.00
CX-0069	Auto start/stop - When trigger gun is released, the timer will turn unit off; when trigger gun is pulled, unit will restart	All models	\$129.00
CX-0076	460V on 6.0-HP, 3-phase model - For when you have 460V of power available	CW-2004-SME3	\$26.00
CX-0077	460V on 8.0-HP, 3-phase model - For when you have 460V of power available	CW-3004-SME3	\$26.00
CX-0078	Remote box - Adds control box which may be mounted away from unit to control on/off	All models	\$212.00
CX-0096	Hour meter - Displays the number of hours unit has been in operation	All models	\$104.00

## HSP Series Gasoline Direct Drive



HSP-2503-0MMH

- Direct drive triplex piston AR or Mi-T-M pump with ceramic plungers
- Stainless-steel and brass unloader
- Reinforced powder coated steel tube frame with center balanced lift
- Patented Electro Magnetic Firing (EMF) system
- 13-inch flat-free tires
- 3 year limited coil warranty
- 3 year limited Honda and Kohler engine warranties
- 7 year limited AR and Mi-T-M pump warranties

MODEL NUMBER	PSI	GPM	DISPLACEMENT/ENGINE	PUMP	SHIP WT.	NET WT.	LIST PRICE
HSP-2503-0MMH	2500	2.6	196cc Honda GX200 OHV	Mi-T-M	411 lb.	295 lb.	\$5,190.00
HSP-3003-3MGH	3000	2.9	270cc Honda GX270 OHV	AR	530 lb.	407 lb.	\$6,225.00
HSP-3504-3MGH	3500	3.3	389cc Honda GX390 OHV	AR	551 lb.	428 lb.	\$6,830.00
HSP-3504-3MGK	3500	3.3	429cc Kohler CH440 OHV	AR	551 lb.	428 lb.	\$6,315.00

### Accessories & Options:

PART NUMBER	DESCRIPTION	FITS MODELS	LIST PRICE
20-0464A52	Rain cap - Protects boiler from moisture build-up when unit is left outside	3000 to 3500-PSI models	\$129.00
50-0161	High pressure detergent injector - High pressure water mixes with detergent to clean even the heaviest build-up	All models	\$107.00
850-0433	50-ft. x 3/8-in. high pressure hose - For when you need extra hose for added mobility	3500-PSI models	\$284.00
851-0262	50-ft. x 3/8-in. high pressure hose - For when you need extra hose for added mobility	2500 to 3000-PSI models	\$218.00
HX-0098	Electric start - battery included - For easy starting	HSP-3504-3MGH	\$897.00
HX-0233	Adjustable thermostat - Operator is able to adjust outlet water temperature between 98°-248°F	HSP-2503-0MMH	\$135.00
HX-0234	Low pressure detergent injector - Allows the user to apply the recommended detergents	HSP-2503-0MMH	\$124.00
HX-0236	Hour meter - Displays the number of hours unit has been in operation	HSP-2503-0MMH	\$104.00
HX-0250	Adjustable thermostat - Operator is able to adjust outlet water temperature between 98°-248°F	3000 to 3500-PSI models	\$69.00

## HS Series

### Gasoline/Diesel Belt Drive



HS-4005-OMDK

- Industrial gasoline or diesel engine with electric start - battery included
- Belt drive triplex piston AR or General pump with ceramic plungers
- Factory preset unloader
- Heavy-duty powder coated 1½-inch steel square tube frame
- 2900-watt generator delivers clean power to the burner
- 3 year limited coil warranty
- 3 year limited Honda, Kubota and Vanguard engine warranties
- 7 year limited AR and General pump warranties

GASOLINE MODELS							
MODEL NUMBER	PSI	GPM	DISPLACEMENT/ENGINE	PUMP	SHIP WT.	NET WT.	LIST PRICE
HS-3005-0MGV	3000	4.8	480cc Vanguard OHV	General	816 lb.	710 lb.	\$9,905.00
HS-3505-1MGH	3500	4.7	688cc Honda GX630 OHV	General	854 lb.	750 lb.	\$10,775.00
HS-3506-1MGH	3500	5.6	688cc Honda GX630 OHV	General	864 lb.	760 lb.	\$11,175.00
HS-4004-1MAH*	4000	4.0	688cc Honda GX630 OHV	AR	854 lb.	750 lb.	\$11,180.00

DIESEL MODELS							
MODEL NUMBER	PSI	GPM	HORSEPOWER/ENGINE	PUMP	SHIP WT.	NET WT.	LIST PRICE
HS-3006-0MDK	3000	5.6	16.8 HP Kubota Z602 OHV	General	940 lb.	836 lb.	\$20,330.00
HS-3505-0MDK	3500	4.7	16.8 HP Kubota Z602 OHV	General	940 lb.	836 lb.	\$20,330.00
HS-4005-0MDK*	4000	4.5	16.8 HP Kubota Z602 OHV	General	940 lb.	836 lb.	\$21,215.00

\*Model equipped with trapping unloader, all other models equipped with K7 flow actuated unloader.

### Accessories & Options:

PART NUMBER	DESCRIPTION	FITS MODELS	LIST PRICE
20-1070A18	Removable painted front panel - Provides a protective panel and gives unit a more finished look	All models	\$105.00
20-1366A52	Black powder coated painted rain cap - Protects boiler from moisture build-up when unit is left outside, octagonal	All models	\$91.00
50-0177	Stack adapter - Allows 8-inch flue pipe to be installed to boiler exhaust port	All models	\$144.00
850-0324	Gasket (for 50-0177) - Seals between 50-0177 stack adapter and boiler housing	All models	\$27.00
AW-5740-0000	Wheel kit - Allows unit to become portable	All models	\$1,025.00
AW-6000-1006	Hot water skid equipment cover - Keeps your equipment clean, dry and looking like new, made from 600-denier vinyl-backed polyester, water resistant, drawstrings to secure cover	All models	\$254.00
AW-8400-0021	Low pressure detergent injector - Allows the user to apply the recommended detergents	All models, except HS-3506 & HS-3006	\$87.00
HX-0130	Three-way ball valve - Allows the pressure washer to be operated from garden hose, float tank or trailer supply tank by adjusting ball valve lever	All models	\$294.00
HX-0131	High pressure detergent injector (K7) - Supplies soap injection through the high pressure pump while spraying; pressure washers with K7 flow actuated unloaders only	3000 to 3500-PSI models	\$104.00
HX-0133	Steam combination 250°F (K7) - Increases outlet temperature to 250°F. Steam option for models equipped with K7 flow actuated unloaders	HS-3005 & HS-3505 models	\$212.00
HX-0135	Steam combination 250°F (K7) - See HX-0133 for description	HS-3506-1MGH	\$212.00
HX-0136	Steam combination 250°F (K7) - See HX-0133 for description	HS-3006-0MDK	\$212.00
HX-0138*	Steam combination 250°F - Increases outlet temperature to 250°F	HS-3005-0MGV	\$37.00
HX-0139*	Steam combination 250°F - See HX-0138 for description	HS-3505 models	\$37.00
HX-0140*	Steam combination 250°F - See HX-0138 for description	HS-3506-1MGH	\$37.00
HX-0141*	Steam combination 250°F - See HX-0138 for description	HS-3006-0MDK	\$37.00
HX-0142	Steam combination 250°F - See HX-0138 for description	4000-PSI models	\$37.00
HX-0143	Trapping unloader - For hose runs longer than 50-ft. and for cleaning elevated areas	HS-3006 & HS-3506 models	\$68.00
HX-0144*	Dual gun - Two guns may be sprayed at the same time; flow is divided between the two guns while each operator maintains equal system pressure	HS-3006 & HS-3506 models	\$475.00
HX-0145	Adjustable thermostat - Operator is able to adjust outlet water temperature between 86°-248°F	All models	\$68.00
HX-0146	Hour meter - Displays the number of hours unit has been in operation	All models	\$114.00
HX-0147	Four point lifting capability - Allows unit to be lifted by crane	All models	\$100.00
HX-0148*	Adjustable detergent valve - Adds the adjustable detergent valve to the control panel for the high pressure soap	All models	\$104.00
HX-0200	Trapping unloader - For hose runs longer than 50-ft. and for cleaning elevated areas	HS-3005 & HS-3505 models	\$83.00

\*Requires trapping unloader.

Note: To order options HX-0138 to HX-0141, HX-0144 or HX-0148 you must order option HX-0143 or HX-0200 (not required for 4000-PSI models, which already come equipped with trapping unloader).

These customizable mobile pressure washer trailers are rugged and convenient and the perfect solution for on-site cleaning. Pair them with an industrial pressure washer to clean dirt and grime anywhere, anytime.

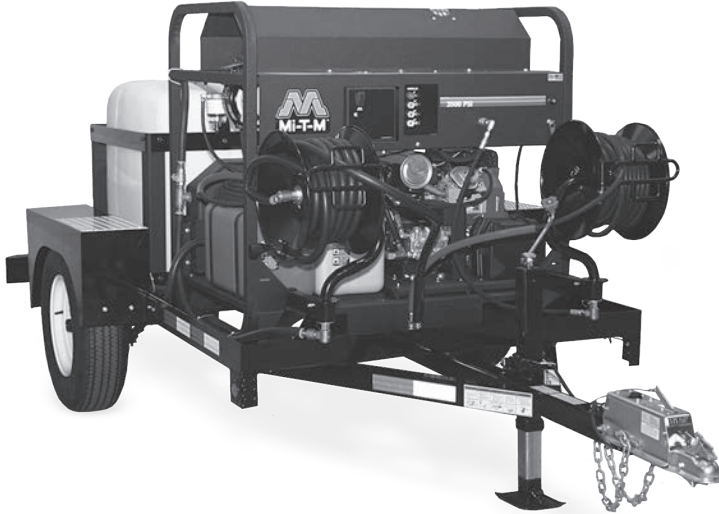

AW-9000-0005 shown with HS-3505-1MGH hot water pressure washer, hose reels and industrial water supply hose, 15-0006 (available as accessories)

#### All Trailers Feature

- 5-foot x 8½-foot trailer
- 3-inch x 4¼-inch angle frame
- 2-inch ball hitch
- Swivel jack with pad
- Tanks are enclosed in a powder coated steel frame

#### Single-Axle Trailers Also Feature

- (1) 3,500 lb. axle
- (2) ST205-75R 15-inch radial tires

#### Dual-Axle Trailers Also Feature

- (2) 3,500 lb. axles with brakes on both sides
- (4) ST205-75R 15-inch radial tires

#### Trailer Accessories & Options:

##### High Pressure Hose Reels

- High pressure hose reels include a jumper hose and mounting bracket

##### Low Pressure Hose Reel

- Low pressure hose reel includes a mounting bracket and plumbing

##### Backflow Preventers

- Backflow preventers are required on trailer units in California

##### Trailer Tank Bypass

- The trailer tank bypass removes the float system, while adding the necessary plumbing, the water bypasses back to the water tank

##### Deluxe Trailer Option

- Adds a ball valve, trailer tank bypass and low pressure hose reel to the trailer

##### Trailer Hitches

- Replace the standard 2-inch ball hitch with an adjustable trailer coupler hitch or lunette ring hitch. Includes hitch with brackets and hardware.

SINGLE-AXLE TRAILERS		
PART NUMBER	DESCRIPTION	LIST PRICE
AW-9000-0005	With 200-gallon water tank and surge brakes	\$8,595.00
AW-9000-0006	With 200-gallon water tank and electric brakes	\$8,681.00
AW-9000-0007	With 200-gallon water tank only	\$7,785.00

DUAL-AXLE TRAILERS		
PART NUMBER	DESCRIPTION	LIST PRICE
AW-9000-0003	With (2) 200-gallon water tanks and surge brakes	\$13,805.00
AW-9000-0004	With (2) 200-gallon water tanks and electric brakes	\$14,410.00
AW-9000-0008	With (1) 200-gallon water tank and surge brakes	\$10,743.00

TRAILER ACCESSORIES & OPTIONS:		
PART NUMBER	DESCRIPTION	LIST PRICE
TX-0001	High pressure hose reel - 13-inch, for use with all trailers	\$916.00
TX-0002	High pressure hose reel - 16-inch, for use with all trailers	\$980.00
TX-0003	Low pressure hose reel - 16-inch, for use with AW-9000-0003 and AW-9000-0004 trailers	\$1,057.00
TX-0013	Low pressure hose reel - 16-inch, for use with AW-9000-0005, AW-9000-0006, AW-9000-0007 and AW-9000-0008 trailers	\$1,068.00
15-0159	Jumper hose	\$36.00
13-0179A01	Mounting bracket	\$85.00
50-0195	Hose reel - 13-inch, 150-foot maximum hose length, rated for units up to 4000-PSI	\$946.00
50-0196	Hose reel - 16-inch, 200-foot maximum hose length, rated for units up to 4000-PSI	\$958.00
TX-0005	Trailer tank bypass - For use on AW-9000-0003 and AW-9000-0004 trailers with HS Series pressure washers	No charge
TX-0007	Trailer tank bypass - For use on AW-9000-0005, AW-9000-0007 and AW-9000-0008 trailers with HS Series pressure washers	No charge
TX-0009	Adjustable trailer coupler hitch, 2-inch - Used on AW-9000-0006 & AW-9000-0007 trailers	\$403.00
TX-0010	Adjustable trailer coupler hitch, 2-inch - Used on AW-9000-0003, AW-9000-0004 and AW-9000-0008 trailers	\$341.00
TX-0011	Backflow preventer - Adds the backflow preventor to AW-9000-0005, AW-9000-0006, AW-9000-0007 & AW-9000-0008 trailers that have the TX-0013 low pressure hose reel option; mounts to hose reel or inlet plumbing on trailer	\$269.00
TX-0012	Backflow preventer - Adds the backflow preventor to AW-9000-0005, AW-9000-0006, AW-9000-0007 and AW-9000-0008 trailers that do not have the TX-0013 low pressure hose reel option; mounts to inlet plumbing on trailer	\$308.00
TX-0015	Deluxe trailer option - For use on AW-9000-0003 & AW-9000-0004 trailers with HS Series pressure washers	\$1,122.00
TX-0017	Deluxe trailer option - For use on AW-9000-0005, AW-9000-0006, AW-9000-0007 & AW-9000-0008 trailers with HS Series pressure washers	\$1,050.00
TX-0018	Lunette ring hitch, 3-inch - Used on AW-9000-0006 & AW-9000-0007 trailers	\$260.00
TX-0019	Lunette ring hitch, 3-inch - Used on AW-9000-0003, AW-9000-0004 and AW-9000-0008 trailers	\$210.00

As a company we continually strive to seek advancements in technology, therefore the design of Mi-T-M trailers may change after the publication of this catalog.

## HSE Series

### Electric Direct/Belt Drive



HSE-2003-0MG10



HSE-2504-0M30

- Totally enclosed fan-cooled electric motor
- Direct or belt drive triplex piston General or Mi-T-M pump with ceramic plungers
- Stainless-steel and brass unloader
- Energy-efficient top-fired heat exchanger designed for convenient troubleshooting and easy maintenance
- 13-inch flat-free tires
- 1 year limited electric motor warranty
- 3 year limited coil warranty
- 7 year limited General and Mi-T-M pump warranties

BELT DRIVE MODELS							
MODEL NUMBER	PSI	GPM	HORSEPOWER/MOTOR	PUMP	SHIP WT.	NET WT.	LIST PRICE
HSE-1002-0MG10	1000	2.0	1.5 HP, 120V, 1Ø, 15.0A	General	418 lb.	295 lb.	\$4,750.00
HSE-1002-0MM11*	1000	2.0	1.5 HP, 120V, 1Ø, 15.0A	Mi-T-M	410 lb.	237 lb.	\$4,340.00
HSE-1502-0MG10	1500	2.0	2.0 HP, 120V, 1Ø, 19.0A	General	422 lb.	299 lb.	\$5,035.00
HSE-1502-0MM11*	1500	2.0	2.0 HP, 120V, 1Ø, 19.0A	Mi-T-M	414 lb.	291 lb.	\$4,460.00
HSE-2003-0MG10	2000	2.8	4.0 HP, 230V, 1Ø, 18.0A	General	439 lb.	316 lb.	\$5,465.00
HSE-2003-0MM11*	2000	2.8	4.0 HP, 230V, 1Ø, 18.0A	Mi-T-M	431 lb.	308 lb.	\$4,800.00

\*Model does not include float tank and high pressure detergent injector.

#### Accessories & Options:

PART NUMBER	DESCRIPTION	FITS MODELS	LIST PRICE
50-0161	High pressure detergent injector - High pressure water mixes with detergent to clean even the heaviest build-up	All models	\$107.00
850-0433	50-ft. x 3/8-in. high pressure hose - For when you need extra hose for added mobility	All models	\$284.00
HX-0232	300°F steam - Reduces pressure to 350-PSI by adjusting unloader valve counter-clockwise, spray temperatures will rise 240°F above ambient with a maximum of 300°F	HSE-1002-0MG10	\$568.00
HX-0233	Adjustable thermostat - Operator is able to adjust outlet water temperature between 86°-248°F	All models	\$135.00
HX-0235	Hour meter - Displays the number of hours unit has been in operation	All models	\$104.00
HX-0237	Auto start/stop - When trigger gun is released, the timer will turn unit off; when trigger gun is pulled, unit will restart	1000 to 1500-PSI models	\$758.00
HX-0238	Time delay shutdown - Timer will shut unit off automatically when trigger gun is released and timer reaches setting	1000 to 1500-PSI models	\$753.00
HX-0239	300°F steam - See HX-0232 for description	HSE-1002-0MM11	\$690.00
HX-0240	300°F steam - See HX-0232 for description	HSE-2003-0MG10	\$568.00
HX-0241	300°F steam - See HX-0232 for description	HSE-2003-0MM11	\$690.00
HX-0243	Auto start/stop - See HX-0237 for description	2000-PSI models	\$780.00
HX-0244	Time delay shutdown - See HX-0238 for description	2000-PSI models	\$750.00
HX-0245	300°F steam - See HX-0232 for description	HSE-1502-0MM11	\$660.00
HX-0246	300°F steam - See HX-0232 for description	HSE-1502-0MG10	\$568.00

BELT DRIVE MODELS							
MODEL NUMBER	PSI	GPM	HORSEPOWER/MOTOR	PUMP	SHIP WT.	NET WT.	LIST PRICE
HSE-2504-0M10	2500	3.2	6.0 HP, 230V, 1Ø, 25.0A	General	699 lb.	569 lb.	\$7,865.00
HSE-2504-0M30	2500	3.2	6.0 HP, 230-460V, 3Ø, 16.0A	General	688 lb.	558 lb.	\$7,845.00
HSE-3004-0M10	3000	3.5	8.0 HP, 230V, 1Ø, 36.0A	General	737 lb.	607 lb.	\$8,165.00
HSE-3004-0M30	3000	3.5	8.0 HP, 230-460V, 3Ø, 24.0A	General	732 lb.	602 lb.	\$8,190.00
HSE-3504-0M10	3500	3.3	10.0 HP, 230V, 1Ø, 39.0A	General	761 lb.	631 lb.	\$8,610.00
HSE-3504-0M30	3500	3.3	10.0 HP, 230-460V, 3Ø, 28.0A	General	742 lb.	612 lb.	\$8,570.00

#### Accessories & Options:

PART NUMBER	DESCRIPTION	FITS MODELS	LIST PRICE
850-0433	50-ft. x 3/8-in. high pressure hose - For when you need extra hose for added mobility	All models	\$284.00
HX-0070	Auto start/stop - When trigger gun is released, the timer will turn unit off; when trigger gun is pulled, unit will restart	All models	\$294.00
HX-0071	Auto start/stop - steam - When trigger gun is released, the timer will turn unit off; when trigger gun is pulled, unit will restart; Reduces pressure to 350-PSI by adjusting unloader valve counter-clockwise, spray temperatures will rise 240°F above ambient with a maximum of 300°F	2500-PSI models	\$1,320.00
HX-0072	Auto start/stop - steam - See HX-0071 for description	3000-PSI models	\$1,320.00
HX-0073	Auto start/stop - steam - See HX-0071 for description	3500-PSI models	\$1,320.00
HX-0074	Auto start/stop - CAD cell - When trigger gun is released, the timer will turn unit off; when trigger gun is pulled, unit will restart; Monitors burner for proper ignition	All models	\$763.00
HX-0075	Auto start/stop - steam - CAD cell - When trigger gun is released, the timer will turn unit off; when trigger gun is pulled, unit will restart; Reduces pressure to 350-PSI by adjusting unloader valve counter-clockwise, spray temperatures will rise 240°F above ambient with a maximum of 300°F; Monitors burner for proper ignition	2500-PSI models	\$1,727.00
HX-0076	Auto start/stop - steam - CAD cell - See HX-0075 for description	3000-PSI models	\$1,727.00
HX-0077	Auto start/stop - steam - CAD cell - See HX-0075 for description	3500-PSI models	\$1,743.00
HX-0085	460V on 6.0-HP, 3-phase model - Upgrades 230V, 3-phase models to operate at 460V, 3-phase	HSE-2504-0M30	\$355.00
HX-0086	460V on 8.0-HP, 3-phase model - See HX-0085 for description	HSE-3004-0M30	\$289.00
HX-0087	460V on 10.0-HP, 3-phase model - See HX-0085 for description	HSE-3504-0M30	\$447.00
HX-0088	Skid feet - Stationary applications	All models	\$83.00
HX-0161	Hour meter - Displays the number of hours unit has been in operation	All models	\$98.00

# Hot Water Pressure Washers

## HAE Series All-Electric Belt Drive



Patent Pending



HAE-3004-0E4G

MODEL NUMBER	PSI	GPM	HORSEPOWER/ MOTOR	UNIT AMPERAGE	PUMP	SHIP WT.	NET WT.	LIST PRICE
HAE-2503-0E4G	2500	2.8	6.0 HP, 460V, 3Ø	66.0A	General	725 lb.	625 lb.	\$12,265.00
HAE-3004-0E4G	3000	3.9	8.0 HP, 460V, 3Ø	98.0A	General	830 lb.	725 lb.	\$15,370.00

### Options:

PART NUMBER	DESCRIPTION	FITS MODELS	LIST PRICE
CX-0069	Auto start/stop - When trigger gun is released, the timer will turn unit off; when trigger gun is pulled, unit will restart	All models	\$129.00
CX-0078	Remote box - Adds control box which may be mounted away from unit to control on/off	All models	\$212.00

- Totally enclosed fan-cooled electric motor (3000-PSI model)
- Open drip-proof motor (2500-PSI model)
- Belt drive triplex piston General pump with ceramic plungers
- Stainless-steel and brass unloader with preset pressure
- Stainless-steel base and frame with rubber isolators
- Time delay shutdown
- 1 year limited electric motor warranty
- 10 year limited General pump warranty

### Heat Exchanger:

- Heat exchanger with stainless-steel coils in aluminum casings
- Used for consistent and efficient on-demand hot water
- Revolutionary cartridge design
- Eliminates constant cleaning
- Eliminates heat loss
- 120°F to 130°F temperature rise above in-take water, obtained within 3 to 5 minutes
- Adjustable thermostat
- On/Off power switch
- Powder coated steel frame

## HG Series Natural Gas/LP Belt Drive



HG-3004-3460

- Open drip-proof motor
- Belt drive triplex piston General pump with ceramic plungers
- Factory preset trapping unloader
- Powder coated steel side panels and frame
- 21-inch draft diverter, 10-inch opening
- 1 year limited electric motor warranty
- 3 year limited coil warranty
- 7 year limited General pump warranty

MODEL NUMBER	PSI	GPM	HORSEPOWER/MOTOR	PUMP	SHIP WT.	NET WT.	LIST PRICE
HG-3004-1208	3000	3.9	8.0 HP, 208V, 1Ø, 40.5A	General	878 lb.	758 lb.	\$9,820.00
HG-3004-3208	3000	3.9	8.0 HP, 208V, 3Ø, 23.0A	General	878 lb.	758 lb.	\$9,430.00
HG-3004-1230	3000	3.9	8.0 HP, 230V, 1Ø, 37.0A	General	878 lb.	758 lb.	\$9,820.00
HG-3004-3230	3000	3.9	8.0 HP, 230V, 3Ø, 20.0A	General	878 lb.	758 lb.	\$9,430.00
HG-3004-3460	3000	3.9	8.0 HP, 460V, 3Ø, 10.0A	General	878 lb.	758 lb.	\$9,430.00

### Options:

PART NUMBER	DESCRIPTION	FITS MODELS	LIST PRICE
HX-0104	<b>K7 unloader, flow activated (auto start/stop N/A)</b> - Converts pressure trapping unloader system to flow actuated K7 unloader	All models	\$423.00
HX-0105	<b>Liquid propane (vapor only)</b> - Converts natural gas pressure washer to operate on liquid propane (vapor only)	All models	\$104.00
HX-0106	<b>Hour meter</b> - Displays the number of hours unit has been in operation	All models	\$109.00
HX-0107	<b>Time delay shutdown</b> - Timer will shut unit off automatically when trigger gun is released and timer reaches setting	All models	\$573.00
HX-0108	<b>(1) Remote station (auto start/stop N/A)</b> - Adds control box which may be mounted away from unit to control on/off, burner and soap injection	All models	\$1,403.00
HX-0109	<b>Time delay shutdown and first remote box</b> - Timer will shut unit off automatically when trigger gun is released and timer reaches setting; adds control box which may be mounted away from unit to control on/off, burner and soap injection	All models	\$1,815.00
HX-0110	<b>Additional remotes (up to 3)</b> - Additional remotes that may be added to unit after the first remote is installed	All models	\$464.00
HX-0111	<b>Auto start/stop</b> - When trigger gun is released, the timer will turn unit off; when trigger gun is pulled, unit will restart	All models	\$531.00
HX-0121	<b>250°F steam upgrade</b> - Steam option increases outlet temperature to 250°F; adds steam nozzle	All models	\$212.00
HX-0124	<b>Auto start/stop and first remote option</b> - When trigger gun is released, the timer will turn unit off; when trigger gun is pulled, unit will restart; adds control box which may be mounted away from unit to control on/off, burner and soap injection	All models	\$1,789.00

Note: You cannot order HX-0107 and HX-0108 together, you will need to order HX-0109 instead.  
HX-0107 and HX-0108 can be ordered separately.

## Detergent Injectors



AW-8400-0021



50-0161

### Low Pressure Detergent Injectors

- Solid brass body with stainless-steel orifice
- Quick connects for easy installation

### High Pressure Detergent Injectors

- Brass and stainless-steel construction
- Steel mesh in-line water strainer
- 2.0 to 6.0-GPM operating capacity

PART NUMBER	DESCRIPTION	LIST PRICE
AW-8400-0021	Low pressure injector - 4500-PSI	\$87.00
AW-8000-0001	Low pressure injector - 3500-PSI	\$608.00
851-0022	Detergent injector shut-off valve	\$97.00
AW-8007-0000	High pressure injector- Diaphragm-style	\$402.00
50-0161	High pressure injector	\$107.00

## Sand Injector



AW-3000-0000

### Sand Injector

- Includes sand probe and clear hose
- 5500-PSI rated

Note: Consult factory for nozzle orifice size prior to ordering

PART NUMBER	DESCRIPTION	LIST PRICE
AW-3000-0000	Wet sand injector - Carbide tip	\$421.00
18-0113	Carbide replacement nozzle	\$175.00

## Detergents



### All Purpose Cleaner

- Environmentally friendly, will not harm plants, biodegradable
- Cleans vehicles, lawn equipment and windows

### Deck & House Wash

- Environmentally friendly, will not harm plants, biodegradable
- Cleans decks, homes and wooden surfaces

### Heavy-Duty Degreaser

- Contains rust inhibitors to reduce corrosion
- Cleans grease, oil, diesel and petroleum

PART NUMBER	DESCRIPTION	LIST PRICE
AW-4018-0026	All purpose cleaner - 1-gallon, 4 per case	\$20.00
AW-4018-0026-C*	All purpose cleaner - 1-gallon, 4 per case	\$30.00
AW-4018-0005	All purpose cleaner - 5-gallon	\$83.00
AW-4018-0005-C*	All purpose cleaner - 5-gallon	\$93.00
AW-4018-0055	All purpose cleaner - 55-gallon	\$776.00
AW-4018-0055-C*	All purpose cleaner - 55-gallon	\$786.00
AW-4034-0026	Deck & house wash - 1-gallon, 4 per case	\$20.00
AW-4034-0026-C*	Deck & house wash - 1-gallon, 4 per case	\$30.00
AW-4034-0005	Deck & house wash - 5-gallon	\$83.00
AW-4034-0005-C*	Deck & house wash - 5-gallon	\$93.00
AW-4034-0055	Deck & house wash - 55-gallon	\$776.00
AW-4034-0055-C*	Deck & house wash - 55-gallon	\$786.00
AW-4059-0026	Heavy-duty degreaser - 1-gallon, 4 per case	\$20.00
AW-4059-0026-C*	Heavy-duty degreaser - 1-gallon, 4 per case	\$30.00
AW-4059-0005	Heavy-duty degreaser - 5-gallon	\$83.00
AW-4059-0005-C*	Heavy-duty degreaser - 5-gallon	\$93.00
AW-4059-0055	Heavy-duty degreaser - 55-gallon	\$776.00
AW-4059-0055-C*	Heavy-duty degreaser - 55-gallon	\$786.00

\*Available in Canada only.

## Pump Oil & Pump Saver



AW-4085-0016



AW-4070-0004

### Pump Oil

- Specially design for pressure washer pumps
- Contains rust and corrosion additives, anti-wear additives, foam suppressant and dispersant for system cleanliness

### Pump Saver

- For use with all pressure washers
- Protects pressure washer when not in use

PART NUMBER	DESCRIPTION	LIST PRICE
AW-4085-0016	Pump oil - 1-pint bottles, 6 or 12 per case	\$11.00
AW-4070-0004	Pump saver - 16-oz. bottle	\$24.00

## Long Range Chemical Nozzle



- Has a range of 30-feet while drawing chemical

PART NUMBER	DESCRIPTION	LIST PRICE
18-0373	Long range chemical nozzle	\$8.00

# Nozzles & Extension Wands

## Rotating Nozzles



AW-7510-0035

- 0° spray pattern with a 25° coverage
- Quick connect and filter included
- Note: Consult factory for correct orifice size and repair kits

PART NUMBER	DESCRIPTION	LIST PRICE
AW-0018-0375	7300-PSI maximum rating, fits CWC-6004 & CWC-7004	\$1,092.00
AW-7004-Series	6000-PSI maximum rating	\$378.00
AW-7500-Series	6000-PSI maximum rating	\$309.00
AW-7510-0035	5100-PSI maximum rating, 3.5 orifice size	\$230.00
AW-7510-0004	5100-PSI maximum rating, 4.0 orifice size	\$230.00

## Multi-Function Nozzles



AW-7200-0035

- Six nozzles in one: 0°, 15°, 25° and 40° plus soap and rinse
- Stainless-steel nozzles

PART NUMBER	DESCRIPTION	LIST PRICE
AW-7200-0035	4200-PSI maximum rating, 3.5 orifice size	\$48.00
AW-7200-0004	4200-PSI maximum rating, 4.0 orifice size	\$48.00

## Extended Reach Wands

### Fiberglass & Aluminum Wands

- Professional-grade trigger gun with safety lock-off
- Complete with quick connects
- Compatible with all makes of pressure washers up to 4000-PSI

### Fiberglass Wands

- Available in 12, 18 or 24-foot lengths

### Aluminum Wands

- Available in 18 or 24-foot lengths
- Lever locks
- Includes belt for additional support

### Telescoping Wand Belt

- Works with both fiberglass and aluminum wands
- Includes three plastic snap-on clips that snap to your shoulder, waist and wand
- Reduces fatigue and strain on operator

PART NUMBER	DESCRIPTION	LIST PRICE
AW-7018-1200	Fiberglass wand - 12-foot	\$288.00
AW-7018-1800	Fiberglass wand - 18-foot	\$341.00
AW-7018-2400	Fiberglass wand - 24-foot	\$460.00
AW-7017-1800	Aluminum wand - 18-foot	\$485.00
AW-7017-2400	Aluminum wand - 24-foot	\$561.00
AW-7015-0001	Telescoping wand belt	\$45.00

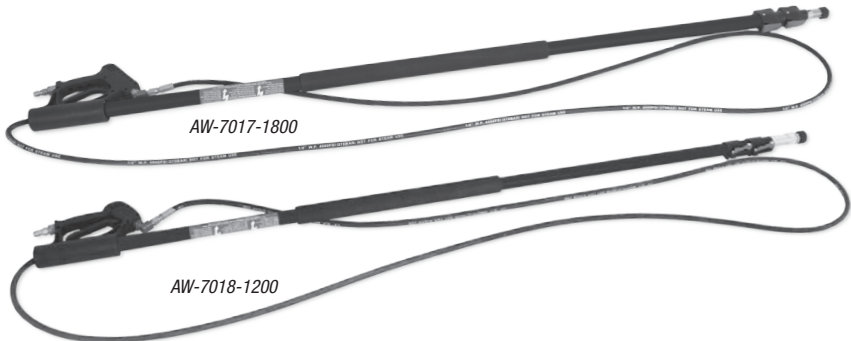

## Gutter Cleaner



- 4000-PSI maximum pressure
- ¼-inch quick connect socket outlet
- ¼-inch quick connect plug inlet

PART NUMBER	DESCRIPTION	LIST PRICE
50-0201	Gutter cleaner	\$19.00

## Aluminum Wand Extensions

- ¼-inch lance saver socket with quick connect plug
- 4000-PSI rated
- 12.0-GPM flow rate
- 300°F temperature rating

PART NUMBER	DESCRIPTION	LIST PRICE
AW-7105-3600	Aluminum wand extension - 36-inch	\$32.00
AW-7105-4800	Aluminum wand extension - 48-inch	\$36.00
AW-7105-7200	Aluminum wand extension - 72-inch	\$44.00
AW-7105-9600	Aluminum wand extension - 96-inch	\$54.00

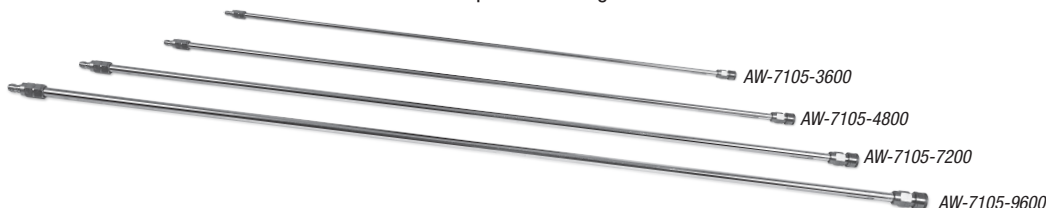



## Cold Water Gun and Wand Assemblies

– Includes quick connects

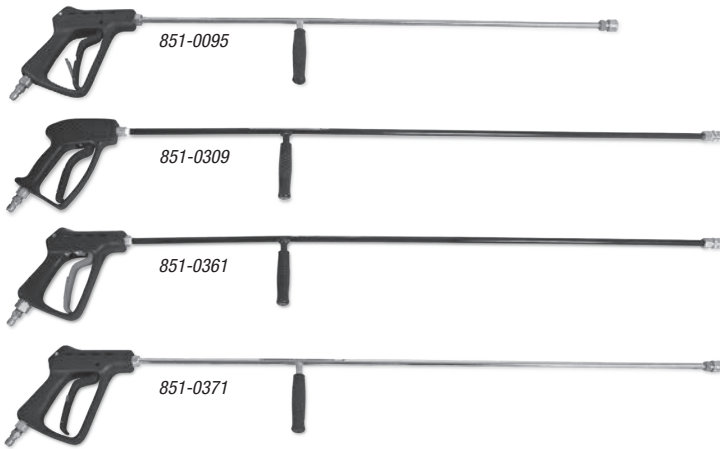

PART NUMBER	DESCRIPTION	LIST PRICE
851-0095	Gun & lance - 36-inch, 4000-PSI rated	\$131.00
851-0309	Gun & lance - 48-inch, 5000-PSI rated	\$331.00
851-0361	Gun & lance - 48-inch, 4000-PSI rated	\$940.00
851-0371	Gun & lance - 48-inch, 4000-PSI rated	\$136.00
AW-7103-1800	Powder coated steel wand extension - 18-inch	\$45.00
AW-7103-3600	Powder coated steel wand extension - 36-inch	\$59.00
AW-7103-7200	Powder coated steel wand extension - 72-inch	\$142.00



## Hot Water Gun and Wand Assemblies



– Includes quick connects  
– Adjustable pressure insulated dual lance

PART NUMBER	DESCRIPTION	LIST PRICE
850-0175	Dual lance - Hot water, 36-inch, 4500-PSI rated	\$355.00
850-0436	Dual lance - HSP Series, 48-inch, 4500-PSI rated	\$207.00

## Replacement Trigger Gun



PART NUMBER	DESCRIPTION	LIST PRICE
16-0001	Trigger gun - Rated up to 5000-PSI	\$54.00

## High Temperature O-Rings



PART NUMBER	DESCRIPTION	LIST PRICE
25-0594	High temperature o-rings - 3/8-inch high temp silicon; fits quick connect socket, 17-0004, on hot water outlet	\$1.95
25-0595	High temperature o-rings - 1/4-inch high temp silicon; fits quick connect socket, 17-0028, on wand	\$1.95

## Pivot Coupler



– For most cold water pressure washers rated up to 4500-PSI  
– Connects between the wand and high pressure nozzle  
– Adjusts to three different cleaning angles

PART NUMBER	DESCRIPTION	LIST PRICE
50-0208	Pivot coupler - 1/4-inch quick connect	\$38.00

## High Pressure Swivel Connector



– 3/8-inch MNPT x 3/8-inch FNPT  
– 5000-PSI maximum pressure  
– 42.0-GPM flow rate  
– Nickel plated with stainless-steel internal

PART NUMBER	DESCRIPTION	LIST PRICE
AW-0023-0507	High pressure swivel connector	\$41.00

# Rotary Surface Cleaners

## Rotary Surface Cleaners



PART NUMBER	DESCRIPTION	LIST PRICE
AW-7020-8009	Rotary surface cleaner - 14-inch	\$195.00
AW-7020-8003	Rotary surface cleaner - 20-inch	\$979.00
AW-7020-8005	Rotary surface cleaner - 20-inch, includes 50-0210 shut-off ball valve	\$1,041.00
AW-7020-8006	Rotary surface cleaner - 24-inch	\$2,094.00
AW-7020-8007	Rotary surface cleaner - 24-inch	\$2,094.00
AW-7020-8001	Rotary surface cleaner - 28-inch	\$3,054.00

### 14-inch Diameter

#### AW-7020-8009

- 8.0-GPM water volume
- 4200-PSI rated
- Quick connects to pressure washer wand

### 20-inch Diameter

#### AW-7020-8003

- 3.0 to 5.0-GPM water volume
- 4000-PSI rated
- Heat-treated sealed pressure swivel - requires no maintenance

### 20-inch Diameter

#### AW-7020-8005

- 3.0 to 5.0-GPM water volume
- 4000-PSI rated
- Heat-treated sealed pressure swivel - requires no maintenance
- Includes shut-off ball valve, 50-0210

### 24-inch Diameter

#### AW-7020-8006

- 2-nozzle spray bar
- 4.0-GPM water volume
- 4000-PSI rated
- Heat-treated sealed pressure swivel - requires no maintenance

### 24-inch Diameter

#### AW-7020-8007

- 3-nozzle spray bar
- 6.0-GPM water volume
- 4000-PSI rated
- Heat-treated sealed pressure swivel - requires no maintenance

### 28-inch Diameter

#### AW-7020-8001

- 4.0 to 10.0-GPM water volume
- 4000-PSI rated
- Heat-treated sealed pressure swivel - requires no maintenance

## Shut-Off Ball Valve



- Allows the user to switch back and forth from a rotary surface cleaner to a gun and wand while cleaning
- 3/8-inch male quick connect steel plug inlet
- 3/8-inch male quick connect brass coupler outlet

PART NUMBER	DESCRIPTION	LIST PRICE
50-0210	Shut-off ball valve - 4000-PSI maximum pressure	\$123.00

## Rotating Brush



- Natural hair bristles
- Quick connect
- Adjustable angle
- Rotating action, swivel head
- 3.0 to 6.0-GPM flow rate

PART NUMBER	DESCRIPTION	LIST PRICE
AW-7003-1500	Rotating brush	\$169.00

## Digital Hour Meter/Tachometer



- Updates every 3 seconds
- RPM to 9,900

PART NUMBER	DESCRIPTION	LIST PRICE
32-0416	Hour meter with tachometer	\$127.00

## High Pressure Extension Hoses



851-0338

### Cold Water High Pressure Hoses

- Includes quick connects, swivel and bend restrictors
- Chemical resistant
- Wire-braided
- Non-marking

COLD WATER EXTENSION HOSES		
PART NUMBER	DESCRIPTION	LIST PRICE
15-0273	Cold water - 100-foot x 3/8-inch ID, 4000-PSI, R1	\$452.00
15-0365	Cold water - 50-foot x 3/8-inch ID, 7200-PSI, R3	\$304.00
851-0006	Cold water - 50-foot x 3/8-inch ID, 4500-PSI, R2	\$323.00
851-0089	Cold water - 50-foot x 1/2-inch ID, 4500-PSI, R2	\$327.00
851-0317	Cold water - 50-foot x 3/8-inch ID, 6000-PSI, R2	\$346.00
851-0338	Cold water - 50-foot x 3/8-inch ID, 4000-PSI, R1	\$274.00
851-0420	Cold water - 50-foot x 3/8-inch ID, 7200-PSI	\$388.00
15-0006	Industrial water supply - 50-foot x 3/4-inch	\$166.00



15-0161

### Hot Water High Pressure Hoses

- Includes screw connects, swivel and bend restrictors on 850-0174 and 850-0199
- 851-0262 and 850-0433 includes quick connects, swivel and bend restrictors
- Chemical resistant
- Wire-braided
- For use with hose reels

HOT WATER EXTENSION HOSES		
PART NUMBER	DESCRIPTION	LIST PRICE
15-0077	Hot water - 50-foot x 3/8-inch ID, 3000-PSI, R1, steam combination	\$668.00
850-0174	Hot water - 50-foot x 3/8-inch ID, 2500-PSI, R1	\$218.00
850-0199	Hot water - 50-foot x 3/8-inch ID, 4500-PSI, R2	\$297.00
850-0433	Hot water - 50-foot x 3/8-inch ID, 4500-PSI, R2	\$284.00
851-0262	Hot water - 50-foot x 3/8-inch ID, 3000-PSI, R1	\$218.00
15-0146	Hot water - 50-foot x 3/8-inch ID, 3000-PSI, R1	\$175.00
15-0160	Hot water - 75-foot x 3/8-inch ID, 5800-PSI, R2	\$356.00
15-0161	Hot water - 100-foot x 3/8-inch ID, 5800-PSI, R2	\$479.00
15-0162	Hot water - 150-foot x 3/8-inch ID, 5800-PSI, R2	\$719.00
15-0163	Hot water - 200-foot x 3/8-inch ID, 5800-PSI, R2	\$965.00

## Hose Reels



50-0195

### 50-0195 and 50-0196

- 360° pivoting action
- Rated for units 4000-PSI and lower

### 50-0164 and 50-0165

- Non-pivoting action

### All Hose Reels

- Easy mount bracket design
- Clean hands hose guide
- Live system

*Note: Consult factory for correct mounting brackets and jumper hoses.*

PART NUMBER	DESCRIPTION	LIST PRICE
50-0195	Hose reel - 13-inch, 150-foot maximum hose length	\$946.00
50-0196	Hose reel - 16-inch, 200-foot maximum hose length	\$958.00
50-0164*	Hose reel without swivel - 13-inch, 100-foot maximum hose length	\$497.00
50-0165*	Hose reel without swivel - 16-inch, 200-foot maximum hose length	\$551.00
AW-0050-0138	Bracket - Universal mount, for HSP-2500 models, HS Series & HSE Direct Drive Series	\$32.00
13-0175A01	Bracket - Cold water base mount, for JCW & CW Premium Series	\$48.00
13-0179A01	Bracket - For hose reels on trailer units	\$85.00
13-0207A01	Bracket - Wall mount, for HG Series	\$18.00
13-0208A01	Bracket - 45°, mounts reel without swivel over unit	\$81.00
13-0210A01	Bracket - 90°, mounts reel without swivel to side of unit	\$63.00
50-0140	Bracket - 29-inch bar, for CWC Premium Series	\$80.00
24-0105+	Elbow - Required for use with 50-0164 and 50-0165 hose reels	\$16.00
15-0159	Jumper hose - For hose reels on trailer units	\$36.00
850-0278^	Jumper hose - Quick connect, 85-inch, for HS Series and HSE Direct Drive Series	\$89.00
852-0139^	Jumper hose - Quick connect, 57-inch, for Cold Water Pressure Washers, HSP Series and HSE Belt Drive Series	\$61.00

\*Must be mounted with 13-0208A01 (45° bracket) or 13-0210A01 (90° bracket).

+24-0105 (elbow) is required for jumper hose mounting.

^850-0278 and 852-0139 jumper hoses are not rated for steam applications.

# Packaged Accessories

## Packaged Accessory Program



4-Pack of Nozzles

– Mi-T-M's accessory packaging program clearly identifies the part on the front of the card. The back of the card features the part number and where the part is used. Consult factory for more packaged accessories.

### High Pressure Nozzles

- Sold in packs of individual nozzles, 3-packs and 4-packs
- Consult factory for correct orifice size and nozzle size needed

### Fittings

- Available in screw connect or quick connect styles



AW-0025-0122



AW-0017-0002



AW-0016-0001

HIGH PRESSURE NOZZLES		
PART NUMBER	DESCRIPTION	LIST PRICE
Consult Factory	Package of four nozzles - One each of 0°, 15°, 25° and 40° nozzles	\$23.00
Consult Factory	Package of three nozzles - Three nozzles with same orifice size and nozzle size	\$19.00
AW-0018-0148	65° detergent nozzle	\$9.00

O-RINGS		
PART NUMBER	DESCRIPTION	LIST PRICE
AW-0025-0122	O-rings - 3/8-inch x 9/16-inch, 10 qty.	\$6.00
AW-0025-0123	O-rings - 1/2-inch x 11/16-inch, 10 qty.	\$6.00

FITTINGS		
PART NUMBER	DESCRIPTION	LIST PRICE
AW-0017-0001	1/4-inch F x 1/4-inch socket	\$13.00
AW-0017-0002	1/4-inch M x 1/4-inch plug	\$6.00
AW-0017-0004	3/8-inch F x 3/8-inch socket	\$14.00
AW-0017-0005	3/8-inch M x 3/8-inch plug	\$6.00
AW-0017-0006	3/8-inch F x 3/8-inch plug	\$7.00
AW-0017-0028	1/4-inch M x 1/4-inch socket	\$14.00
AW-0017-0029	1/4-inch M x 3/8-inch socket	\$17.00
AW-0017-0035	M22 x 3/8-inch FNPT, 2-piece, screw connect	\$39.00
AW-0023-0017	3/8-inch M x 1/4-inch F adapter	\$6.00
AW-0023-0410	3/8-inch M x 1/4-inch BSP-F adapter	\$16.00
AW-0024-0251	3/8-inch M x 1/4-inch BSP-M adapter	\$17.00

GUN & WAND ASSEMBLY		
PART NUMBER	DESCRIPTION	LIST PRICE
AW-0016-0001	Trigger gun - Rated up to 5000-PSI	\$59.00
AW-0851-0096	36-inch wand assembly - Includes quick connect socket	\$37.00

## Pressure Washer Replacement Parts Box

- Secure case locking system to keep lid latched and parts secure
- Diagram card includes Mi-T-M parts numbers for quick reorder reference
- Lid hinges to reveal box components and location
- Storage compartments with adjustable plastic separators, keeps all parts organized for easy access
- Durable case is made of heavy plastic



PART NUMBER	DESCRIPTION	LIST PRICE
AW-1162-0174	Replacement parts box	\$348.00

AW-1162-0174 INCLUDES THE FOLLOWING PARTS:

PART NUMBER	DESCRIPTION	QUANTITY
17-0001	QC socket, 1/4-inch F x 1/4-inch, brass	2
17-0002	QC plug, 1/4-inch M x 1/4-inch, stainless-steel	2
17-0004	QC socket, 3/8-inch F x 3/8-inch, brass	2
17-0007	QC socket, 3/8-inch M x 3/8-inch, brass	2
17-0028	QC socket, 1/4-inch M x 1/4-inch, brass	2
17-0074	QC plug, 3/8-inch M x 3/8-inch, plated	2
17-0075	QC plug, 3/8-inch F x 3/8-inch, plated	2
18-0386	Chemical nozzle, 3.0 orifice, 65°	2
18-0387	Spray nozzle, 3.0 orifice, 0° (red)	2
18-0388	Spray nozzle, 3.0 orifice, 15° (yellow)	2
18-0390	Spray nozzle, 3.0 orifice, 25° (green)	2
18-0391	Spray nozzle, 3.0 orifice, 40° (white)	2
18-0392	Spray nozzle, 3.5 orifice, 0° (red)	2
18-0393	Spray nozzle, 3.5 orifice, 15° (yellow)	2
18-0395	Spray nozzle, 3.5 orifice, 25° (green)	2
18-0396	Spray nozzle, 3.5 orifice, 40° (white)	2
18-0397	Spray nozzle, 4.0 orifice, 0° (red)	2
18-0399	Spray nozzle, 4.0 orifice, 15° (yellow)	2
18-0400	Spray nozzle, 4.0 orifice, 25° (green)	2
18-0401	Spray nozzle, 4.0 orifice, 40° (white)	2
19-0206	Filter inlet valve, 1/2-inch M x 3/4-inch F	1
22-0005	Thermal relief valve, 1/2-inch M, 145°F	2
25-0122	O-ring, 3/8-inch x 3/16-inch	10
25-0123	O-ring, 1/2-inch x 11/16-inch	10

## Buddy Box - Pressure Washer Parts Box

- Secure case locking system to keep lid latched and parts secure
- Diagram card includes Mi-T-M parts numbers for quick reorder reference
- Lid hinges to reveal box components and location
- Storage compartments with adjustable plastic separators, keeps all parts organized for easy access
- Durable case is made of heavy plastic



PART NUMBER	DESCRIPTION	LIST PRICE
AW-1162-0194	Buddy Box - Pressure washer parts box	\$218.00

AW-1162-0194 INCLUDES THE FOLLOWING PARTS:

PART NUMBER	DESCRIPTION	QUANTITY
17-0001	QC socket, 1/4-inch F x 1/4-inch, brass	2
17-0004	QC plug, 3/8-inch F x 3/8-inch, brass	2
17-0074	QC plug, 3/8-inch M x 3/8-inch, plated	2
17-0075	QC plug, 3/8-inch F x 3/8-inch, plated	2
18-0373	Long range chemical nozzle	1
18-0386	Chemical nozzle, 3.0 orifice, 65°	1
18-0392	Spray nozzle, 3.5 orifice, 0° (red)	1
18-0393	Spray nozzle, 3.5 orifice, 15° (yellow)	1
18-0395	Spray nozzle, 3.5 orifice, 25° (green)	1
18-0396	Spray nozzle, 3.5 orifice, 40° (white)	1
19-0206	Filter inlet valve, 1/2-inch M x 3/4-inch F	1
22-0005	Thermal relief valve, 1/2-inch M, 145°F	1
23-0095	Garden hose connector, 1/2-inch M x 3/4-inch F	1
25-0122	O-ring, 3/8-inch x 3/16-inch	5
25-0123	O-ring, 1/2-inch x 11/16-inch	5

# Water Trailer

The dual-axle water trailer features a 510-gallon water tank and offers rear spray, fire and garden hose hook-ups and hydrant fill capabilities. It is great for dust control, cleaning parking lots and transporting water to remote locations.

- 2-inch semi-trash pump with 118cc Honda GX120 OHV engine
- Easy to operate butterfly brass valves
- 1½-inch fire hose hook-up with 50-foot x 1½-inch hose and fog nozzle
- Break-away hydrant fill with 25-foot x 2½-inch hose
- 2-inch ball hitch
- 1 year limited trailer warranty
- 2 year limited pump warranty
- 3 year limited Honda engine warranty
- 3 year limited water tank warranty

MODEL NUMBER	DESCRIPTION	LIST PRICE
MWT-0510-2MHD	Dual-axle trailer with 510-gallon water tank and 2-inch semi-trash pump	\$12,340.00

**Options:**

PART NUMBER	DESCRIPTION	LIST PRICE
TX-0008	<b>Hard suction option</b> - Allows you to draw water from an auxiliary source (pond, water pit, etc.). The fire hose is designed to be used with pressurized water and lays flat for easy storage.	\$1,232.00
TX-0010	<b>Adjustable trailer coupler hitch</b> - Replaces the standard 2-inch ball hitch with a 2-inch trailer hitch with pin-style fastener trailer coupler and hinged ball socket	\$341.00
TX-0019	<b>Lunette ring hitch</b> - Replaces the standard 2-inch ball hitch with an 3-inch integrated lunette ring for use with pintle hitches	\$210.00

As a company we continually strive to seek advancements in technology, therefore the design of the Mi-T-M water trailer may change after the publication of this catalog.

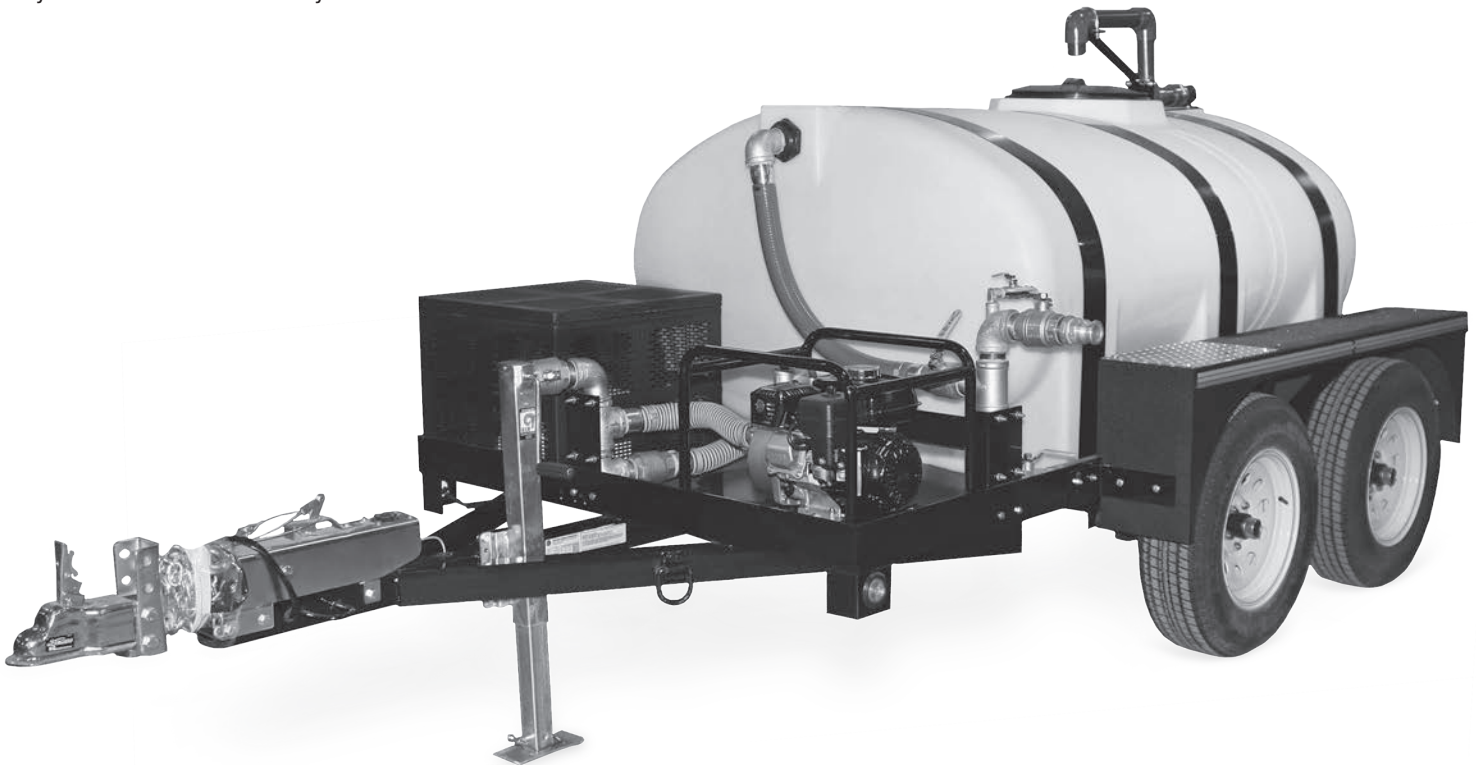

## PWR Series

The Portable Water Recovery Series is the ideal tool for remote cleaning applications. The compact design makes it an easy addition to trailer packages. The PWR Series allows for wash water to be reclaimed on the jobsite. Water is reclaimed by using the 20-foot water berm (included) to stop water from flowing down a drain or away from your area. The suction head draws wash water into a holding chamber where a second pump forces the water through an optional 10-micron bag filter before returning it to a holding tank for reuse, or proper disposal.

### System Includes:

- 1/3 HP transfer pump
- Oil absorbing boom/sock
- Vacuum tank drain
- 3-stage vacuum motor
- Stainless-steel suction head
- Cam lock fittings
- 50-foot vacuum hose
- 55-gallon capacity
- 20-foot water berm
- 1 year limited warranty on all components
- 1 year limited motor warranty
- 1 year limited transfer pump warranty



PWR Series Trailer Package, shown with AW-9000-0010 Portable Water Recovery Trailer, PWR-10-OME1 with WX-0129 option and HS-3505-1MGH with HX-0252 option



PWR-10-OME1 shown with standard accessories: oil absorbing boom, 33-0529; stainless-steel suction head, 21-0306; 50-ft. vacuum hose; and 20-ft. water berm, 33-0520; also shown with wheel kit option, WX-0106 and dual filters option, WX-0109

MODEL NUMBER	VACUUM MOTOR	TANK CAPACITY	FILTER PUMP	WATER BERM	SHIP WT.	NET WT.	LIST PRICE
PWR-10-OME1	3-stage, 1500W, 12.5A full load	55-gallons	1/3 HP, 8.0A, 120VAC, 60Hz, 1Ø	6in.x20ft.	340 lb.	290 lb.	\$3,650.00

### Accessories:

PART NUMBER	DESCRIPTION	LIST PRICE
19-0249	10-micron filter bag - 1 qty., fits inside WX-0108 & WX-0109 filters	\$27.00
19-0267	50-micron filter bag - 1 qty., fits inside WX-0109 filter	\$16.00
21-0306	Stainless-steel suction head	\$118.00
33-0520	Water berm - 6-in. x 20-ft.	\$265.00
33-0529	Oil absorbing boom - Oil sock for inside of tank	\$15.00
855-0057	50-ft. extension hose - Can have up to 100-ft. of extension hose	\$157.00

### Options:

PART NUMBER	DESCRIPTION	LIST PRICE
TX-0010	Adjustable trailer coupler hitch - Replaces the standard 2-inch ball hitch with a 2-inch trailer hitch with pin-style fastener trailer coupler and hinged ball socket; for AW-9000-0010 trailer package	\$341.00
TX-0019	Lunette ring hitch - Replaces the standard 2-inch ball hitch with an 3-inch integrated lunette ring for use with pintle hitches; for AW-9000-0010 trailer package	\$210.00
WX-0106	Wheel kit - Includes two flat-free tires, powder coated steel frame and handle	\$295.00
WX-0108	Single bag filter - Uses 10-micron bag #19-0249	\$1,330.00
WX-0109	Dual filters - Uses 10-micron bag #19-0249 and 50-micron bag #19-0267	\$2,815.00
WX-0129	Dual filters for PWR-10-OME1 trailer-mount package	\$2,815.00

### PWR Series Trailer Package, Includes:

PART NUMBER	DESCRIPTION	LIST PRICE
AW-9000-0010	Portable water recovery trailer - Includes 5-foot x 8 1/2-foot dual-axle trailer with 200-gallon water tank, 50-ft. inlet garden hose with hose reel and 100-ft. high pressure hose with hose reel	\$12,887.00
PWR-10-OME1 with WX-0129	PWR Series for trailer - Includes PWR-10-OME1, 2 bag filters (10 and 50-micron) and automatic discharge to outlet valve for reuse or discharge, mounts to AW-9000-0010 trailer	Consult Factory
HS-3505-1MGH with HX-0252	Hot water pressure washer - Includes HS-3505-1MGH hot water pressure, trailer tank feed, 80-mesh inlet Y-strainer and generator wired for burner and PWR-10-OME1 with WX-0129 option	Consult Factory

# Work Pro® Series

## Work Pro® Series

### 3, 4 & 5-Gallon Single Stage Electric



AM1-PE02-05M

MODEL NUMBER	CFM @ PSI	HORSEPOWER/MOTOR	TANK SIZE	SHIP WT.	NET WT.	LIST PRICE
AM1-HE15-03M	3.0 @ 90	1.5 HP, 120V, 15.0A	3-gallon	46 lb.	41 lb.	\$425.00
AM1-HE02-04M	4.2 @ 90	2.0 HP, 120V, 15.0A	4-gallon	68 lb.	60 lb.	\$560.00
AM1-PE02-05M	4.2 @ 90	2.0 HP, 120V, 15.0A	5-gallon	79 lb.	69 lb.	\$680.00



AM1-HE15-03M

- 3, 4 or 5-gallon powder coated tank assembly
- Quality single stage compressor
- Copper discharge hose
- 1 year limited compressor pump warranty
- 1 year limited electric motor warranty

## Work Pro® Series

### 5-Gallon Single Stage Gasoline



AM1-HM04-05WP

MODEL NUMBER	CFM @ PSI	DISPLACEMENT/ENGINE	TANK SIZE	SHIP WT.	NET WT.	LIST PRICE
AM1-HH04-05WP	4.8 @ 90	118cc Honda GX120 OHV	5-gallon	85 lb.	77 lb.	\$1,355.00
AM1-HM04-05WP	4.8 @ 90	136cc Mi-T-M OHV	5-gallon	85 lb.	77 lb.	\$1,085.00

#### Accessory:

PART NUMBER	DESCRIPTION	FITS MODELS	LIST PRICE
70-0357	Engine oil drain extension - 14-inch flexible drain hose makes oil changes clean and easy	All models	\$43.00

- 5-gallon powder coated twin tank assembly
- Quality single stage aluminum compressor
- Oil lubricated aluminum crankcase
- 1 year limited compressor pump warranty
- 1 year limited Mi-T-M engine warranty
- 3 year limited Honda engine warranty



# Work Pro® Series & Gasoline Air Compressors

## Work Pro® Series 8-Gallon Single/Two Stage Electric/Gasoline



CSA  
CERTIFIED

AM1-PE15-08WP

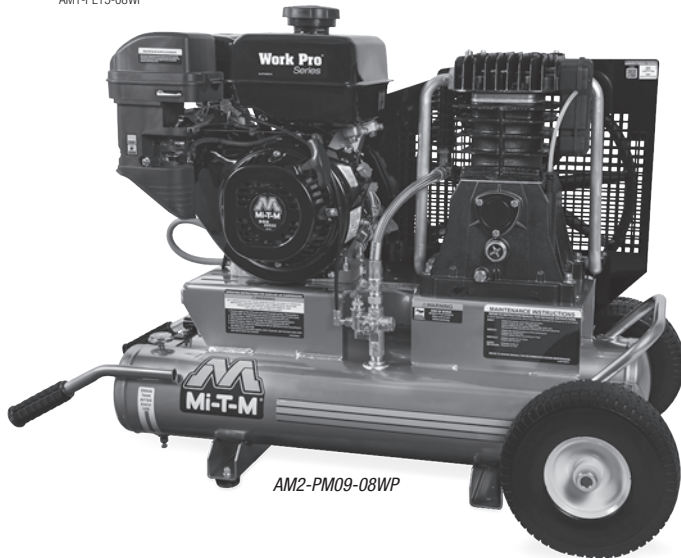

AM2-PM09-08WP

- 8-gallon powder coated twin tank assembly
- Quality single or two stage aluminum compressor
- Splash oil lubricated aluminum crankcase
- 10-inch flat-free tires (Two stage models have two tires)
- 1 year limited compressor pump warranty
- 1 year limited electric motor warranty
- 1 year limited Mi-T-M engine warranty
- 3 year limited Honda engine warranty

ELECTRIC MODEL						
MODEL NUMBER	CFM @ PSI	HORSEPOWER/MOTOR	STAGE	SHIP WT.	NET WT.	LIST PRICE
AM1-PE15-08WP	7.3 @ 90	1.5 HP, 115V, 13.2A	Single	160 lb.	140 lb.	\$1,300.00

GASOLINE MODELS						
MODEL NUMBER	CFM @ PSI	DISPLACEMENT/ENGINE	STAGE	SHIP WT.	NET WT.	LIST PRICE
AM1-PH06-08WP	9.0 @ 90	196cc Honda GX200 OHV	Single	160 lb.	135 lb.	\$1,560.00
AM1-PM06-08WP	9.0 @ 90	212cc Mi-T-M OHV	Single	160 lb.	135 lb.	\$1,230.00
AM1-PH65-08WP	13.9 @ 90	196cc Honda GX200 OHV	Single	170 lb.	145 lb.	\$1,640.00
AM1-PM65-08WP	13.9 @ 90	212cc Mi-T-M OHV	Single	170 lb.	145 lb.	\$1,385.00
AM2-PH09-08WP	17.2 @ 175*	270cc Honda GX270 OHV	Two	200 lb.	175 lb.	\$2,495.00
AM2-PM09-08WP	17.2 @ 175*	300cc Mi-T-M OHV	Two	200 lb.	175 lb.	\$1,950.00

\*Equipped with 150-PSI maximum rated regulator.

### Accessories & Options:

PART NUMBER	DESCRIPTION	FITS MODELS	LIST PRICE
70-0357	Engine oil drain extension - 14-inch flexible drain hose makes oil changes clean and easy	Single stage models	\$43.00
70-0358	Engine oil drain extension - 14-inch flexible drain hose makes oil changes clean and easy	Two stage models	\$45.00
AW-6000-1002	Equipment cover - Keeps your equipment clean, dry and looking like new	All models	\$187.00
AX-0002	Auto drain/regulator/plastic bowl - Drains moisture from air system	AM1-PE15-08WP	\$397.00
AX-0003	Manual drain/regulator/metal bowl - Drains moisture from air system	All models	\$273.00
AX-0015	Electric start - battery and cables not included - For easy starting	AM2-PH09-08WP	\$696.00
IX-0055	Remote start/choke - 6-ft. wire extension for key switch; you will also need to order electric start option, AX-0015	AM2-PH09-08WP	\$382.00

## 5-Gallon Single Stage Gasoline

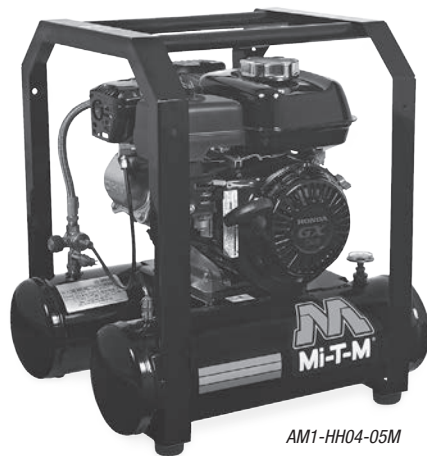

AM1-HH04-05M

- 5-gallon powder coated twin tank receivers
- Quality single stage compressor
- Powder coated steel frame with roll cage design
- 1 year limited compressor pump warranty
- 1 year limited Mi-T-M engine warranty
- 3 year limited Honda engine warranty

MODEL NUMBER	CFM @ PSI	DISPLACEMENT/ENGINE	SHIP WT.	NET WT.	LIST PRICE
AM1-HH04-05M	4.8 @ 90	118cc Honda GX120 OHV	85 lb.	77 lb.	\$1,375.00
AM1-HM04-05M	4.8 @ 90	136cc Mi-T-M OHV	85 lb.	77 lb.	\$1,105.00

### Accessory:

PART NUMBER	DESCRIPTION	FITS MODELS	LIST PRICE
70-0357	Engine oil drain extension - 14-inch flexible drain hose makes oil changes clean and easy	All models	\$43.00

# Gasoline Air Compressors

## 8-Gallon Single Stage Gasoline

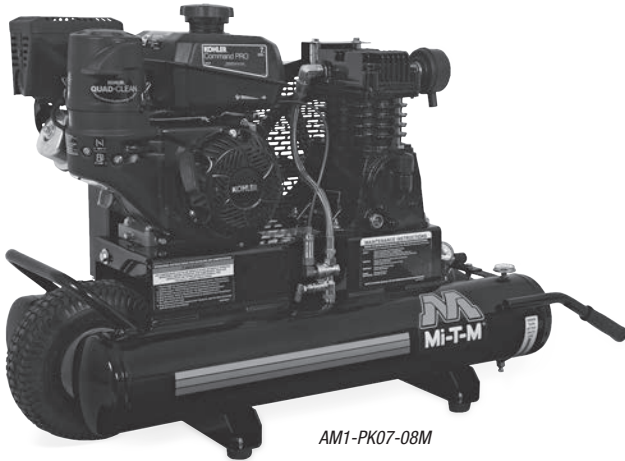

AM1-PK07-08M

- 8-gallon powder coated twin tank receivers
- Quality single stage compressor
- Quality pilot valve unloader
- 10-inch flat-free tire
- 2 year limited pump exchange warranty
- 3 year limited Honda and Kohler engine warranties

MODEL NUMBER	CFM @ PSI	DISPLACEMENT/ENGINE	SHIP WT.	NET WT.	LIST PRICE
AM1-PH65-08M	13.9 @ 90	196cc Honda GX200 OHV	200 lb.	175 lb.	\$1,655.00
AM1-PK07-08M	13.9 @ 90	208cc Kohler CH270 OHV	200 lb.	175 lb.	\$1,485.00

### Accessories & Options:

PART NUMBER	DESCRIPTION	FITS MODELS	LIST PRICE
70-0357	Engine oil drain extension - 14-inch flexible drain hose makes oil changes clean and easy	All models	\$43.00
854-0093	Service truck mount kit (recommended for models that are mounted in service truck applications) - Includes four rubber isolators to reduce wear; you will also need to order stationary option, AX-0078	All models	\$113.00
AW-6000-1002	Equipment cover - Keeps your equipment clean, dry and looking like new	All models	\$187.00
AX-0003	Manual drain/regulator/metal bowl - Drains moisture from air system	All models	\$273.00
AX-0078	Stationary option - Converts the portable model to a stationary model, removes the wheel	All models	No charge

## 20-Gallon Single Stage Gasoline

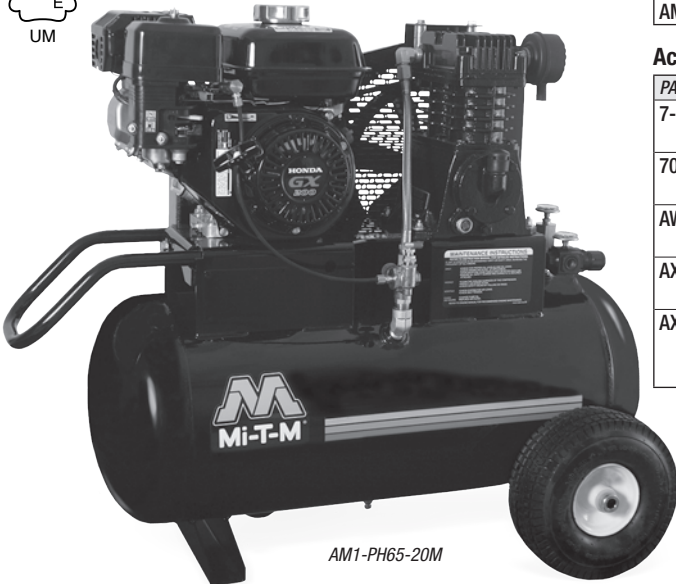

AM1-PH65-20M

- Powder coated ASME coded 20-gallon receiver tank
- Quality single stage compressor
- Quality pilot valve unloader
- 10-inch flat-free tires
- 2 year limited pump exchange warranty
- 3 year limited Honda engine warranty

MODEL NUMBER	CFM @ PSI	DISPLACEMENT/ENGINE	SHIP WT.	NET WT.	LIST PRICE
AM1-PH65-20M	13.9 @ 90	196cc Honda GX200 OHV	272 lb.	212 lb.	\$1,920.00

### Accessories & Options:

PART NUMBER	DESCRIPTION	FITS MODEL	LIST PRICE
7-0228A01	Rear lifting handle - Allows unit to be lifted from both ends	AM1-PH65-20M	\$73.00
70-0357	Engine oil drain extension - 14-inch flexible drain hose makes oil changes clean and easy	AM1-PH65-20M	\$43.00
AW-6000-1002	Equipment cover - Keeps your equipment clean, dry and looking like new	AM1-PH65-20M	\$187.00
AX-0003	Manual drain/regulator/metal bowl - Drains moisture from air system	AM1-PH65-20M	\$273.00
AX-0027	Stationary kit - Converts the portable model to a stationary model, removes the wheels and adds a stationary leg	AM1-PH65-20M	No charge

## 8-Gallon Two Stage Gasoline

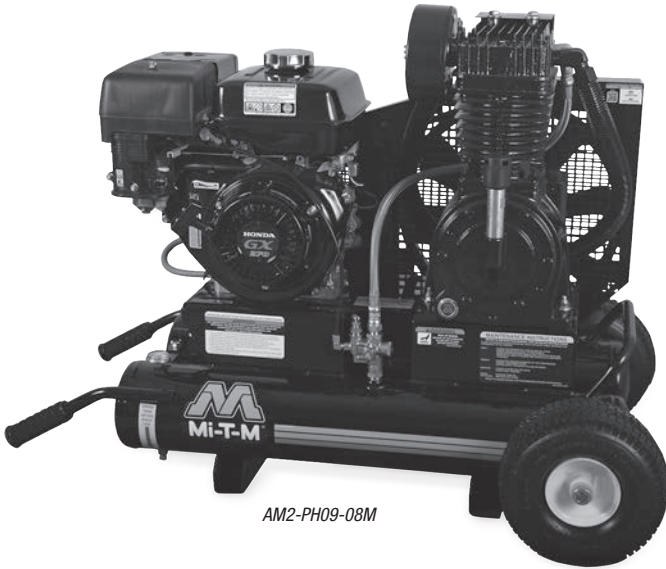

AM2-PH09-08M

- 8-gallon powder coated twin tank receivers
- Quality two stage compressor
- Quality pilot valve unloader
- 10-inch flat-free tires
- 2 year limited pump exchange warranty
- 3 year limited Honda and Kohler engine warranties

MODEL NUMBER	CFM @ PSI*	DISPLACEMENT/ENGINE	SHIP WT.	NET WT.	LIST PRICE
AM2-PH09-08M	17.2 @ 175	270cc Honda GX270 OHV	330 lb.	260 lb.	\$2,775.00
AM2-PK95-08M	17.2 @ 175	277cc Kohler CH395 OHV	330 lb.	260 lb.	\$2,485.00

\*Equipped with 150-PSI maximum rated regulator.

### Accessories & Options:

PART NUMBER	DESCRIPTION	FITS MODELS	LIST PRICE
AW-6000-1002	Equipment cover - Keeps your equipment clean, dry and looking like new	All models	\$187.00
AX-0003	Manual drain/regulator/metal bowl - Drains moisture from air system	All models	\$273.00
AX-0015	Electric start - battery and cables not included - For easy starting	AM2-PH09-08M	\$696.00
IX-0055	Remote start/choke - 6-ft. wire extension for key switch; you will also need to order electric start option, AX-0015	AM2-PH09-08M	\$382.00

## 20-Gallon Two Stage Gasoline

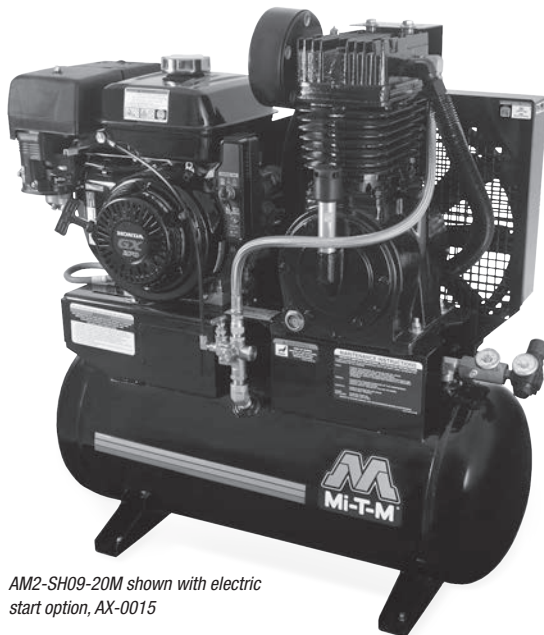

AM2-SH09-20M shown with electric start option, AX-0015

- Powder coated ASME coded 20-gallon receiver tank
- Quality two stage compressor
- Quality pilot valve unloader
- 13-inch flat-free tires (AM2-PH09-20M only)
- 2 year limited pump exchange warranty
- 3 year limited Honda engine warranty

MODEL NUMBER	CFM @ PSI*	DISPLACEMENT/ENGINE	TYPE	SHIP WT.	NET WT.	LIST PRICE
AM2-PH09-20M	17.2 @ 175	270cc Honda GX270 OHV	Portable	356 lb.	306 lb.	\$3,055.00
AM2-SH09-20M	17.2 @ 175	270cc Honda GX270 OHV	Stationary	356 lb.	306 lb.	\$2,890.00

\*Equipped with 150-PSI maximum rated regulator.

### Accessories & Options:

PART NUMBER	DESCRIPTION	FITS MODELS	LIST PRICE
854-0093	Service truck mount kit (recommended for models that are mounted in service truck applications) - Includes four rubber isolators to reduce wear	AM2-SH09-20M	\$113.00
AW-0007-0196	Rear lifting handle (N/A for models with AX-0017 option) - Allows unit to be lifted from both ends	AM2-PH09-20M	\$86.00
AW-6000-1002	Equipment cover - Keeps your equipment clean, dry and looking like new	All models	\$187.00
AX-0003	Manual drain/regulator/metal bowl - Drains moisture from air system	All models	\$273.00
AX-0015	Electric start - battery and cables not included - For easy starting	All models	\$696.00
AX-0017	Electric start - battery and cables included - For easy starting	All models	\$949.00
IX-0055	Remote start/choke - 6-ft. wire extension for key switch; you will also need to order electric start option, AX-0015	All models	\$382.00

# Gasoline Air Compressors

## 30 & 80-Gallon or Base-Mount Two Stage Gasoline

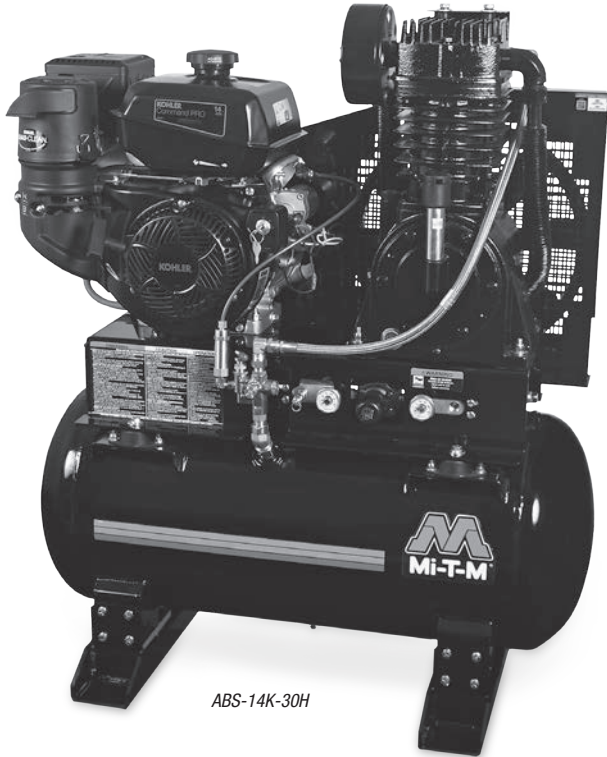
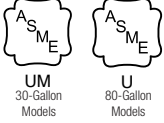

ABS-14K-30H

TANK-MOUNTED MODELS						
MODEL NUMBER	CFM @ PSI*	DISPLACEMENT/ENGINE	TANK SIZE	SHIP WT.	NET WT.	LIST PRICE
ABS-13H-30H	29.0 @ 175	389cc Honda GX390 OHV	30-gallon	480 lb.	416 lb.	\$4,610.00
ABS-14K-30H	29.0 @ 175	429cc Kohler CH440 OHV	30-gallon	480 lb.	416 lb.	\$3,845.00
ABS-14S-30H	29.0 @ 175	404cc Subaru EX40 OHC	30-gallon	480 lb.	416 lb.	\$4,475.00
ABS-13H-80H	29.0 @ 175	389cc Honda GX390 OHV	80-gallon	560 lb.	496 lb.	\$4,900.00
ABS-14S-80H	29.0 @ 175	404cc Subaru EX40 OHC	80-gallon	560 lb.	496 lb.	\$4,795.00

BASE-MOUNTED MODELS						
MODEL NUMBER	CFM @ PSI*	DISPLACEMENT/ENGINE	TANK SIZE	SHIP WT.	NET WT.	LIST PRICE
ABS-13H-B	29.0 @ 175	389cc Honda GX390 OHV	Base-mount	279 lb.	215 lb.	\$4,045.00
ABS-14S-B	29.0 @ 175	404cc Subaru EX40 OHC	Base-mount	279 lb.	215 lb.	\$3,930.00

\*Equipped with 150-PSI maximum rated regulator.

### Accessories & Options:

PART NUMBER	DESCRIPTION	FITS MODELS	LIST PRICE
AW-6000-1002	Equipment cover - Keeps your equipment clean, dry and looking like new	30-gallon & base-mount models	\$187.00
AX-0077	Battery box and tray - Attaches to engine side of unit	30 & 80-gallon models	\$98.00
IX-0001	Vibration isolator pads - Isolators protect the unit from vibration during use; Recommended for models that are mounted in service truck applications	30 & 80-gallon models	\$160.00
IX-0055	Remote start/choke - 6-ft. wire extension for key switch	Honda models	\$382.00

- Powder coated ASME coded 30 or 80-gallon receiver tank (Tank-mounted models)
- Quality two stage compressor
- Electric start engine - battery and cables not included
- 2 year limited pump exchange warranty
- 3 year limited Honda and Kohler engine warranties
- 5 year limited Subaru engine warranty

# Diesel & Electric Air Compressors

## 30-Gallon Two Stage Diesel

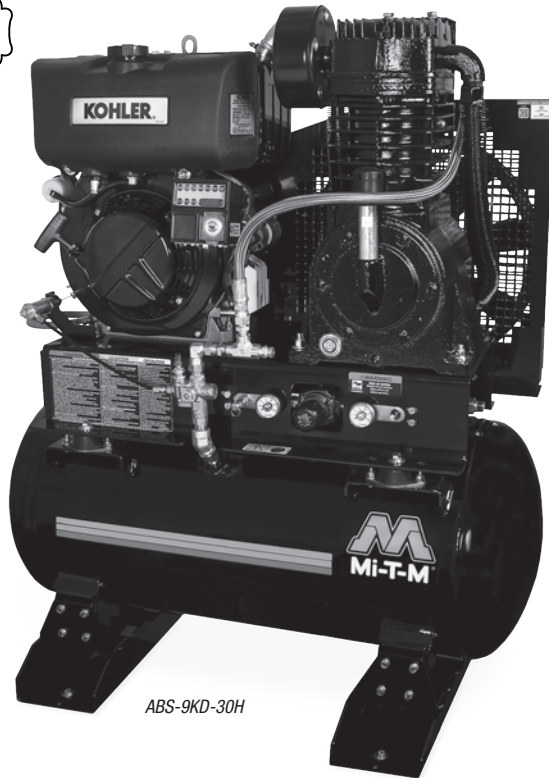

MODEL NUMBER	CFM @ PSI*	HORSEPOWER/ENGINE	SHIP WT.	NET WT.	LIST PRICE
ABS-9KD-30H	29.0 @ 175	9.1 HP Kohler KD440 OHV	540 lb.	483 lb.	\$7,250.00

\*Equipped with 150-PSI maximum rated regulator.

### Accessory & Option:

PART NUMBER	DESCRIPTION	FITS MODEL	LIST PRICE
AW-6000-1002	Equipment cover - Keeps your equipment clean, dry and looking like new	ABS-9KD-30H	\$187.00
IX-0001	Vibration isolator pads - Isolators protect the unit from vibration during use; Recommended for models that are mounted in service truck applications	ABS-9KD-30H	\$160.00

- Powder coated ASME coded 30-gallon receiver tank
- Quality two stage compressor
- Electric start engine - battery, box and cables not included
- Glow plug equipped engine for easy starting in cold temperatures
- 2 year limited pump exchange warranty
- 3 year limited Kohler engine warranty

## 5-Gallon Single Stage Electric



MODEL NUMBER	CFM @ PSI	HORSEPOWER/MOTOR	SHIP WT.	NET WT.	LIST PRICE
AM1-HE02-05M	4.2 @ 90	2.0 HP, 120V, 15.0A	70 lb.	61 lb.	\$665.00

- 5-gallon powder coated twin tank receivers
- Quality single stage compressor
- Stainless-steel braided discharge hose
- 1 year limited compressor pump warranty
- 1 year limited electric motor warranty

# Electric Air Compressors

## 8-Gallon Single Stage Electric

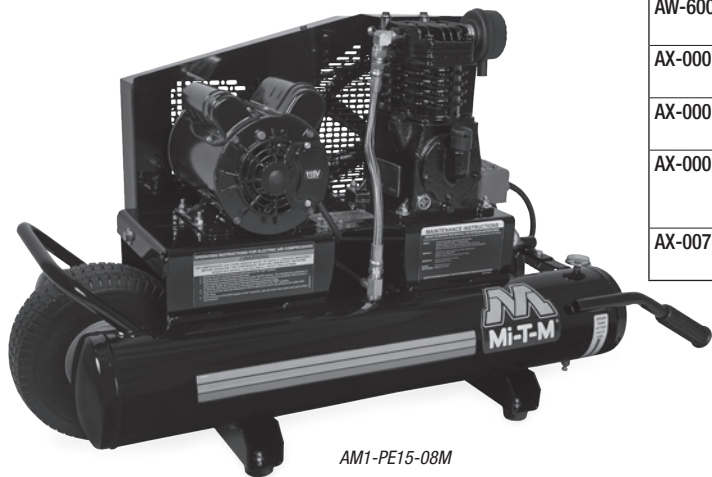

AM1-PE15-08M

- 8-gallon powder coated twin tank receivers
- Quality single stage compressor
- Auto start/stop - continuous run optional
- 10-inch flat-free tire
- 1 year limited electric motor warranty
- 2 year limited pump exchange warranty

MODEL NUMBER	CFM @ PSI	HORSEPOWER/MOTOR	SHIP WT.	NET WT.	LIST PRICE
AM1-PE15-08M	7.3 @ 90	1.5 HP, 120V, 13.2A	190 lb.	170 lb.	\$1,360.00
AM1-PE02-08M	9.2 @ 90	2.0 HP, 120V, 18.8A	203 lb.	183 lb.	\$1,455.00

### Accessory & Options:

PART NUMBER	DESCRIPTION	FITS MODELS	LIST PRICE
AW-6000-1002	Equipment cover - Keeps your equipment clean, dry and looking like new	All models	\$187.00
AX-0002	Auto drain/regulator/plastic bowl - Drains moisture from air system	All models	\$397.00
AX-0003	Manual drain/regulator/metal bowl - Drains moisture from air system	All models	\$273.00
AX-0005	Dual control - Compressor can be operated in start/stop mode or continuous run where pilot valve exhausts air to atmosphere	All models	\$135.00
AX-0078	Stationary option - Converts the portable model to a stationary model, removes the wheel	All models	No charge

## 20-Gallon Single Stage Electric

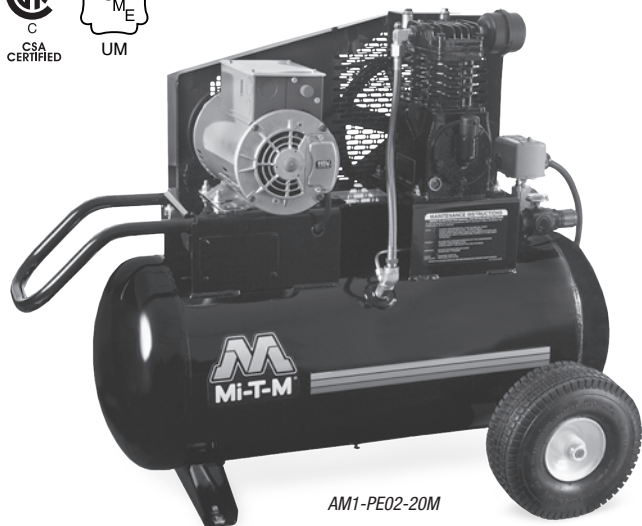

AM1-PE02-20M

- Powder coated ASME coded 20-gallon receiver tank
- Quality single stage compressor
- Auto start/stop - continuous run optional
- 10-inch flat-free tires
- 1 year limited electric motor warranty
- 2 year limited pump exchange warranty

MODEL NUMBER	CFM @ PSI	HORSEPOWER/MOTOR	SHIP WT.	NET WT.	LIST PRICE
AM1-PE15-20M	7.3 @ 90	1.5 HP, 120V, 13.2A	265 lb.	196 lb.	\$1,630.00
AM1-PE02-20M	9.2 @ 90	2.0 HP, 120V, 18.8A	272 lb.	203 lb.	\$1,715.00

### Accessory & Options:

PART NUMBER	DESCRIPTION	FITS MODELS	LIST PRICE
AW-6000-1002	Equipment cover - Keeps your equipment clean, dry and looking like new	All models	\$187.00
AX-0002	Auto drain/regulator/plastic bowl - Drains moisture from air system	All models	\$397.00
AX-0003	Manual drain/regulator/metal bowl - Drains moisture from air system	All models	\$273.00
AX-0008	Dual control - Compressor can be operated in start/stop mode or continuous run where pilot valve exhausts air to atmosphere	All models	\$129.00
AX-0027	Stationary kit - Converts the portable model to a stationary model, removes the wheels and adds a stationary leg	All models	No charge

## 80 & 120-Gallon Two Stage Electric Simplex



ACS-23105-80V

- Powder coated ASME coded 80 or 120-gallon receiver tank
- Quality two stage compressor
- Stainless-steel braided discharge hose
- Magnetic starter for thermal overload protection
- Hour meter
- 1 year limited electric motor warranty
- 2 year limited pump exchange warranty

SIMPLEX HORIZONTAL MODELS						
MODEL NUMBER	CFM @ PSI	HORSEPOWER/MOTOR	TANK SIZE	SHIP WT.	NET WT.	LIST PRICE
ACS-23105-80H	18.0 @ 175	5.0 HP, 230V, 23.0A, 1 Phase	80-gallon	585 lb.	514 lb.	<b>\$4,075.00</b>
ACS-20305-80H	18.0 @ 175	5.0 HP, 200V, 16.1A, 3 Phase	80-gallon	585 lb.	514 lb.	<b>\$3,640.00</b>
ACS-23305-80H	18.0 @ 175	5.0 HP, 230V, 13.8A, 3 Phase	80-gallon	585 lb.	514 lb.	<b>\$3,645.00</b>
ACS-46305-80H	18.0 @ 175	5.0 HP, 460V, 6.9A, 3 Phase	80-gallon	585 lb.	514 lb.	<b>\$3,775.00</b>
ACS-23175-80H	23.5 @ 175	7.5 HP, 230V, 31.0A, 1 Phase	80-gallon	665 lb.	594 lb.	<b>\$4,835.00</b>
ACS-20375-80H	23.5 @ 175	7.5 HP, 200V, 23.0A, 3 Phase	80-gallon	665 lb.	594 lb.	<b>\$4,460.00</b>
ACS-23375-80H	23.5 @ 175	7.5 HP, 230V, 20.0A, 3 Phase	80-gallon	665 lb.	594 lb.	<b>\$4,460.00</b>
ACS-46375-80H	23.5 @ 175	7.5 HP, 460V, 10.0A, 3 Phase	80-gallon	665 lb.	594 lb.	<b>\$4,625.00</b>
ADS-23110-120H	34.2 @ 175	10.0 HP, 230V, 39.0A, 1 Phase	120-gallon	904 lb.	785 lb.	<b>\$6,255.00</b>
ADS-20310-120H	34.2 @ 175	10.0 HP, 200V, 30.8A, 3 Phase	120-gallon	904 lb.	785 lb.	<b>\$6,330.00</b>
ADS-23310-120H	34.2 @ 175	10.0 HP, 230V, 26.8A, 3 Phase	120-gallon	904 lb.	785 lb.	<b>\$6,190.00</b>
ADS-46310-120H	34.2 @ 175	10.0 HP, 460V, 13.4A, 3 Phase	120-gallon	904 lb.	785 lb.	<b>\$6,445.00</b>
AES-20315-120H	46.5 @ 175	15.0 HP, 200V, 44.0A, 3 Phase	120-gallon	995 lb.	876 lb.	<b>\$7,800.00</b>
AES-23315-120H	46.5 @ 175	15.0 HP, 230V, 38.0A, 3 Phase	120-gallon	995 lb.	876 lb.	<b>\$7,560.00</b>
AES-46315-120H	46.5 @ 175	15.0 HP, 460V, 19.0A, 3 Phase	120-gallon	995 lb.	876 lb.	<b>\$7,800.00</b>

SIMPLEX VERTICAL MODELS						
MODEL NUMBER	CFM @ PSI	HORSEPOWER/MOTOR	TANK SIZE	SHIP WT.	NET WT.	LIST PRICE
ACS-23105-80V	18.0 @ 175	5.0 HP, 230V, 23.0A, 1 Phase	80-gallon	585 lb.	514 lb.	<b>\$4,100.00</b>
ACS-20305-80V	18.0 @ 175	5.0 HP, 200V, 16.1A, 3 Phase	80-gallon	585 lb.	514 lb.	<b>\$3,655.00</b>
ACS-23305-80V	18.0 @ 175	5.0 HP, 230V, 13.8A, 3 Phase	80-gallon	585 lb.	514 lb.	<b>\$3,660.00</b>
ACS-46305-80V	18.0 @ 175	5.0 HP, 460V, 6.9A, 3 Phase	80-gallon	585 lb.	514 lb.	<b>\$3,795.00</b>
ACS-23175-80V	23.5 @ 175	7.5 HP, 230V, 31.0A, 1 Phase	80-gallon	665 lb.	594 lb.	<b>\$4,865.00</b>
ACS-20375-80V	23.5 @ 175	7.5 HP, 200V, 23.0A, 3 Phase	80-gallon	665 lb.	594 lb.	<b>\$4,480.00</b>
ACS-23375-80V	23.5 @ 175	7.5 HP, 230V, 20.0A, 3 Phase	80-gallon	665 lb.	594 lb.	<b>\$4,480.00</b>
ACS-46375-80V	23.5 @ 175	7.5 HP, 460V, 10.0A, 3 Phase	80-gallon	665 lb.	594 lb.	<b>\$4,650.00</b>

### Accessories & Options:

PART NUMBER	DESCRIPTION	FITS MODELS	LIST PRICE
3-0312	Pump - Replacement pump	ACS horizontal & vertical models	<b>\$1,454.00</b>
3-0313	Pump - Replacement pump	ADS models	<b>\$2,913.00</b>
3-0314	Pump - Replacement pump	AES models	<b>\$4,287.00</b>
IX-0001	Vibration pads - Isolators protect the unit from vibration during use	All models	<b>\$160.00</b>
IX-0002	After cooler - Removes up to 65% of the moisture from discharged compressed air and drops the temperature within 10° of ambient	ACS vertical models	<b>\$495.00</b>
IX-0003	After cooler - Removes up to 65% of the moisture from discharged compressed air and drops the temperature within 10° of ambient	ADS models	<b>\$635.00</b>
IX-0004	After cooler - Removes up to 65% of the moisture from discharged compressed air and drops the temperature within 10° of ambient	AES models	<b>\$510.00</b>
IX-0006	Electric tank drain - Automatically drains liquid from compressor tank (Recommended to use with an after cooler)	All models	<b>\$356.00</b>
IX-0008	Low oil monitor - Low oil sensor does not allow unit to start when oil levels fall below an adequate level	ACS horizontal & vertical models	<b>\$196.00</b>
IX-0032	Pneumatic tank drain - Automatically drains liquid from compressor tank (Recommended to use with an after cooler)	ADS & AES models	<b>\$382.00</b>
IX-0036	Low oil monitor - Low oil sensor does not allow unit to start when oil levels fall below an adequate level	ADS & AES models	<b>\$253.00</b>
IX-0051	Pneumatic tank drain - Automatically drains liquid from compressor tank (Recommended to use with an after cooler)	ACS vertical models	<b>\$382.00</b>
IX-0052	After cooler - Removes up to 65% of the moisture from discharged compressed air and drops the temperature within 10° of ambient	ACS horizontal models	<b>\$475.00</b>
IX-0056	Pneumatic tank drain - Automatically drains liquid from compressor tank; unit cannot include an after cooler	ACS horizontal models	<b>\$299.00</b>
IX-0057	Pneumatic tank drain - Automatically drains liquid from compressor tank; you must also have IX-0052 after cooler option	ACS horizontal models	<b>\$295.00</b>
IX-0058	Pneumatic tank drain - Automatically drains liquid from compressor tank; you must also have IX-0002 after cooler option	ACS vertical models	<b>\$285.00</b>

## 80 & 120-Gallon Two Stage Electric Duplex

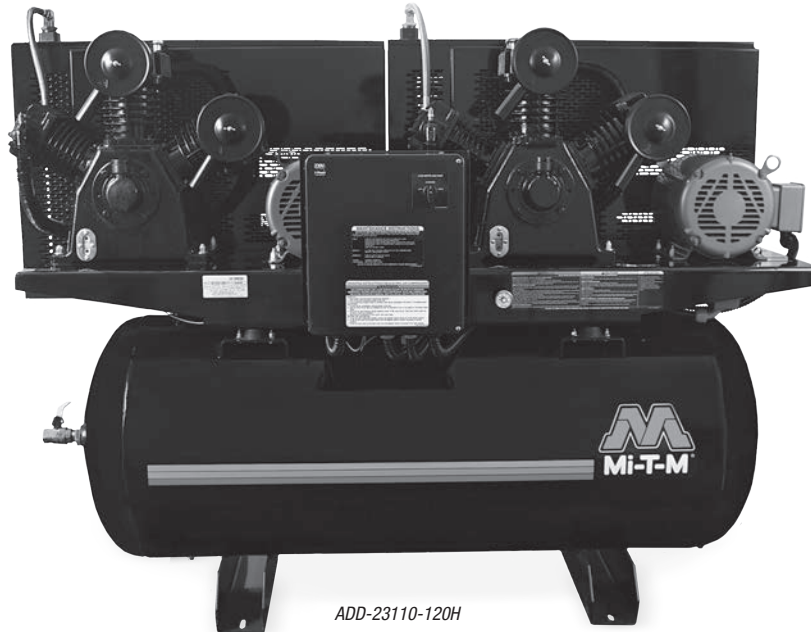

ADD-23110-120H

- Powder coated ASME coded 80 or 120-gallon receiver tank
- Quality two stage compressor
- Stainless-steel braided discharge hose
- Magnetic starter for thermal overload protection
- Hour meter
- 1 year limited electric motor warranty
- 2 year limited pump exchange warranty

### DUPLEX VERTICAL MODELS

MODEL NUMBER	CFM @ PSI	HORSEPOWER/MOTOR	TANK SIZE	SHIP WT.	NET WT.	LIST PRICE
ACD-23105-120H	36.0 @ 175	5.0 HP, 230V, 46.0A, 1 Phase	120-gallon	920 lb.	841 lb.	\$7,570.00
ACD-20305-120H	36.0 @ 175	5.0 HP, 200V, 32.2A, 3 Phase	120-gallon	920 lb.	841 lb.	\$7,155.00
ACD-23305-120H	36.0 @ 175	5.0 HP, 230V, 27.6A, 3 Phase	120-gallon	920 lb.	841 lb.	\$7,155.00
ACD-46305-120H	36.0 @ 175	5.0 HP, 460V, 13.8A, 3 Phase	120-gallon	920 lb.	841 lb.	\$7,150.00
ACD-23175-120H	46.4 @ 175	7.5 HP, 230V, 62.0A, 1 Phase	120-gallon	900 lb.	821 lb.	\$7,965.00
ACD-20375-120H	46.4 @ 175	7.5 HP, 200V, 46.0A, 3 Phase	120-gallon	900 lb.	821 lb.	\$7,605.00
ACD-23375-120H	46.4 @ 175	7.5 HP, 230V, 40.0A, 3 Phase	120-gallon	900 lb.	821 lb.	\$7,615.00
ACD-46375-120H	46.4 @ 175	7.5 HP, 460V, 20.0A, 3 Phase	120-gallon	900 lb.	821 lb.	\$7,615.00
ADD-23110-120H	68.4 @ 175	10.0 HP, 230V, 78.0A, 1 Phase	120-gallon	1200 lb.	1121 lb.	\$11,420.00
ADD-20310-120H	68.4 @ 175	10.0 HP, 200V, 61.6A, 3 Phase	120-gallon	1200 lb.	1121 lb.	\$10,005.00
ADD-23310-120H	68.4 @ 175	10.0 HP, 230V, 53.6A, 3 Phase	120-gallon	1200 lb.	1121 lb.	\$10,025.00
ADD-46310-120H	68.4 @ 175	10.0 HP, 460V, 26.8A, 3 Phase	120-gallon	1200 lb.	1121 lb.	\$10,025.00
AED-20315-120H	93.0 @ 175	15.0 HP, 200V, 88.0A, 3 Phase	120-gallon	1550 lb.	1471 lb.	\$12,710.00
AED-23315-120H	93.0 @ 175	15.0 HP, 230V, 76.0A, 3 Phase	120-gallon	1550 lb.	1471 lb.	\$12,460.00
AED-46315-120H	93.0 @ 175	15.0 HP, 460V, 38.0A, 3 Phase	120-gallon	1550 lb.	1471 lb.	\$12,460.00

### Accessories & Options:

PART NUMBER	DESCRIPTION	FITS MODELS	LIST PRICE
3-0312	Pump - Replacement pump	ACD models	\$1,454.00
3-0313	Pump - Replacement pump	ADD models	\$2,913.00
3-0314	Pump - Replacement pump	AED models	\$4,287.00
IX-0001	Vibration pads - Isolators protect the unit from vibration during use	All models	\$160.00
IX-0006	Electric tank drain - Automatically drains liquid from compressor tank (Recommended to use with an after cooler)	All models	\$356.00
IX-0008	Low oil monitor - Low oil sensor does not allow unit to start when oil levels fall below an adequate level	ACD models	\$196.00
IX-0032	Pneumatic tank drain - Automatically drains liquid from compressor tank (Recommended to use with an after cooler)	All models	\$382.00
IX-0033	After cooler - Removes up to 65% of the moisture from discharged compressed air and drops the temperature within 10° of ambient	ACD models	\$712.00
IX-0034	After cooler - Removes up to 65% of the moisture from discharged compressed air and drops the temperature within 10° of ambient	ADD models	\$846.00
IX-0035	After cooler - Removes up to 65% of the moisture from discharged compressed air and drops the temperature within 10° of ambient	AED models	\$877.00
IX-0036	Low oil monitor - Low oil sensor does not allow unit to start when oil levels fall below an adequate level	ADD & AED models	\$253.00



## 80 & 120-Gallon – M Series Two Stage Electric Simplex & Duplex



ACS-23105-80VM

- Powder coated ASME coded 80 or 120-gallon receiver tank
- Quality two stage compressor
- Stainless-steel braided discharge hose
- Magnetic starter for thermal overload protection
- Hour meter
- 1 year limited electric motor warranty
- 2 year limited pump exchange warranty

### These standard features are what sets the M Series air compressors apart from our standard line-up.

- Air-cooled after cooler removes up to 65% of moisture and drops temperature within 10°F of ambient
- Low oil sensor does not allow unit to start when oil levels fall below an adequate level
- Tank drain automatically drains liquid from the air receiver
- Vibration isolator pads protect the tank from stress

SIMPLEX HORIZONTAL MODELS						
MODEL NUMBER	CFM @ PSI	HORSEPOWER/MOTOR	TANK SIZE	SHIP WT.	NET WT.	LIST PRICE
ACS-23105-80HM	18.0 @ 175	5.0 HP, 230V, 23.0A, 1 Phase	80-gallon	615 lb.	544 lb.	\$5,095.00
ACS-20305-80HM	18.0 @ 175	5.0 HP, 200V, 16.1A, 3 Phase	80-gallon	615 lb.	544 lb.	\$4,700.00
ACS-23305-80HM	18.0 @ 175	5.0 HP, 230V, 13.8A, 3 Phase	80-gallon	615 lb.	544 lb.	\$4,700.00
ACS-46305-80HM	18.0 @ 175	5.0 HP, 460V, 6.9A, 3 Phase	80-gallon	615 lb.	544 lb.	\$4,695.00
ACS-23175-80HM	23.5 @ 175	7.5 HP, 230V, 31.0A, 1 Phase	80-gallon	780 lb.	709 lb.	\$5,505.00
ACS-20375-80HM	23.5 @ 175	7.5 HP, 200V, 23.0A, 3 Phase	80-gallon	780 lb.	709 lb.	\$5,085.00
ACS-23375-80HM	23.5 @ 175	7.5 HP, 230V, 20.0A, 3 Phase	80-gallon	780 lb.	709 lb.	\$5,090.00
ACS-46375-80HM	23.5 @ 175	7.5 HP, 460V, 10.0A, 3 Phase	80-gallon	780 lb.	709 lb.	\$5,085.00
ADS-23110-120HM	34.2 @ 175	10.0 HP, 230V, 39.0A, 1 Phase	120-gallon	890 lb.	811 lb.	\$7,845.00
ADS-20310-120HM	34.2 @ 175	10.0 HP, 200V, 30.8A, 3 Phase	120-gallon	890 lb.	811 lb.	\$7,615.00
ADS-23310-120HM	34.2 @ 175	10.0 HP, 230V, 26.8A, 3 Phase	120-gallon	890 lb.	811 lb.	\$7,630.00
ADS-46310-120HM	34.2 @ 175	10.0 HP, 460V, 13.4A, 3 Phase	120-gallon	890 lb.	844 lb.	\$7,625.00
AES-20315-120HM	46.5 @ 175	15.0 HP, 200V, 44.0A, 3 Phase	120-gallon	935 lb.	856 lb.	\$9,375.00
AES-23315-120HM	46.5 @ 175	15.0 HP, 230V, 38.0A, 3 Phase	120-gallon	935 lb.	856 lb.	\$9,700.00
AES-46315-120HM	46.5 @ 175	15.0 HP, 460V, 19.0A, 3 Phase	120-gallon	935 lb.	856 lb.	\$9,390.00

SIMPLEX VERTICAL MODELS						
MODEL NUMBER	CFM @ PSI	HORSEPOWER/MOTOR	TANK SIZE	SHIP WT.	NET WT.	LIST PRICE
ACS-23105-80VM	18.0 @ 175	5.0 HP, 230V, 23.0A, 1 Phase	80-gallon	695 lb.	544 lb.	\$5,100.00
ACS-20305-80VM	18.0 @ 175	5.0 HP, 200V, 16.1A, 3 Phase	80-gallon	695 lb.	544 lb.	\$4,710.00
ACS-23305-80VM	18.0 @ 175	5.0 HP, 230V, 13.8A, 3 Phase	80-gallon	695 lb.	544 lb.	\$4,705.00
ACS-46305-80VM	18.0 @ 175	5.0 HP, 460V, 6.9A, 3 Phase	80-gallon	695 lb.	544 lb.	\$4,700.00
ACS-23175-80VM	23.5 @ 175	7.5 HP, 230V, 31.0A, 1 Phase	80-gallon	780 lb.	709 lb.	\$5,515.00
ACS-20375-80VM	23.5 @ 175	7.5 HP, 200V, 23.0A, 3 Phase	80-gallon	780 lb.	709 lb.	\$5,095.00
ACS-23375-80VM	23.5 @ 175	7.5 HP, 230V, 20.0A, 3 Phase	80-gallon	780 lb.	709 lb.	\$5,100.00
ACS-46375-80VM	23.5 @ 175	7.5 HP, 460V, 10.0A, 3 Phase	80-gallon	780 lb.	709 lb.	\$5,095.00

DUPLEX HORIZONTAL MODELS						
MODEL NUMBER	CFM @ PSI	HORSEPOWER/MOTOR	TANK SIZE	SHIP WT.	NET WT.	LIST PRICE
ACD-23105-120HM	36.0 @ 175	5.0 HP, 230V, 46.0A, 1 Phase	120-gallon	950 lb.	871 lb.	\$9,300.00
ACD-20305-120HM	36.0 @ 175	5.0 HP, 200V, 32.2A, 3 Phase	120-gallon	950 lb.	871 lb.	\$9,075.00
ACD-23305-120HM	36.0 @ 175	5.0 HP, 230V, 27.6A, 3 Phase	120-gallon	950 lb.	871 lb.	\$9,075.00
ACD-46305-120HM	36.0 @ 175	5.0 HP, 460V, 13.8A, 3 Phase	120-gallon	950 lb.	871 lb.	\$9,065.00
ACD-23175-120HM	46.4 @ 175	7.5 HP, 230V, 62.0A, 1 Phase	120-gallon	1000 lb.	921 lb.	\$9,795.00
ACD-20375-120HM	46.4 @ 175	7.5 HP, 200V, 46.0A, 3 Phase	120-gallon	1000 lb.	921 lb.	\$9,285.00
ACD-23375-120HM	46.4 @ 175	7.5 HP, 230V, 40.0A, 3 Phase	120-gallon	1000 lb.	921 lb.	\$9,295.00
ACD-46375-120HM	46.4 @ 175	7.5 HP, 460V, 20.0A, 3 Phase	120-gallon	1000 lb.	921 lb.	\$9,290.00
ADD-23110-120HM	68.4 @ 175	10.0 HP, 230V, 78.0A, 1 Phase	120-gallon	1300 lb.	1221 lb.	\$13,615.00
ADD-20310-120HM	68.4 @ 175	10.0 HP, 200V, 61.6A, 3 Phase	120-gallon	1300 lb.	1221 lb.	\$12,075.00
ADD-23310-120HM	68.4 @ 175	10.0 HP, 230V, 53.6A, 3 Phase	120-gallon	1300 lb.	1221 lb.	\$12,110.00
ADD-46310-120HM	68.4 @ 175	10.0 HP, 460V, 26.8A, 3 Phase	120-gallon	1300 lb.	1221 lb.	\$12,100.00
AED-20315-120HM	93.0 @ 175	15.0 HP, 200V, 88.0A, 3 Phase	120-gallon	1650 lb.	1571 lb.	\$15,030.00
AED-23315-120HM	93.0 @ 175	15.0 HP, 230V, 76.0A, 3 Phase	120-gallon	1650 lb.	1571 lb.	\$14,910.00
AED-46315-120HM	93.0 @ 175	15.0 HP, 460V, 38.0A, 3 Phase	120-gallon	1650 lb.	1571 lb.	\$14,910.00

### Accessories:

PART NUMBER	DESCRIPTION	FITS MODELS	LIST PRICE
3-0312	Pump - Replacement pump	ACS horizontal & vertical models & ACD models	\$1,454.00
3-0313	Pump - Replacement pump	ADS & ADD models	\$2,913.00
3-0314	Pump - Replacement pump	AE & AEDS models	\$4,287.00

# Rotary Screw

## Rotary Screw Single Stage Gasoline



AR1-PK37-M

- Quality single stage compressor
- Integrated air/oil separator, thermostatic bypass valve and oil filter
- Electric start - battery and cables included
- Oil cooler with guard
- 15-inch pneumatic tires
- 3 year standard limited warranty when RotorLub™ oil, filters and parts are used at the prescribed intervals
- 3 year limited Kohler engine warranty

MODEL NUMBER	CFM @ PSI	DISPLACEMENT/ENGINE	SHIP WT.	NET WT.	LIST PRICE
AR1-PK37-M	115 @ 100	999cc Kohler CH1000 OHV	770 lb.	698 lb.	\$18,355.00

### Accessories & Options:

PART NUMBER	DESCRIPTION	FITS MODEL	LIST PRICE
19-0278	Oil filter - Spin-on/spin-off filter	AR1-PK37-M	\$70.00
19-0279	Air/oil separator - Separates the oil from the air; minimizes lubricant carry-over	AR1-PK37-M	\$330.00
AW-2200-0001	Wye ball valve assembly - Allows the user to hook up two air hoses or two air tools instead of one	AR1-PK37-M	\$281.00
AW-2200-0002	Water separator assembly - Filters water from the outlet air	AR1-PK37-M	\$972.00
AW-2200-0003	Pressure regulator assembly - Regulates the outlet air pressure from 0 to 120-PSI	AR1-PK37-M	\$313.00
AW-2200-0004	Champion RotorLub™ 8000 - Rotary screw lubricant, 5-gallon pail	AR1-PK37-M	\$813.00
AW-2200-0005	Champion RotorLub™ 8000 - Rotary screw lubricant, 1-gallon bottle	AR1-PK37-M	\$179.00
AX-0076	Skid feet - Stationary applications	AR1-PK37-M	No charge

# Gasoline Air Compressor/Generator Combinations

## 8-Gallon or Base-Mount Single/Two Stage Gasoline

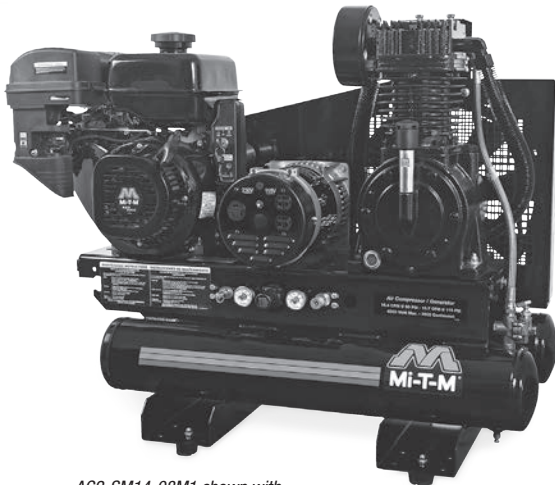

AG2-SM14-08M1 shown with electric start option, AX-0073



AG2-SH13-B shown with electric start option, AX-0019

- 8-gallon powder coated twin tank receivers (Tank-mounted models)
- Quality single or two stage compressor
- Industrial brushless alternator
- 13-inch flat-free tires (Portable two-stage models) (10-inch on AG1-PH65-08M1)
- 1 year limited Mi-T-M engine warranty
- 2 year limited alternator warranty
- 2 year limited pump exchange warranty
- 3 year limited Honda and Kohler engine warranties
- 5 year limited Subaru engine warranty

PORTABLE MODELS							
MODEL NUMBER	CFM @ PSI	DISPLACEMENT/ENGINE	MAX. OUTPUT	COMPRESSOR	SHIP WT.	NET WT.	LIST PRICE
AG1-PH65-08M1	11.9 @ 90	196cc Honda GX200 OHV	1800 watts	Single stage	257 lb.	207 lb.	\$3,010.00
AG2-PH13-08M1	15.7 @ 175*	389cc Honda GX390 OHV	4000 watts	Two stage	450 lb.	375 lb.	\$4,095.00
AG2-PK14-08M1	15.7 @ 175*	429cc Kohler CH440 OHV	4000 watts	Two stage	450 lb.	375 lb.	\$3,740.00
AG2-PM14-08M1	15.7 @ 175*	420cc Mi-T-M OHV	4000 watts	Two stage	450 lb.	375 lb.	\$3,375.00
AG2-PS14-08M1	15.7 @ 175*	404cc Subaru EX40 OHC	4000 watts	Two stage	450 lb.	375 lb.	\$3,950.00

STATIONARY MODELS							
MODEL NUMBER	CFM @ PSI	DISPLACEMENT/ENGINE	MAX. OUTPUT	COMPRESSOR	SHIP WT.	NET WT.	LIST PRICE
AG2-SH13-08M1	15.7 @ 175*	389cc Honda GX390 OHV	4000 watts	Two stage	465 lb.	365 lb.	\$3,820.00
AG2-SK14-08M1	15.7 @ 175*	429cc Kohler CH440 OHV	4000 watts	Two stage	465 lb.	365 lb.	\$3,615.00
AG2-SM14-08M1	15.7 @ 175*	420cc Mi-T-M OHV	4000 watts	Two stage	465 lb.	365 lb.	\$3,240.00
AG2-SS14-08M1	15.7 @ 175*	404cc Subaru EX40 OHC	4000 watts	Two stage	465 lb.	365 lb.	\$3,740.00

BASE-MOUNTED MODELS							
MODEL NUMBER	CFM @ PSI	DISPLACEMENT/ENGINE	MAX. OUTPUT	COMPRESSOR	SHIP WT.	NET WT.	LIST PRICE
AG2-SH13-B	15.7 @ 175*	389cc Honda GX390 OHV	4000 watts	Two stage	390 lb.	325 lb.	\$3,775.00
AG2-SK14-B	15.7 @ 175*	429cc Kohler CH440 OHV	4000 watts	Two stage	390 lb.	325 lb.	\$3,490.00
AG2-SM14-B	15.7 @ 175*	420cc Mi-T-M OHV	4000 watts	Two stage	390 lb.	325 lb.	\$3,185.00
AG2-SS14-B	15.7 @ 175*	404cc Subaru EX40 OHC	4000 watts	Two stage	390 lb.	325 lb.	\$3,680.00

\*Equipped with 150-PSI maximum rated regulator.

### Accessories & Options:

PART NUMBER	DESCRIPTION	FITS MODELS	LIST PRICE
70-0357	Engine oil drain extension - 14-inch flexible drain hose makes oil changes clean and easy	AG1-PH65-08M1	\$43.00
70-0358	Engine oil drain extension - 14-inch flexible drain hose makes oil changes clean and easy	Two stage Honda, Kohler & Mi-T-M models	\$45.00
70-0380	Engine oil drain extension - 14-inch flexible drain hose makes oil changes clean and easy	Subaru models	\$46.00
854-0093	Service truck mount kit (recommended for models that are mounted in service truck applications) - Includes four rubber isolators to reduce wear	Two stage portable & stationary models	\$113.00
AW-6000-1002	Equipment cover - Keeps your equipment clean, dry and looking like new	All models	\$187.00
AX-0019	Electric start - battery, box and cables not included - For easy starting	Two stage Honda models	\$748.00
AX-0028	Lifting hook - For easier portability	Two stage portable & stationary models	\$52.00
AX-0062	Electric start - battery, box and cables not included - For easy starting	Subaru models	\$573.00
AX-0063	Lifting hook - For easier portability	Base-mount models	\$91.00
AX-0064*	Electric start - battery box and cables included, battery not included - For easy starting	Two stage Honda models	\$815.00
AX-0065*	Electric start - battery box and cables included, battery not included - For easy starting	Subaru models	\$635.00
AX-0068	Idle down - When activated it automatically throttles down engine to conserve fuel, includes electric start - battery not included	Two stage Honda models	\$1,454.00
AX-0069	Idle down - See AX-0068 for description	Subaru models	\$1,372.00
AX-0071	Electric start - battery, box and cables not included - For easy starting	Kohler models	\$305.00
AX-0072*	Electric start - battery box and cables included, battery not included - For easy starting	Kohler models	\$361.00
AX-0073	Electric start - battery, box and cables not included - For easy starting	Mi-T-M engine models	\$191.00
AX-0074*	Electric start - battery box and cables included, battery not included - For easy starting	Mi-T-M engine models	\$269.00
AX-0075	Idle down - See AX-0068 for description	Mi-T-M engine models	\$1,160.00
IX-0055	Remote start/choke - 6-ft. wire extension for key switch; you will also need to order electric start option, AX-0019 or idle down option, AX-0068	Two stage Honda models	\$382.00

\*Battery box cannot be mounted at the factory but can be shipped with the unit for custom mounting. Consult factory for more information.

# Gasoline Air Compressor/Generator Combinations

## 30-Gallon Two Stage Gasoline

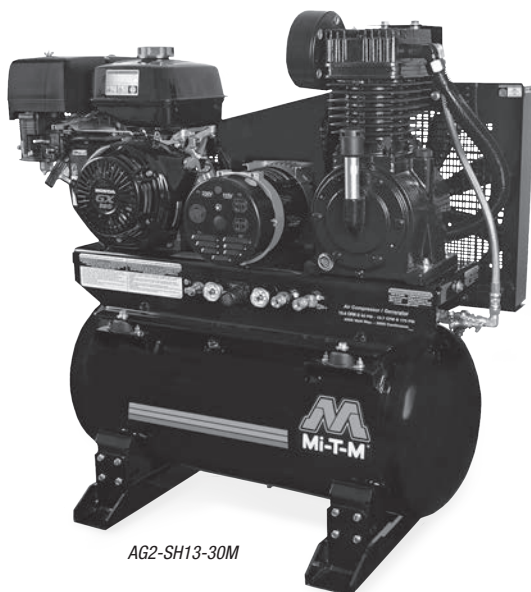

AG2-SH13-30M

- Powder coated ASME coded 30-gallon receiver tank
- Quality two stage compressor
- Industrial brushless alternator
- 1 year limited Mi-T-M engine warranty
- 2 year limited alternator warranty
- 2 year limited pump exchange warranty
- 3 year limited Honda and Kohler engine warranties
- 5 year limited Subaru engine warranty

MODEL NUMBER	CFM @ PSI	DISPLACEMENT/ENGINE	MAX. OUTPUT	COMPRESSOR	SHIP WT.	NET WT.	LIST PRICE
AG2-SH13-30M	15.7 @ 175*	389cc Honda GX390 OHV	4000 watts	Two stage	550 lb.	450 lb.	\$4,345.00
AG2-SK14-30M	15.7 @ 175*	429cc Kohler CH440 OHV	4000 watts	Two stage	550 lb.	450 lb.	\$3,930.00
AG2-SM14-30M	15.7 @ 175*	420cc Mi-T-M OHV	4000 watts	Two stage	550 lb.	450 lb.	\$3,715.00
AG2-SR14-30M	15.7 @ 175*	404cc Subaru EX40 OHC	4000 watts	Two stage	550 lb.	450 lb.	\$4,400.00

\*Equipped with 150-PSI maximum rated regulator.

### Accessories & Options:

PART NUMBER	DESCRIPTION	FITS MODELS	LIST PRICE
70-0358	Engine oil drain extension - 14-inch flexible drain hose makes oil changes clean and easy	Honda, Kohler & Mi-T-M models	\$45.00
70-0380	Engine oil drain extension - 14-inch flexible drain hose makes oil changes clean and easy	AG2-SR14-30M	\$46.00
AW-6000-1002	Equipment cover - Keeps your equipment clean, dry and looking like new	All models	\$187.00
AX-0019	Electric start - battery, box and cables not included - For easy starting	AG2-SH13-30M	\$748.00
AX-0062	Electric start - battery, box and cables not included - For easy starting	AG2-SR14-30M	\$573.00
AX-0063	Lifting hook - For easier portability	All models	\$91.00
AX-0064	Electric start - battery box and cables included, battery not included - For easy starting	AG2-SH13-30M	\$815.00
AX-0065	Electric start - battery box and cables included, battery not included - For easy starting	AG2-SR14-30M	\$635.00
AX-0068	Idle down - When activated it automatically throttles down engine to conserve fuel, includes electric start - battery not included	AG2-SH13-30M	\$1,454.00
AX-0069	Idle down - When activated it automatically throttles down engine to conserve fuel, includes electric start - battery not included	AG2-SR14-30M	\$1,372.00
AX-0070	Battery tray, box and 2-ft. of cables - Attaches to engine side of unit	All models	\$98.00
AX-0071	Electric start - battery, box and cables not included - For easy starting	AG2-SK14-30M	\$305.00
AX-0072	Electric start - battery box and cables included, battery not included - For easy starting	AG2-SK14-30M	\$361.00
AX-0073	Electric start - battery, box and cables not included - For easy starting	AG2-SM14-30M	\$191.00
AX-0074	Electric start - battery box and cables included, battery not included - For easy starting	AG2-SM14-30M	\$269.00
AX-0075	Idle down - When activated it automatically throttles down engine to conserve fuel, includes electric start - battery not included	AG2-SM14-30M	\$1,160.00
IX-0001	Vibration isolator pads - Isolators protect the unit from vibration during use; Recommended for models that are mounted in service truck applications	All models	\$160.00
IX-0055	Remote start/choke - 6-ft. wire extension for key switch; you will also need to order electric start option, AX-0019 or idle down option, AX-0068	AG2-SH13-30M	\$382.00

# Diesel Air Compressor/Generator Combinations

Air Compressor/  
Generator  
Combinations

## 30-Gallon Two Stage Diesel

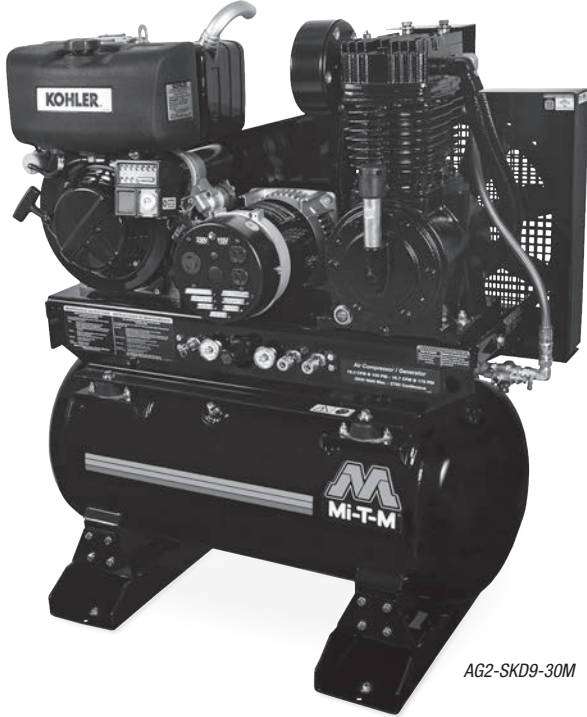

AG2-SKD9-30M

MODEL NUMBER	CFM @ PSI	HORSEPOWER/ENGINE	MAX. OUTPUT	COMPRESSOR	SHIP WT.	NET WT.	LIST PRICE
AG2-SKD9-30M	29.0 @ 175*	9.1 HP Kohler KD440 OHV	3000 watts	Two stage	554 lb.	489 lb.	\$7,735.00

\*Equipped with 150-PSI maximum rated regulator.

### Accessories & Options:

PART NUMBER	DESCRIPTION	FITS MODEL	LIST PRICE
70-0380	Engine oil drain extension - 14-inch flexible drain hose makes oil changes clean and easy	AG2-SKD9-30M	\$46.00
AW-6000-1002	Equipment cover - Keeps your equipment clean, dry and looking like new	AG2-SKD9-30M	\$187.00
IX-0001	Vibration isolator pads - Isolators protect the unit from vibration during use; Recommended for models that are mounted in service truck applications	AG2-SKD9-30M	\$160.00

- Powder coated ASME coded 30-gallon receiver tank
- Quality two stage compressor
- Industrial brushless alternator
- Glow plug equipped engine for easy starting in cold temperatures
- 2 year limited alternator warranty
- 2 year limited pump exchange warranty
- 3 year limited Kohler engine warranty

# AGW Series

## 20 & 30-Gallon or Base-Mount Two Stage Gasoline



UM  
20 & 30-Gallon  
Models

- Powder coated ASME coded 20 or 30-gallon receiver tank (Tank-mounted models)
- Quality two stage compressor
- Industrial 5000-watt generator
- Brush-type 2 pole 120V/240V alternator
- Amperage selection switch, 170A or 220A maximum
- 2 year limited alternator warranty
- 2 year limited pump exchange warranty
- 3 year limited Honda engine warranty
- 5 year limited Subaru engine warranty



AGW-SH22-20M

MODEL NUMBER	CFM @ PSI	DISPLACEMENT/ENGINE	MAX. OUTPUT	DC VOLTAGE	SHIP WT.	NET WT.	LIST PRICE
AGW-SH22-20M	29.0 @ 175*	688cc Honda GX690 OHV, electric start - battery cables included; battery not included	5000 watts	50-220A	870 lb.	803 lb.	\$14,230.00
AGW-SR14-30M	15.7 @ 175*	404cc Subaru EX40 OHC, electric start - battery cables and battery not included	5000 watts	50-170A	650 lb.	585 lb.	\$8,630.00
AGW-SR14-B	15.7 @ 175*	404cc Subaru EX40 OHC, electric start - battery cables and battery not included	5000 watts	50-170A	449 lb.	384 lb.	\$7,915.00

\*Equipped with 150-PSI maximum rated regulator.

### Accessories & Options:

PART NUMBER	DESCRIPTION	FITS MODELS	LIST PRICE
70-0380	Engine oil drain extension - 14-inch flexible drain hose makes oil changes clean and easy	Subaru models	\$46.00
AW-6000-1002	Equipment cover - Keeps your equipment clean, dry and looking like new	Subaru models	\$187.00
AW-6000-1003	Equipment cover - Keeps your equipment clean, dry and looking like new	AGW-SH22-20M	\$227.00
AX-0070	Battery tray, box and 2-ft. of cables - Attaches to engine side of unit	Subaru models	\$98.00
IX-0001	Vibration isolator pads - Isolators protect the unit from vibration during use; Recommended for models that are mounted in service truck applications	AGW-SH22-20M & AGW-SR14-30M	\$160.00

## Plugs & Couplers

– Add the ability to easily connect and disconnect your air tools and air hoses with plugs, couplers and plug/coupler sets



PART NUMBER	DESCRIPTION	LIST PRICE
17-0049	Industrial Interchange Style - 1/4-inch MPT - 1/4-inch plug	\$1.95
17-0043	Industrial Interchange Style - 1/4-inch MPT - 1/4-inch coupler	\$7.65
17-0053	Industrial Interchange Style - 1/4-inch FPT - 1/4-inch plug	\$1.95
17-0045	Industrial Interchange Style - 1/4-inch FPT - 1/4-inch coupler	\$7.65
17-0061	Industrial Interchange Style - 3/8-inch MPT - 3/8-inch plug	\$3.90
17-0059	Industrial Interchange Style - 3/8-inch MPT - 3/8-inch coupler	\$22.35
17-0062	Industrial Interchange Style - 3/8-inch FPT - 3/8-inch plug	\$4.80
17-0060	Industrial Interchange Style - 3/8-inch FPT - 3/8-inch coupler	\$21.60
17-0067	Industrial Interchange Style - 3/8-inch FPT - 1/4-inch coupler	\$11.40
17-0068	Industrial Interchange Style - 3/8-inch MPT - 1/4-inch coupler	\$10.20
17-0050	Automotive Style - 1/4-inch MPT - 1/4-inch plug	\$2.10
17-0044	Automotive Style - 1/4-inch MPT - 1/4-inch coupler	\$6.15
17-0054	Automotive Style - 1/4-inch FPT - 1/4-inch plug	\$2.70
17-0046	Automotive Style - 1/4-inch FPT - 1/4-inch coupler	\$11.40
17-0051	Lincoln Style - 1/4-inch MPT - 1/4-inch plug	\$2.70
17-0055	Lincoln Style - 1/4-inch FPT - 1/4-inch plug	\$3.75
17-0047	Lincoln Style - 1/4-inch FPT - 1/4-inch coupler	\$10.65
17-0052	ARO Style - 1/4-inch MPT - 1/4-inch plug	\$2.25
17-0056	ARO Style - 1/4-inch FPT - 1/4-inch plug	\$2.70
17-0048	ARO Style - 1/4-inch FPT - 1/4-inch coupler	\$7.95
23-0017	Reducer - 3/8-inch to 1/4-inch	\$2.25
AW-0017-0045K	Coupler/Plug Set - 1/4-inch FPT - 1/4-inch Industrial Interchange Style coupler; 1/4-inch MPT - 1/4-inch Industrial Interchange Style plug	\$14.20
AW-0017-0046K	Coupler/Plug Set - 1/4-inch FPT - 1/4-inch Automotive Style coupler; 1/4-inch MPT - 1/4-inch Automotive Style plug	\$18.20

## Coupler Test Bar

– Includes four 1/4-inch plugs: Tru-flate Automotive Style, Industrial Interchange Style, ARO Style and Lincoln Style



PART NUMBER	DESCRIPTION	LIST PRICE
17-4952	Coupler test bar	\$34.05

## Brass Fittings

### Barbed Hose Fittings

– Corrosion-resistant brass construction  
– Threaded end connects tools, fittings, couplers or plugs

### Brass Couplings

– Corrosion-resistant brass construction  
– Use to combine two short hoses into one long hose

### Barbed Hose Splicers

– Corrosion-resistant brass construction  
– Repair damaged hoses by combining hose sections together



PART NUMBER	DESCRIPTION	LIST PRICE
23-0050	Barbed hose fitting - 3/8-inch MNPT x 1/2-inch hose ID	\$9.30
23-0051	Barbed hose fitting - 1/4-inch MNPT x 1/4-inch hose ID	\$3.15
23-0052	Barbed hose fitting - 3/8-inch MNPT x 1/4-inch hose ID	\$3.15
23-0069	Barbed hose fitting - 1/4-inch MNPT x 3/8-inch hose ID	\$2.40
23-0073	Barbed hose fitting - 3/8-inch MNPT x 3/8-inch hose ID	\$4.20
23-0002	Brass coupling - 1/4-inch FNPT x 1/4-inch FNPT	\$5.40
23-0103	Brass coupling - 1/4-inch MNPT x 1/4-inch MNPT	\$4.20
23-0415	Barbed hose splicer - Fits 1/4-inch hose ID	\$5.25
23-0416	Barbed hose splicer - Fits 3/8-inch hose ID	\$5.25

## Steel Hex Nipples

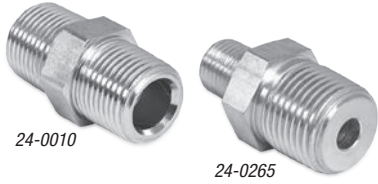

– Corrosion-resistant steel construction

PART NUMBER	DESCRIPTION	LIST PRICE
24-0010	3/8-inch x 3/8-inch	\$3.75
24-0024	1/2-inch x 3/8-inch	\$6.30
24-0031	1/2-inch x 1/2-inch	\$4.20
24-0145	1/4-inch x 1/4-inch	\$4.20
24-0146	3/8-inch x 1/4-inch	\$3.15
24-0265	1/2-inch x 1/4-inch	\$5.25

## Air Chucks



– Helps maintain proper tire pressure

PART NUMBER	DESCRIPTION	LIST PRICE
AT-3001	Dual foot - 1/4-inch FPT	\$26.00
AT-3002	Ball foot - 1/4-inch FPT	\$6.00
AT-3003	Deluxe air inflator - 12-inch hose, 12 to 120-PSI	\$72.00

## Air Hoses



– 3/8-inch NPT fittings  
 – Bend restrictors

PART NUMBER	DESCRIPTION	LIST PRICE
15-0230	PVC hose - 50-foot x 3/8-inch	\$44.00
15-0231	PVC hose - 25-foot x 3/8-inch	\$37.00
854-0085	PVC hose - 50-foot x 3/8-inch with quick connects	\$55.00
15-0328	Hybrid polymer hose - 50-foot x 3/8-inch, 1/4 MPT	\$103.00
15-0327	Hybrid polymer hose - 25-foot x 3/8-inch, 1/4 MPT	\$59.00

## Leader Hose



– 360° swivel fitting  
 – Flexible hose

PART NUMBER	DESCRIPTION	LIST PRICE
15-0229	Leader hose - 24-inch with swivel	\$20.00

## Engine Oil Drain Extensions



– 14-inch flexible drain hose makes oil changes clean and easy

PART NUMBER	DESCRIPTION	LIST PRICE
70-0357	Fits 118cc Honda GX120 OHV and 196cc Honda GX200 OHV engines; 136cc and 212cc Mi-T-M OHV engines; and 208cc Kohler CH270 OHV engines	\$43.00
70-0358	Fits 270cc Honda GX270 OHV and 389cc Honda GX390 OHV engines; 420cc Mi-T-M engines; and 429cc Kohler CH440 OHV engines	\$45.00
70-0380	Fits 404cc Subaru EX40 OHC engines; 300cc Mi-T-M OHV engines; and 9.1 HP Kohler KD440 OHV engines	\$46.00

## Electric Compressor Drain



– Automatically drains filters, compressor tanks, drip legs, aftercoolers and receivers  
 – 1/4-inch NPT coupler  
 – For electric air compressors when 110V of power is available

PART NUMBER	DESCRIPTION	LIST PRICE
AT-4012	1/4-inch automatic compressor drain	\$319.65



# Blow Guns, Air Filters & Gauges

## Air/Liquid Adapter Kit



– For filling tires with liquid

PART NUMBER	DESCRIPTION	LIST PRICE
23-0414	Air/liquid adapter kit	\$26.85

## Blow Guns

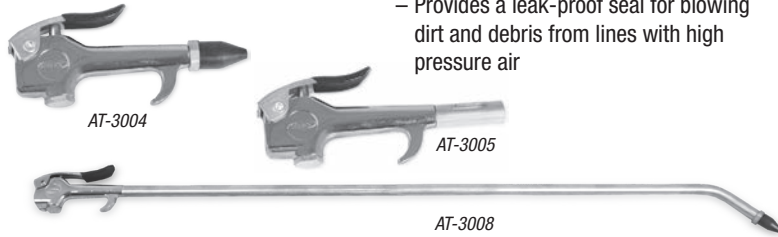

– Provides a leak-proof seal for blowing dirt and debris from lines with high pressure air

PART NUMBER	DESCRIPTION	LIST PRICE
AT-3004	Blow gun - Standard rubber tip	\$18.60
AT-3005	Blow gun - Safety tip	\$18.60
AT-3007	AT-3004 with 1-foot extension	\$39.30
AT-3008	AT-3004 with 2-foot extension	\$44.40
AT-3009	AT-3004 with 4-foot extension	\$53.70

## Air Filter Canisters



– Houses air filter elements

PART NUMBER	DESCRIPTION	LIST PRICE
19-0215	Plastic filter canister - 2½-inch diameter x ¾-inch M	\$10.00
19-0217	Metal filter canister - 2½-inch diameter x ¾-inch M	\$17.55
19-0083	Metal filter canister - 3¼-inch diameter x ½-inch M	\$25.00
19-0240	Metal filter canister - 4½-inch diameter x ½-inch M	\$45.00
19-0219	Metal filter canister - 4½-inch diameter x 1-inch M	\$28.80
19-0225	Metal filter canister - 6-inch diameter x ¾-inch M	\$27.60

## Replacement Air Filter Elements

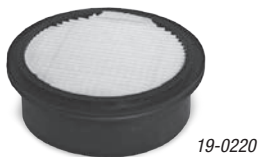

– Paper air filter replacement elements

PART NUMBER	DESCRIPTION	LIST PRICE
19-0218	For 19-0217 - 2½-inch diameter x ¾-inch M	\$12.60
19-0082	For 19-0083 - 3¼-inch diameter x ½-inch M	\$12.90
19-0220	For 19-0219 & 19-0240 - 4½-inch diameter x 1-inch M	\$14.85
19-0226	For 19-0225 - 6-inch diameter x ¾-inch M	\$10.35

## Gauges



– ½-inch MPT

PART NUMBER	DESCRIPTION	LIST PRICE
22-0257	200-PSI maximum rating	\$21.00
22-0271	300-PSI maximum rating	\$25.00
22-0446	250-PSI maximum rating	\$8.00

# Filters, Regulators, Lubricators & Pumps

## Filters



– Removes dirt, debris and water from air line

PART NUMBER	DESCRIPTION	LIST PRICE
AT-4004-M	1/4-inch poly bowl - 150-psig max. supply pressure	\$59.85
AT-4005-M	1/2-inch metal bowl - 250-psig max. supply pressure	\$71.25
AT-4006-M	3/8-inch poly bowl - 150-psig max. supply pressure	\$59.85
AT-4007-M	Disposable in-line filter - 1/4-inch MPT x 1/4-inch FPT	\$16.50
AT-4008-M	Air tool filter - 1/4-inch MPT x 1/4-inch FPT	\$8.25

## Regulators



**1/4-inch Regulator**  
 – 1/8-inch gauge port

**3/8-inch Regulator**  
 – 1/8-inch gauge port

**1/2-inch Regulator**  
 – 1/4-inch gauge port

PART NUMBER	DESCRIPTION	LIST PRICE
22-0326	1/4-inch regulator	\$27.45
22-0231	3/8-inch regulator	\$73.20
22-0358	1/2-inch regulator	\$259.80

## Filter/Regulator



– Removes dirt, debris and water from air line

PART NUMBER	DESCRIPTION	LIST PRICE
AT-4011-M	3/8-inch filter/regulator	\$116.55

## In-Line Lubricators



– Used to lubricate air tools

PART NUMBER	DESCRIPTION	LIST PRICE
AT-4009-M	1/4-inch poly bowl with bowl guard	\$82.50
AT-4010-M	3/8-inch poly bowl with bowl guard	\$82.50

## Replacement Pumps

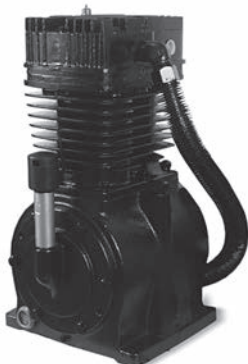

ALUMINUM		
PART NUMBER	DESCRIPTION	LIST PRICE
3-0425	Single stage - Fits single stage electric and gasoline Work Pro® Series models	\$362.00
3-0427	Two stage - Fits two stage gasoline Work Pro® Series models	\$1,010.00

CAST IRON WITH CAST IRON HEAD		
PART NUMBER	DESCRIPTION	LIST PRICE
3-0303	Single stage - Fits AM1-PH65-08M and AM1-PK07-08M models	\$566.00
3-0315	Single stage - Fits models up to 2.0 HP electric	\$492.00
3-0298	Two stage - Fits 270cc gasoline or 9.1 HP Kohler KD440 diesel models	\$1,194.00
3-0304	Two stage - Fits gasoline models 389cc up to 429cc	\$1,415.00
3-0312	Two stage - Fits ACS & ACD Series	\$1,454.00
3-0313	Two stage - Fits ADS & ADD Series	\$2,913.00
3-0314	Two stage - Fits AES & AED Series	\$4,287.00

# Building an Efficient Air System

## Building an Efficient Air System

Compressed-air-powered equipment and machinery are critical elements in the productivity, efficiency and economy of today's industry. Quality air is the essential element for effective operation of this equipment. Water and dirt can cause major problems in compressed air lines. The use of filters that remove moisture and impurities from the air help high-speed pneumatic production lines operate more efficiently. Regulators and lubricators may also be added to control and lubricate downstream equipment. A quality air system can save time, money and keep equipment operating at maximum efficiency.

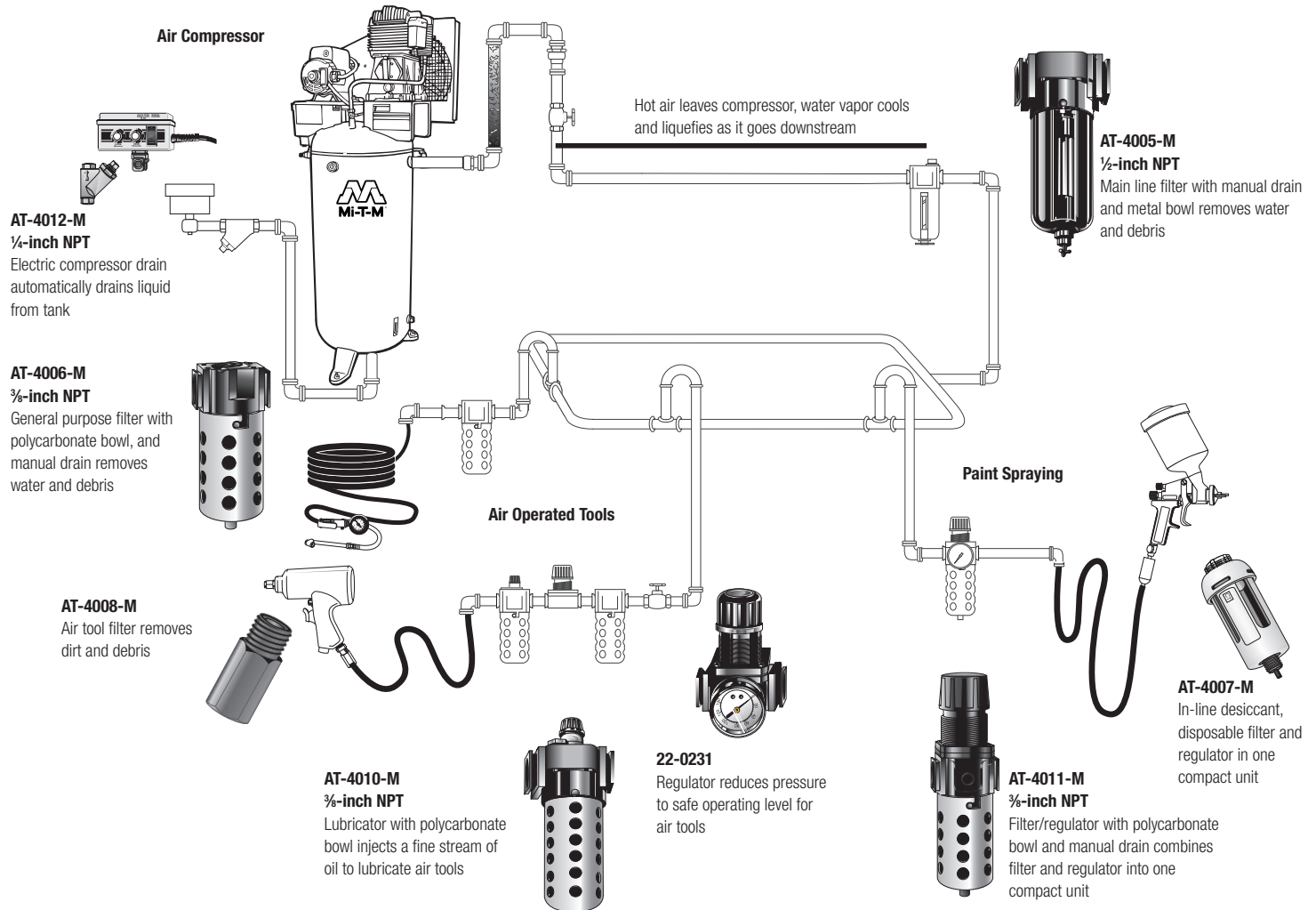

# Inverter Portable Generators

## Inverters

### 2000 & 3000-Watt Gasoline



CSA  
CERTIFIED



GEN-3000-IMMO and GEN-2000-IMMO shown with parallel port box accessory, AW-5100-0002

- Inverter technology reduces size, weight, noise and fuel consumption
- Inverter technology produces commercial quality AC power for sensitive electronic equipment
- Recoil start
- DC/battery charging
- Insulated side panels reduce noise
- USB port for electronics
- 1 year limited alternator warranty
- 1 year limited Mi-T-M engine warranty

MODEL NUMBER	MAX. OUTPUT	DISPLACEMENT/ENGINE	SHIP WT.	NET WT.	LIST PRICE
GEN-2000-IMMO	2000 watts	79cc Mi-T-M OHV	53 lb.	48 lb.	\$1,240.00
GEN-3000-IMMO	3000 watts	212cc Mi-T-M OHV	90 lb.	84 lb.	\$1,705.00

#### Accessories:

PART NUMBER	DESCRIPTION	FITS MODELS	LIST PRICE
AW-5100-0001	<b>Parallel port box</b> - The AW-5100-0001 can be used on either inverter model or combination of both inverters. Includes a 30A, 120V outlet and a 20A, 120V duplex receptacle. The largest appliance that can be run is 3600 watts - even with (2) GEN-3000-IMMO inverters. It is limited by the 30A outlet.	All models	\$180.00
AW-5100-0002	<b>Parallel port box</b> - The AW-5100-0002 can be used on either inverter model or combination of both inverters. Includes a 50A, 120V outlet and a 20A, 120V duplex receptacle. The largest appliance that can be run is 5600 watts - limited by the combined ratings of the machines connected.	All models	\$195.00

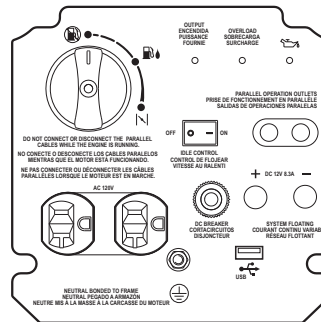

#### GEN-2000-IMMO Includes:

- Idle control
- 12V DC charger
- (1) 120V - 20A receptacle
- (1) 8.3A DC breaker
- USB port
- Ground
- Output light
- Overload light
- Oil warning light
- Throttle
- Parallel connection
- 3-in-1 switch knob

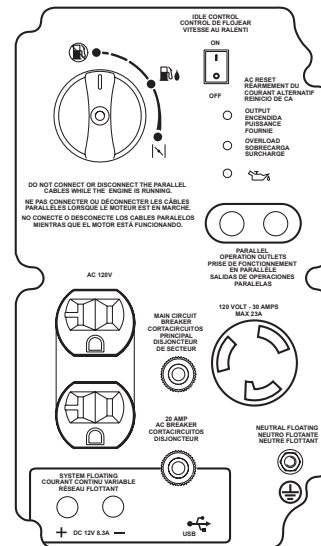

#### GEN-3000-IMMO Includes:

- Idle control
- 12V DC charger
- (1) 120V - 20A receptacle
- (1) 8.3A DC breaker
- USB port
- Ground
- Output light
- Overload light
- Oil warning light
- Parallel connection
- 3-in-1 switch knob

# ChoreMaster® Series Portable Generators

Portable Generators

## ChoreMaster® Series 3600, 6000 & 8000-Watt Gasoline



GEN-3600-OMMO

- DC/battery charging
- Engine on/off switch
- Wheel kit with tires and handles on GEN-6000 and GEN-8000 models
- 1 year limited alternator warranty
- 1 year limited Mi-T-M engine warranty

MODEL NUMBER	MAX. OUTPUT	DISPLACEMENT/ENGINE	SHIP WT.	NET WT.	LIST PRICE
GEN-3600-OMMO	3600 watts	212cc Mi-T-M OHV	134 lb.	102 lb.	<b>\$850.00</b>
GEN-6000-OMMO	6000 watts	389cc Mi-T-M OHV	228 lb.	180 lb.	<b>\$1,355.00</b>
GEN-8000-OMME	8000 watts	420cc Mi-T-M OHV, electric start - battery included	237 lb.	195 lb.	<b>\$1,690.00</b>

### Accessories:

PART NUMBER	DESCRIPTION	FITS MODELS	LIST PRICE
32-0915	RV generator adapter - 30A/125V female/male; use to connect RV cordsets to 30A generators	All models	<b>\$127.00</b>
AW-5090-0009	Lifting hook - For easier portability, folds down and out of the way when not in use	GEN-3600-OMMO	<b>\$85.00</b>
AW-6000-1002	Equipment cover - Keeps your equipment clean, dry and looking like new	6000 & 8000-watt models	<b>\$187.00</b>

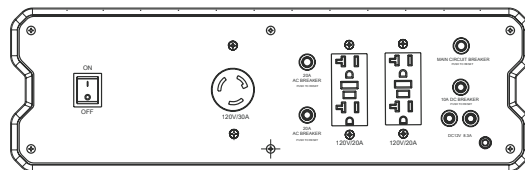

#### GEN-3600-OMMO Includes:

- Engine on/off switch
- 12V DC charger
- (1) Main circuit breaker
- (2) 120V - 20A receptacles
- (1) 120V - 30A receptacle
- (2) 20A circuit breakers
- (1) 10A DC breaker

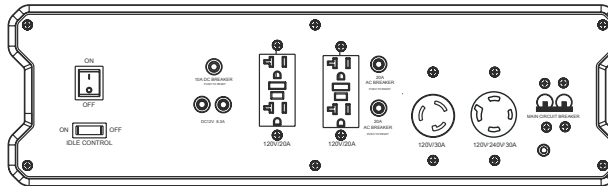

#### GEN-6000-OMMO Includes:

- Engine on/off switch
- Idle control
- 12V DC charger
- (1) Main circuit breaker
- (2) 120V - 20A receptacles
- (1) 120V/240V - 30A receptacle
- (1) 120V - 30A receptacle
- (2) 20A circuit breakers
- (1) 10A DC breaker

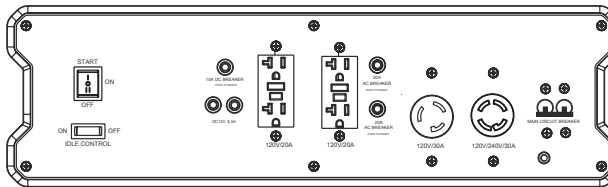

#### GEN-8000-OMME Includes:

- Engine on/off switch
- Idle control
- 12V DC charger
- (1) Main circuit breaker
- (2) 120V - 20A receptacles
- (1) 120V - 30A receptacle
- (1) 120V/240V - 30A receptacle
- (2) 20A circuit breakers
- (1) 10A DC breaker

# Gasoline Portable Generators

## 3000 & 5000-Watt Gasoline



GEN-5000-0MHO

- Large low tone mufflers to reduce noise
- USDA/USFS-approved spark arrestors
- GEN-3000-1MH0 has a large fuel tank capacity for extended run times
- 2 year limited alternator warranty
- 3 year limited Honda and Kohler engine warranties

MODEL NUMBER	MAX. OUTPUT	DISPLACEMENT/ENGINE	SHIP WT.	NET WT.	LIST PRICE
GEN-3000-1MH0	3000 watts	163cc Honda GX160 OHV	146 lb.	130 lb.	\$1,960.00
GEN-3000-1MK0	3000 watts	208cc Kohler CH270 OHV	146 lb.	130 lb.	\$1,690.00
GEN-5000-0MHO	5000 watts	270cc Honda GX270 OHV	198 lb.	176 lb.	\$2,880.00
GEN-5000-0MK0	5000 watts	277cc Kohler CH395 OHV	198 lb.	176 lb.	\$2,475.00

### Accessories & Options:

PART NUMBER	DESCRIPTION	FITS MODELS	LIST PRICE
32-0915	RV generator adapter - 30A/125V female/male; use to connect RV cordsets to 30A generators	5000-watt models	\$127.00
AW-5090-0003	Lifting hook - For easier portability, folds down and out of the way when not in use	5000-watt models	\$85.00
AW-5740-0009	Wheel kit - For easier mobility, two flat-free tires and rubber gripped handles	5000-watt models	\$221.00
GX-0004	Hour meter - Displays number of hours the unit has been in operation	5000-watt models	\$49.00

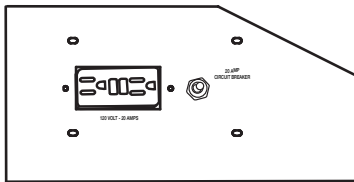

**GEN-3000 Includes:**  
 - (1) 120V - 20A receptacle  
 - (1) 20A circuit breaker

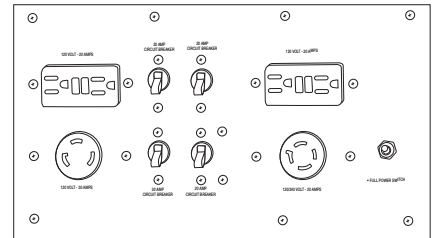

**GEN-5000 Includes:**  
 - Full power switch  
 - (2) 120V - 20A receptacles  
 - (1) 120V/240V - 20A receptacle  
 - (1) 120V - 30A receptacle  
 - (3) 20A circuit breakers  
 - (1) 30A circuit breaker

## 6000, 7500 & 8000-Watt Gasoline

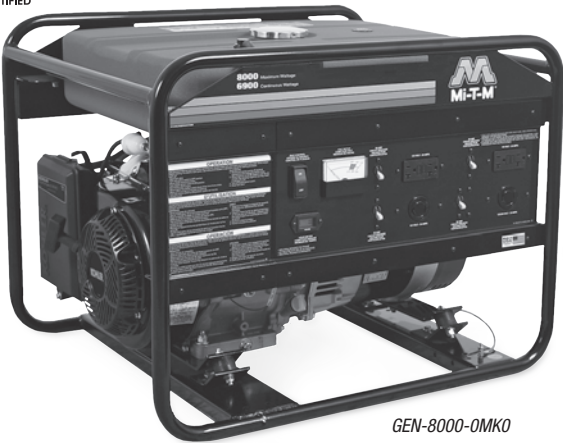

GEN-8000-0MK0

- Large low tone mufflers to reduce noise
- USDA/USFS-approved spark arrestors
- Voltmeter/hour meter
- 2 year limited alternator warranty
- 3 year limited Honda and Kohler engine warranties

MODEL NUMBER	MAX. OUTPUT	DISPLACEMENT/ENGINE	SHIP WT.	NET WT.	LIST PRICE
GEN-6000-0MHO	6000 watts	389cc Honda GX390 OHV	232 lb.	210 lb.	\$3,465.00
GEN-6000-0MHE	6000 watts	389cc Honda GX390 OHV, electric start - battery included	240 lb.	218 lb.	\$3,930.00
GEN-6000-0MK0	6000 watts	429cc Kohler CH440 OHV	232 lb.	210 lb.	\$3,000.00
GEN-7500-0MHO	7500 watts	389cc Honda GX390 OHV	255 lb.	233 lb.	\$3,590.00
GEN-7500-0MHE	7500 watts	389cc Honda GX390 OHV, electric start - battery included	263 lb.	241 lb.	\$4,045.00
GEN-8000-0MK0	8000 watts	429cc Kohler CH440 OHV	255 lb.	223 lb.	\$3,200.00
GEN-8000-0MKE	8000 watts	429cc Kohler CH440 OHV, electric start - battery included	253 lb.	231 lb.	\$3,325.00

### Accessories:

PART NUMBER	DESCRIPTION	FITS MODELS	LIST PRICE
32-0915	RV generator adapter - 30A/125V female/male; use to connect RV cordsets to 30A generators	All models	\$127.00
AW-5090-0004	Lifting hook - For easier portability, folds down and out of the way when not in use	All models	\$87.00
AW-5740-0010	Wheel kit - For easier mobility, two flat-free tires and rubber gripped handles	All models	\$221.00
AW-6000-1002	Equipment cover - Keeps your equipment clean, dry and looking like new	All models	\$187.00

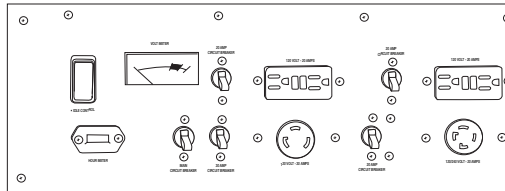

**GEN-6000 Includes:**  
 - Idle control  
 - Hour meter  
 - Voltmeter  
 - (1) Main circuit breaker  
 - (2) 120V - 20A receptacles  
 - (1) 120V - 30A receptacle  
 - (1) 120V/240V - 20A receptacle  
 - (3) 20A circuit breakers  
 - (1) 30A circuit breaker

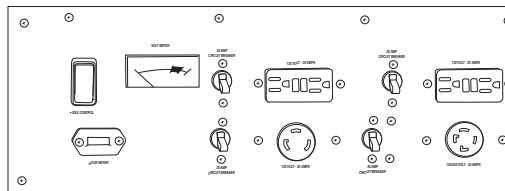

**GEN-7500 & GEN-8000 Includes:**  
 - Idle control  
 - Hour meter  
 - Voltmeter  
 - (2) 120V - 20A receptacles  
 - (1) 120V - 30A receptacle  
 - (1) 120V/240V - 30A receptacle  
 - (2) 20A circuit breakers  
 - (2) 30A circuit breakers

# Gasoline/Diesel Portable Generators

## 14000-Watt Gasoline



GEN-14000-1MHE

- Large low tone mufflers to reduce noise
- USDA/USFS-approved spark arrestors
- Reinforced 1¼-inch powder coated steel tube frame
- 13-inch flat-free tires
- 2 year limited alternator warranty
- 3 year limited Honda engine warranty

MODEL NUMBER	MAX. OUTPUT	DISPLACEMENT/ENGINE	SHIP WT.	NET WT.	LIST PRICE
GEN-14000-1MHE	14000 watts	688cc Honda GX630 OHV, electric start - battery included	568 lb.	508 lb.	\$7,640.00

### Accessories & Options:

PART NUMBER	DESCRIPTION	FITS MODEL	LIST PRICE
32-0915	RV generator adapter - 30A/125V female/male; use to connect RV cordsets to 30A generators	GEN-14000-1MHE	\$127.00
AW-6000-1002	Equipment cover - Keeps your equipment clean, dry and looking like new	GEN-14000-1MHE	\$187.00
GX-0003	Skid feet - For stationary applications	GEN-14000-1MHE	\$70.00
GX-0005	50-amp twist lock receptacle - Marine receptacle for routine marine applications	GEN-14000-1MHE	\$212.00

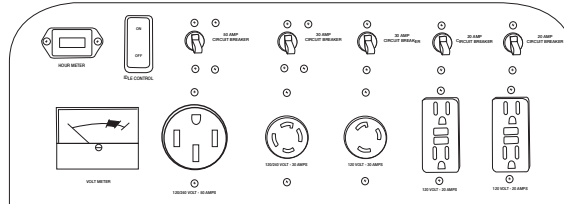

### GEN-14000 Includes:

- Idle control
- Hour meter
- Voltmeter
- (2) 120V - 20A receptacles
- (1) 120V - 30A receptacle
- (1) 120V/240V - 30A receptacle
- (1) 120V/240V - 50A receptacle
- (2) 20A circuit breakers
- (2) 30A circuit breakers
- (1) 50A circuit breaker

## 6000-Watt Diesel



GEN-6000-0MKD

- Large low tone mufflers to reduce noise
- Heavy-duty industrial air cleaners
- Voltmeter/hour meter
- 2 year limited alternator warranty
- 3 year limited Kohler engine warranty

MODEL NUMBER	MAX. OUTPUT	HORSEPOWER/ENGINE	SHIP WT.	NET WT.	LIST PRICE
GEN-6000-0MKD	6000 watts	9.1 HP Kohler KD440 OHV, electric start - battery included	295 lb.	273 lb.	\$6,205.00

### Accessories:

PART NUMBER	DESCRIPTION	FITS MODEL	LIST PRICE
32-0915	RV generator adapter - 30A/125V female/male; use to connect RV cordsets to 30A generators	GEN-6000-0MKD	\$127.00
AW-5090-0007	Lifting hook - For easier portability, folds down and out of the way when not in use	GEN-6000-0MKD	\$87.00
AW-5740-0006	Wheel kit - For easier mobility, two flat-free tires and rubber gripped handles	GEN-6000-0MKD	\$344.00
AW-6000-1002	Equipment cover - Keeps your equipment clean, dry and looking like new	GEN-6000-0MKD	\$187.00

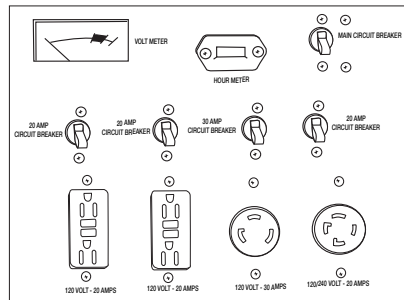

### GEN-6000-0MKD Includes:

- Hour meter
- Voltmeter
- (1) Main circuit breaker
- (2) 120V - 20A receptacles
- (1) 120V/240V - 20A receptacle
- (1) 120V - 30A receptacle
- (3) 20A circuit breakers
- (1) 30A circuit breaker

# Portable Generator Accessories

## Inverter Parallel Port Boxes



(2) GEN-2000-IMMO shown with parallel port box accessory, AW-5100-0001

PART NUMBER	DESCRIPTION	LIST PRICE
AW-5100-0001	Parallel port box - The AW-5100-0001 can be used on either inverter model or combination of both inverters. Includes a 30A, 120V outlet and a 20A, 120V duplex receptacle. The largest appliance that can be run is 3600 watts - even with (2) GEN-3000-IMMO inverters. It is limited by the 30A outlet.	\$180.00
AW-5100-0002	Parallel port box - The AW-5100-0002 can be used on either inverter model or combination of both inverters. Includes a 50A, 120V outlet and a 20A, 120V duplex receptacle. The largest appliance that can be run is 5600 watts - limited by the combined ratings of the machines connected.	\$195.00

## RV Generator Adapter



- Fits generators 3200-watts or higher
- Used to connect RV cordsets to 30A generators

PART NUMBER	DESCRIPTION	LIST PRICE
32-0915	RV generator adapter - 30A/125V female/male	\$127.00

## Lifting Hooks



GEN-5000-0MHO shown with lifting hook option, AW-5090-0003

PART NUMBER	DESCRIPTION	LIST PRICE
AW-5090-0003	Lifting hook - Fits 5000-watt models	\$85.00
AW-5090-0004	Lifting hook - Fits 6000, 7500 & 8000-watt models	\$87.00
AW-5090-0007	Lifting hook - Fits GEN-6000-0MKD	\$87.00
AW-5090-0009	Lifting hook - Fits GEN-3600-0MMO	\$85.00

- Made with 1/4-inch powder coated steel
- Folds down and out of the way when not in use

## Wheel Kits



GEN-7500-0MHE shown with wheel kit option, AW-5740-0010

PART NUMBER	DESCRIPTION	LIST PRICE
AW-5740-0006	Wheel kit - Fits GEN-6000-0MKD	\$344.00
AW-5740-0009	Wheel kit - Fits 5000-watt models	\$221.00
AW-5740-0010	Wheel kit - Fits 6000, 7500 & 8000-watt models	\$221.00

- Two 10-inch flat-free tires
- Dual rubber isolator feet
- Powder coated and rubber gripped handles

## Equipment Cover



PART NUMBER	DESCRIPTION	LIST PRICE
AW-6000-1002	Equipment cover	\$187.00

- Keeps generator clean, dry and looking like new
- Fits generators 6000-watts up to 14000-watts
- Made from 600-denier vinyl-backed polyester



# 9-Gallon Wet/Dry Vacuum & Accessories

Wet/Dry Vacuums

- High impact poly construction canister
- 25-foot electrical cord
- Wet and dry filter - no conversion necessary
- 2 year limited warranty, excludes normal wear items
- Lifetime canister warranty

### Accessories - each unit includes the following:

- 10-foot x 1¼-inch hose with inlet cuff
- 14¼-inch curved plastic wand
- 2-piece aluminum/plastic extension wand
- 12-inch combination floor tool
- 8½-inch crevice tool
- 12-inch commercial squeegee floor tool
- Cartridge filter
- 1 paper filter bag (replacement bags sold in packs of 5)



MV-900-OMEV



MODEL NUMBER	MOTOR	CFM	WATERLIFT	CAPACITY	WATER RECOVERY	SHIP WT.	NET WT.	LIST PRICE
MV-900-OMEV	1.3 HP, 120V, 7.5A, 60Hz	101	87in.	9.0 gallons	6.0 gallons	36 lb.	25 lb.	\$550.00

## Suction Hose & Fitting



15-0242 shown with 50-0178

### Suction Hose - Bulk

- 1¼-inch hose without fittings
- Sold in 10-foot increments; 50-foot maximum length

### Inlet Cuff

- For bulk hose - to connect to vacuum

PART NUMBER	DESCRIPTION	LIST PRICE
15-0242	Suction hose - bulk	\$6.00
50-0178	Inlet cuff	\$10.00

## Wands



16-0403

16-0402

### Aluminum/Plastic Extension Wand

- Quantity of two required to create the wand
- Plastic wand with aluminum inserts

### Curved Plastic Wand

- Connects hand tools to hose

PART NUMBER	DESCRIPTION	LIST PRICE
16-0402	Aluminum/plastic extension wand	\$16.00
16-0403	Curved plastic wand - 14¼-inch	\$11.00

## Filters



19-0221

19-0222

### Cartridge Filter

- For wet and dry use

### Paper Filter Bag

- Disposable, for dry use only
- Recommended for fine dusts

PART NUMBER	DESCRIPTION	LIST PRICE
19-0221	Cartridge filter	\$72.00
19-0222	Paper filter bag - 5 per pack	\$48.00

## Tools

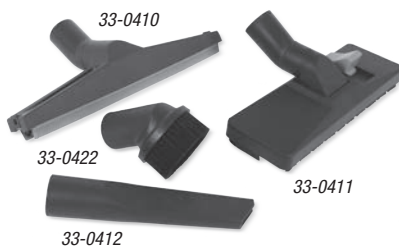

33-0410

33-0422

33-0412

33-0411

### Commercial Squeegee Floor Tool

- Connects directly to extension wand

### Combination Floor Tool

- Connects directly to extension wand

### Crevice Tool

- Connects directly to curved plastic wand

### Dusting Brush

- Connects directly to curved plastic wand

PART NUMBER	DESCRIPTION	LIST PRICE
33-0410	Commercial squeegee floor tool - 12-inch high impact plastic	\$21.75
33-0411	Combination floor tool - 12-inch high impact plastic	\$42.30
33-0412	Crevice tool - 8½-inch high impact plastic	\$5.25
33-0422	Dusting brush - 2½-inch nylon brush	\$34.05

# 15 & 18-Gallon Wet/Dry Vacuums & Accessories

- High impact poly construction canister
- 25-foot electrical cord
- Hydro flow filter for wet and dry applications - no conversion necessary
- 5 year limited warranty, excludes normal wear items
- Lifetime canister warranty

**Accessories - each unit includes the following:**

- 10-foot x 1½-inch crushproof hose
- 2-piece aluminum extension wand
- 14-inch commercial squeegee tool
- 12-inch combination floor tool
- 10¾-inch crevice tool
- 5-inch upholstery tool
- Cartridge filter
- 1 paper filter bag (replacement bags sold in packs of 10)



MODEL NUMBER	MOTOR	CFM	WATERLIFT	CAPACITY	WATER RECOVERY	SHIP WT.	NET WT.	LIST PRICE
MV-1300-0MEV	1.6 HP, 120V, 8.6A, 60Hz	108	111in.	13.0 gallons	9.0 gallons	50 lb.	38 lb.	\$1,000.00
MV-1800-0MEV	1.6 HP, 120V, 8.6A, 60Hz	108	111in.	18.0 gallons	13.0 gallons	55 lb.	44 lb.	\$1,060.00



**Options:**

PART NUMBER	DESCRIPTION	FITS MODELS	LIST PRICE
VX-0001	Vacuum accessories with paper filter bags - Includes 25-foot of 1½-inch crushproof vacuum hose, 10 disposable paper filter bags (19-0610), crevice tool (33-0326) and "claw" suction hand tool (33-0371)	All models	\$40.00
VX-0002	Vacuum accessories with cloth filter bag - Includes 25-foot of 1½-inch crushproof vacuum hose, cloth filter bag (19-0611), crevice tool (33-0326) and "claw" suction hand tool (33-0371)	All models	\$54.00
VX-0003	Vacuum accessories with cloth vacuum bag liner - Includes 25-foot of 1½-inch crushproof vacuum hose, vacuum bag liner (19-0235), crevice tool (33-0326) and "claw" suction hand tool (33-0371)	All models	\$107.00

Note: These options will remove the 2-piece aluminum extension wand (16-0391), combination floor tool (33-0360), commercial squeegee floor tool (33-0359) and the upholstery tool (33-0327) that comes standard with the vacuum.

## Suction Hoses & Fittings



15-0207

**Suction Hose with Fittings**

- 10-foot x 1½-inch crushproof hose with fittings

**Suction Hose - Bulk**

- 1½-inch crushproof hose without fittings
- Sold by the foot; 50-foot maximum length

**Hose Fittings**

**Tapered Cuff End**

- Connects hose to wand or to hose connector

PART NUMBER	DESCRIPTION	LIST PRICE
15-0207	Suction hose	\$54.00
15-0223	Suction hose - bulk	\$6.00
50-0167	Tapered cuff end	\$9.00
50-0168	Hose connector	\$10.00
50-0169	Inlet cuff fitting	\$8.00
852-0156	Hose adapter kit	\$19.00

**Hose Connector**

- Connects tapered cuff end to hose extension

**Inlet Cuff Fitting**

- Connects hose to vacuum

**Hose Adapter Kit**

- Includes one hose connector and one inlet cuff fitting

## Aluminum Extension Wand



16-0391

- Chrome-plated

PART NUMBER	DESCRIPTION	LIST PRICE
16-0391	Aluminum extension wand - 2-piece, friction fit	\$42.00

## Wall Bracket Kit



- Allows for a permanent cleaning station
- Mount vacuum to wall in your shop or home

PART NUMBER	DESCRIPTION	LIST PRICE
AW-9500-0000	Wall bracket kit	\$232.00

# 13 & 18-Gallon Wet/Dry Vacuum Accessories

## Tools



### Crevice Tool

– Connects directly to hose

### Upholstery Tool

– Connects directly to hose

### Dusting Tool

– Connects directly to hose

### Commercial Squeegee Floor Tool

– Connects directly to extension wand

### Replaceable Rubber Blades

– Fits commercial squeegee floor tool, 33-0359

### Combination Floor Tool

– Connects directly to extension wand

### Commercial Nylon Brush Floor Tool

– Connects directly to extension wand

### Power Floor Tool

– Connects directly to extension wand

### "Claw" Suction Hand Tool

– Connects directly to hose

### Accessory Bag & Hose Hanger

– Fits over handle to store tools and hose  
– Made from 600-denier vinyl-backed polyester

PART NUMBER	DESCRIPTION	LIST PRICE
33-0326	Crevice tool - 10 $\frac{3}{4}$ -inch high impact plastic	\$10.35
33-0327	Upholstery tool - 5-inch width, serrated edge, high impact plastic	\$15.60
33-0328	Dusting tool - 2 $\frac{3}{4}$ -inch nylon brush, high impact plastic	\$12.45
33-0359	Commercial squeegee floor tool - 14-inch high impact plastic	\$53.70
33-0397	Replaceable rubber blade - front	\$11.40
33-0398	Replaceable rubber blade - rear	\$11.40
33-0360	Combination floor tool - 12-inch high impact plastic, with adjustable brush height	\$40.35
33-0361	Commercial nylon brush floor tool - 14-inch high impact plastic, nylon brush insert	\$49.50
33-0362	Power floor tool - 10 $\frac{3}{4}$ -inch high impact plastic, air-powered, belt drive	\$110.40
33-0371	"Claw" Suction hand tool - 4-inch high impact plastic	\$10.35
AW-9500-0001	Accessory bag and hose hanger	\$69.00



MV-1800-0MEV shown with accessory bag and hose hanger, AW-9500-0001

## Filters



19-0230

19-0234

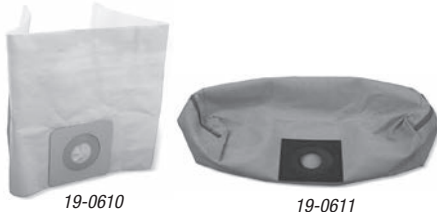

19-0610

19-0611

### Hydro Flow Filter

– For wet and dry applications  
– Completely washable  
– Filters to 1.0-micron

### HEPA (High Efficiency

**Particulate Air) Filter**  
– 99.97% efficient to 0.3-micron  
– Recommended for fine dust and clean room applications

### Paper Filter Bag

– Disposable, for dry use only  
– Recommended for fine dusts

### Cloth Filter Bag

– Reusable, for dry use only  
– Machine washable

PART NUMBER	DESCRIPTION	LIST PRICE
19-0230	Hydro flow filter	\$93.00
19-0234	HEPA filter	\$182.00
19-0610	Paper filter bag - 10 per pack	\$88.00
19-0611	Cloth filter bag	\$124.00

## Vacuum Bag Liner



19-0235

– Fits inside canister to keep filter cartridge clean  
– For dry use only  
– Do not use with paper filter bag

PART NUMBER	DESCRIPTION	LIST PRICE
19-0235	Vacuum bag liner	\$185.00

MODEL NUMBER	CUBIC FEET	DIMENSIONS (LxWxH)	SHIP WT.	NET WT.	LIST PRICE
MB-3619	6.33	36x19x16in.	83 lb.	81 lb.	\$600.00
MB-4822	13.44	48x22x22in.	128 lb.	123 lb.	\$805.00
MB-4830	25.00	48x30x30in.	174 lb.	168 lb.	\$960.00
MB-6024	21.66	60x24x26in.	177 lb.	169 lb.	\$1,000.00



MB-4822

- Heavy-duty solid steel construction with full arc welded seams
- Special powder coated finish for extreme durability
- Full-length concealed hinges are riveted for additional protection and strength
- Convenient swing-out handles for additional mobility

## Tool Trays



MX-22

- Sort and organize your tool box with tool trays
- Tool trays increase inside storage space
- Offers a convenient transportable tray for jobs where you need only select tools

PART NUMBER	FITS MODEL	TRAY DIMENSIONS (LxWxH)	TRAY WT.	LIST PRICE
MX-19	One tray fits MB-3619	16.5x11x3in.	7 lb.	\$73.00
MX-22	Two trays fit MB-4822	19.45x11x3in.	9 lb.	\$73.00
MX-30	Two trays fit MB-4830	27.5x11x3in.	12 lb.	\$81.00
MX-24	Two trays fit MB-6024	21.5x11x3in.	8 lb.	\$73.00

## Casters

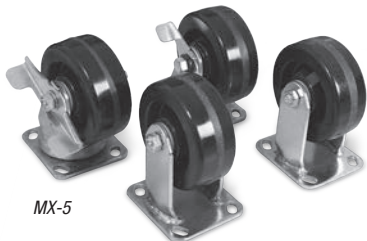

MX-5

- When mobility is a must, casters are the solution
- Casters are industrial strength with ball bearing wheels that allows for smooth rolling over rough surfaces
- Caster sets include 2 rigid and 2 swivels with locks

PART NUMBER	DESCRIPTION	LIST PRICE
MX-4	Casters - 4-inch	\$191.00
MX-5	Casters - 5-inch	\$218.00
MX-6	Casters - 6-inch	\$240.00

# Kerosene/Propane Forced Air Heaters

Portable Heaters

## Kerosene Forced Air Heaters



MH-0190-0M10

- Powder coated hood and fuel tank
- Heavy-duty, high quality cast iron aluminum enclosed electric motor
- Dual connector ignition
- Factory tested for multiple fuels: Kerosene, JP8/Jet A fuel, No. 1 & No. 2 fuel oil, and No. 1 & No. 2 diesel fuel
- 1 year limited warranty

MODEL NUMBER	MH-0075-0M10	MH-0135-0M10	MH-0190-0M10	MH-0215-0M10	MH-0400-0M10	MH-0600-0M10
HEAT OUTPUT	75,000 BTU	135,000 BTU	190,000 BTU	215,000 BTU	400,000 BTU	600,000 BTU
HOT-AIR FLOW	240 CFM	540 CFM	630 CFM	670 CFM	1,400 CFM	3,000 CFM
AIR PUMP PRESSURE	4.0 PSI	5.0 PSI	7.5 PSI	9.0 PSI	125 PSI	128 PSI
AC POWER	120V, 60Hz, 1.5 Amps	120V, 60Hz, 2.3 Amps	120V, 60Hz, 2.7 Amps	120V, 60Hz, 2.8 Amps	120V, 60Hz, 3.0 Amps	120V, 60Hz, 5.5 Amps
MOTOR SIZE	1/8 HP	1/5 HP	1/4 HP	1/3 HP	1/2 HP	5/8 HP
FUEL TANK CAPACITY	5.0 gallons	10.0 gallons	13.0 gallons	13.0 gallons	24.0 gallons	40.0 gallons
FUEL CONSUMPTION	0.56 gal./hr.	1.00 gal./hr.	1.42 gal./hr.	1.63 gal./hr.	3.00 gal./hr.	4.5 gal./hr.
MAX. OPERATING HOURS	8.9 hours	10.0 hours	9.1 hours	8.0 hours	8.0 hours	8.9 hours
HEATING AREA	1,700 sq. ft.	3,100 sq. ft.	4,300 sq. ft.	5,300 sq. ft.	10,000 sq. ft.	15,000 sq. ft.
SHIP WT.	33 lb.	57 lb.	65 lb.	68 lb.	159 lb.	376 lb.
NET WT.	28 lb.	51 lb.	58 lb.	61 lb.	150 lb.	320 lb.
LIST PRICE	\$435.00	\$590.00	\$680.00	\$795.00	\$2,730.00	\$4,470.00

## Propane Forced Air Heaters



MH-0375-LM10

- Heavy-duty steel construction
- One touch electronic ignition and heat control for easy operation
- Enclosed gas controls
- Propane inlet connector - connects heater to propane tank via a supply hose
- 1 year limited warranty

MODEL NUMBER	MH-0060-LM10	MH-0150-LM10	MH-0150-LM10*	MH-0150-NM10*	MH-0375-LM10*
HEAT OUTPUT	40-50-60,000 BTU	120-135-150,000 BTU	150,000 BTU	150,000 BTU	225-375,000 BTU
HOT-AIR FLOW	300 CFM	400 CFM	400 CFM	435 CFM	1,500 CFM
AC POWER	120V, 60Hz, Less than 1.0 Amp	120V, 60Hz, Less than 1.0 Amp	120V, 60Hz, Less than 1.0 Amp	120V, 60Hz, Less than 1.0 Amp	120V, 60Hz, 1.45 Amps
MOTOR SIZE	1/10 HP	1/9 HP	1/9 HP	1/9 HP	1/5 HP
FUEL	Propane	Propane	Propane	Natural Gas	Propane
FUEL CONSUMPTION	1.9/2.3/2.8 lb./hr.	5.5/6.2/6.9 lb./hr.	6.9 lb./hr.	146 cu. ft./hr.	10.4 to 17.4 lb./hr.
REQUIRED CYLINDER SIZE	20 lb.	100 lb.	100 lb.	N/A	(2) 100 lb.
MAX. OPERATING HOURS (PER REQUIRED CYLINDER SIZE)	10.5 hours	18.0 hours	18.0 hours	N/A	11.5 hours
HEATING AREA	1,500 sq. ft.	3,800 sq. ft.	3,800 sq. ft.	3,800 sq. ft.	9,000 sq. ft.
SHIP WT.	19 lb.	29 lb.	29 lb.	35 lb.	49 lb.
NET WT.	15 lb.	23 lb.	23 lb.	24 lb.	41 lb.
LIST PRICE	\$285.00	\$365.00	\$595.00	\$640.00	\$965.00

\*Includes thermostat.

### Accessory:

PART NUMBER	DESCRIPTION	FITS MODELS	LIST PRICE
68-5010	Two cylinder manifold - Connects any two propane cylinders	All models	\$50.00

# Convection & Kerosene Radiant Heaters

## Gas-Fired Convection Heaters



- 360-degree heat radius for even heating
- Durable steel housing
- Variable heat settings
- 1 year limited warranty

MODEL NUMBER	MH-0080-CM10	MH-0200-CM10
HEAT OUTPUT	60-80,000 BTU	50-200,000 BTU
HOT-AIR FLOW	N/A	N/A
IGNITION TYPE	Automatic (integral)	Push-button
FUEL	Propane	Propane
FUEL CONSUMPTION	2.3 / 3.7 lb./hr.	3.24 / 9.25 lb./hr.
OPERATING TIME (100 LB. CYL.)	43 / 27 hours	31 / 11 hours
OPERATING TIME (40 LB. CYL.)	17 / 11 hours	N/A
OPERATING TIME (20 LB. CYL.)	8 / 5 hours	N/A
SUGGESTED CYLINDER SIZE	100 lb.	100 lb.
INLET GAS PRESSURE	N/A	N/A
HEATING AREA	1,800 sq. ft.	4,600 sq. ft.
STAINLESS-STEEL BURNER	No	No
SHIP WT.	17 lb.	20 lb.
NET WT.	11.5 lb.	14 lb.
LIST PRICE	\$185.00	\$235.00



MH-0200-0M10

### Accessory:

PART NUMBER	DESCRIPTION	FITS MODELS	LIST PRICE
68-5010	Two cylinder manifold - Connects any two propane cylinders	All models	\$50.00

## Kerosene Radiant Heater



- Fully enclosed motor
- Easy lift handle for portability at home or on the jobsite
- Clean, quiet, instant radiant heat
- Factory tested for multiple fuels: Kerosene, JP8/Jet A fuel, No. 1 and No. 2 fuel oil, and No. 1 and No. 2 diesel
- 1 year limited warranty

MODEL NUMBER	MH-0125-3M1R
HEAT OUTPUT	125,000 BTU
HEAT FLOW	Radiant
AC POWER	120V, 60Hz, 5.0 Amps
FUEL TANK CAPACITY	14.0 gallons
FUEL CONSUMPTION	0.85 gal./hr.
MAX. OPERATING HOURS	20.0 hours
HEATING AREA	3,125 sq. ft.
SHIP WT.	91 lb.
NET WT.	68 lb.
LIST PRICE	\$1,985.00



MH-0125-3M1R

## Propane Tank-Top Radiant Heaters



- Safety shut-off valve
- High efficiency heat reflector
- Clean, quiet, instant radiant heat
- 1 year limited warranty

MODEL NUMBER	MH-0015-IM10	MH-0030-IM10
HEAT OUTPUT (SINGLE BURNER)*	L-9,000 / M-12,000 / H-16,000 BTU	L-9,000 / M-12,000 / H-16,000 BTU
HEAT OUTPUT (DOUBLE BURNER)*	N/A	L-18,000 / M-24,000 / H-32,000 BTU
IGNITION TYPE	Match light	Match light
HEAT SETTINGS	3	6
PROPANE CYLINDER SIZE	20 lb.	20 lb.
MAX. OPERATING HOURS (20 LB. CYL)*	L-48 / M-36 / H-27 hours	L-48 / M-18 / H-14 hours
SHIP WT.	3 lb.	6 lb.
NET WT.	2 lb.	5 lb.
LIST PRICE	<b>\$75.00</b>	<b>\$170.00</b>

\*Heat output and operating hours have Low, Medium and High settings.



MH-0015-IM10

## Propane Radiant Outdoor Patio Heater



- 360-degree heat radius for even heating
- Heavy-duty stainless-steel emitter screen
- Variable heat settings
- 1 year limited warranty

MODEL NUMBER	<b>MH-0040-PM10</b>
HEAT OUTPUT*	L-22,500 / H-40,000 BTU
FUEL	Propane
FUEL CONSUMPTION	1.86 lb./hr.
MANIFOLD PRESSURE	11in. WC
OPERATING TIME (20 LB. CYL.)	10.8 hours
SUGGESTED CYLINDER SIZE	20 lb.
HEATING AREA	210 sq. ft.
BASE DIAMETER	18in.
SHIP WT.	68 lb.
NET WT.	59 lb.
LIST PRICE	<b>\$510.00</b>

\*Heat output has Low and High settings.



MH-0040-PM10

# Propane Cabinet Utility Heater

## Propane Cabinet Utility Heater



- Clean, quiet instant radiant heat
- Variable heat control knob
- Powder coated cabinet
- 1 year limited warranty

<b>MODEL NUMBER</b>	<b>MH-0018-0M10</b>
<b>HEAT OUTPUT</b>	18,000 BTU
<b>FUEL TANK CAPACITY</b>	20 lb. propane cylinder (not included)
<b>FUEL CONSUMPTION</b>	Low 65 hours/20 lb. High 24 hours/20 lb.
<b>MAX. OPERATING HOURS</b>	65 hours/20 lb.
<b>HEATING AREA</b>	600 sq. ft.
<b>SHIP WT.</b>	34.9 lb.
<b>NET WT.</b>	22 lb.
<b>LIST PRICE</b>	<b>\$240.00</b>



MH-0018-0M10



## 2-Inch Pumps



WTP-S02-1MGH

- Silicon carbide mechanical seal for longevity and performance
- Precision molded cast iron impeller and volute for reduced vibration and wear
- 9,720 gph maximum capacity
- 1 year limited Mi-T-M engine warranty
- 2 year limited pump warranty
- 3 year limited Honda engine warranty

MODEL NUMBER	SUCTION DISCHARGE SIZE	DISPLACEMENT/ENGINE	MAX. TOTAL HEAD	SUCTION LIFT	SHIP WT.	NET WT.	LIST PRICE
WTP-S02-1MGH	2in. x 2in.	118cc Honda GX120 OHV	115ft.	28ft.	71 lb.	62 lb.	\$1,000.00
WTP-S02-1MGM^	2in. x 2in.	136cc Mi-T-M OHV	115ft.	28ft.	72 lb.	63 lb.	\$710.00
WTP-S02-CMGM*	2in. x 2in.	136cc Mi-T-M OHV	115ft.	28ft.	72 lb.	63 lb.	\$710.00

^Model available in US only.

\*Model available in US and Canada.

### Accessories:

PART NUMBER	DESCRIPTION	FITS MODELS	LIST PRICE
15-0293	20-foot x 2-inch green PVC hard suction hose with fittings	All models	\$194.00
15-0295	50-foot x 2-inch blue PVC soft discharge hose	All models	\$173.00
19-0628	2-inch steel suction strainer with round openings	All models	\$51.00
70-0524	2-inch suction and discharge kit - Includes 20-foot x 2-inch green PVC hard suction hose with fittings, 50-foot x 2-inch blue PVC soft discharge hose and steel suction strainer with round openings	All models	\$365.00



2-in. suction and discharge kit, 70-0524, includes:  
20-ft. x 2-in. green PVC hard suction hose with fittings,  
50-ft. x 2-in. blue PVC soft discharge hose and  
2-in. steel suction strainer with round openings

## 3-Inch Pumps



WTP-S03-2MGM

- Silicon carbide mechanical seal for longevity and performance
- Precision molded cast iron impeller and volute for reduced vibration and wear
- 16,560 gph maximum capacity
- 1 year limited Mi-T-M engine warranty
- 2 year limited pump warranty
- 3 year limited Honda engine warranty

MODEL NUMBER	SUCTION DISCHARGE SIZE	DISPLACEMENT/ENGINE	MAX. TOTAL HEAD	SUCTION LIFT	SHIP WT.	NET WT.	LIST PRICE
WTP-S03-1MGH	3in. x 3in.	196cc Honda GX200 OHV	104ft.	28ft.	82 lb.	73 lb.	\$1,090.00
WTP-S03-2MGM	3in. x 3in.	212cc Mi-T-M OHV	104ft.	28ft.	82 lb.	73 lb.	\$790.00

### Accessories:

PART NUMBER	DESCRIPTION	FITS MODELS	LIST PRICE
15-0294	20-foot x 3-inch green PVC hard suction hose with fittings	All models	\$366.00
15-0296	50-foot x 3-inch blue PVC soft discharge hose	All models	\$278.00
19-0629	3-inch steel suction strainer with round openings	All models	\$81.00
70-0525	3-inch suction and discharge kit - Includes 20-foot x 3-inch green PVC hard suction hose with fittings, 50-foot x 3-inch blue PVC soft discharge hose and steel suction strainer with round openings	All models	\$672.00



3-in. suction and discharge kit, 70-0525, includes:  
20-ft. x 3-in. green PVC hard suction hose with fittings,  
50-ft. x 3-in. blue PVC soft discharge hose and  
3-in. steel suction strainer with round openings

# Trash Pumps

## 3-Inch Pump

MODEL NUMBER	SUCTION DISCHARGE SIZE	DISPLACEMENT/ENGINE	MAX. TOTAL HEAD	SUCTION LIFT	SHIP WT.	NET WT.	LIST PRICE
WTP-T03-OMGH	3in. x 3in.	270cc Honda GX270 OHV	95ft.	26ft.	177 lb.	152 lb.	\$2,475.00

### Accessories:

PART NUMBER	DESCRIPTION	FITS MODEL	LIST PRICE
15-0294	20-foot x 3-inch green PVC hard suction hose with fittings	WTP-T03-OMGH	\$366.00
15-0296	50-foot x 3-inch blue PVC soft discharge hose	WTP-T03-OMGH	\$278.00
19-0629	3-inch steel suction strainer with round openings	WTP-T03-OMGH	\$81.00
70-0525	3-inch suction and discharge kit - Includes 20-foot x 3-inch green PVC hard suction hose with fittings, 50-foot x 3-inch blue PVC soft discharge hose and steel suction strainer with round openings	WTP-T03-OMGH	\$672.00
AW-5740-0017	Wheel kit - For easier mobility, two flat-free tires and rubber gripped handles	WTP-T03-OMGH	\$229.00

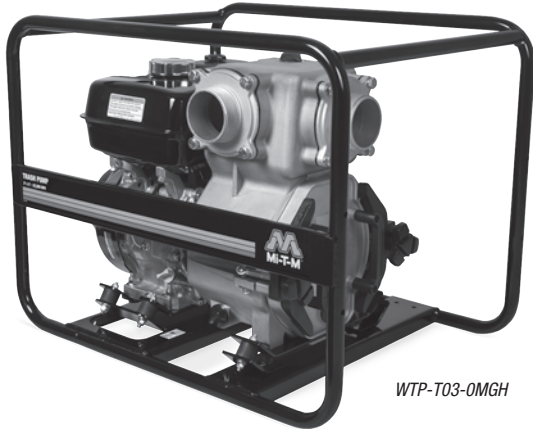

WTP-T03-OMGH

- Silicon carbide mechanical seal for longevity and performance
- Cast iron impeller and volute for reduced vibration and wear
- 370 GPM maximum capacity
- 2 year limited pump warranty
- 3 year limited Honda engine warranty



3-in. suction and discharge kit, 70-0525, includes:  
20-ft. x 3-in. green PVC hard suction hose with fittings,  
50-ft. x 3-in. blue PVC soft discharge hose and  
3-in. steel suction strainer with round openings

## 4-Inch Pump

MODEL NUMBER	SUCTION DISCHARGE SIZE	DISPLACEMENT/ENGINE	MAX. TOTAL HEAD	SUCTION LIFT	SHIP WT.	NET WT.	LIST PRICE
WTP-T04-OMGH	4in. x 4in.	389cc Honda GX390 OHV	95ft.	26ft.	192 lb.	167 lb.	\$2,990.00

### Accessories:

PART NUMBER	DESCRIPTION	FITS MODEL	LIST PRICE
15-0356	20-foot x 4-inch green PVC hard suction hose with fittings	WTP-T04-OMGH	\$719.00
15-0357	50-foot x 4-inch blue PVC soft discharge hose	WTP-T04-OMGH	\$555.00
19-0277	4-inch steel suction strainer with round openings	WTP-T04-OMGH	\$111.00
70-0661	4-inch suction and discharge kit - Includes 20-foot x 4-inch green PVC hard suction hose with fittings, 50-foot x 4-inch blue PVC soft discharge hose and steel suction strainer with round openings	WTP-T04-OMGH	\$1,492.00
AW-5740-0017	Wheel kit - For easier mobility, two flat-free tires and rubber gripped handles	WTP-T04-OMGH	\$229.00

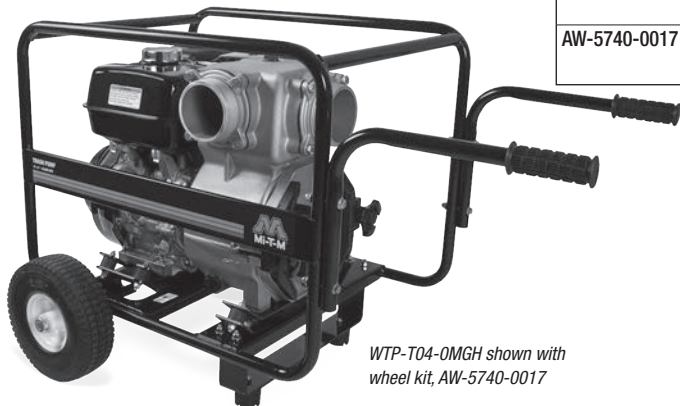

WTP-T04-OMGH shown with  
wheel kit, AW-5740-0017

- Silicon carbide mechanical seal for longevity and performance
- Cast iron impeller and volute for reduced vibration and wear
- 580 GPM maximum capacity
- 2 year limited pump warranty
- 3 year limited Honda engine warranty



4-in. suction and discharge kit, 70-0661, includes:  
20-ft. x 4-in. green PVC hard suction hose with fittings,  
50-ft. x 4-in. blue PVC soft discharge hose and  
4-in. steel suction strainer with round openings

## Extended Hours

To serve you better, our customer service hours of operation are:

Monday - Friday 7:30 am to 5:30 pm CST

Products may be ordered and inquiries may be sent 24 hours a day, 7 days a week via fax or e-mail.

## How To Order

Units and accessories are ordered through authorized Mi-T-M dealers and distributors.

- Be prepared to advise the Mi-T-M Customer Service Representative of your Mi-T-M account number, model numbers, parts and descriptions.
- Indicate your purchase order number and full name on order.
- Specify exact shipping instructions.
- With fax and/or mail-in orders, give full name, Mi-T-M account number, zip code, and telephone number.

### Phone

563-556-7484  
800-553-9053

### Fax

563-556-1235

### Mail

50 Mi-T-M Drive, P.O. Box 50  
Peosta, IA 52068

### Internet

www.mitm.com

### E-mail

corp@mitm.com

## Internet - www.mitm.com

Our website may be instantly accessed and offers:

- 4-color viewing of products and specifications
- A site search to find the equipment that's right for you
- How-To Videos
- Quick e-mail access for questions and information requests about specific models or product lines
- Mi-T-M on-line parts ordering and access to parts listings for the full Mi-T-M product lines
- Company profile including Who's Who at Mi-T-M
- A listing of service centers throughout the country

## Sales Policy

Products are sold through authorized Mi-T-M Dealers, National Accounts and Original Equipment Manufacturer's (OEM) as recognized by Mi-T-M. All new customers must complete a credit application. Mi-T-M will perform a credit check, and upon approval the customer will receive an account number and a line of credit.

## Production Schedule

Customers can anticipate a lead time of one week for cold water pressure washers, air compressors, air compressor/generator combinations, air compressor/generator/welder combinations, portable generators, portable heaters, jobsite boxes, wet/dry vacuums and water pumps; a two week lead time for hot water pressure washers. Special units will require additional lead time.

## Shipping

Orders shipped without specific shipping instructions are shipped "best way" as determined by the Mi-T-M shipping department. Mi-T-M assumes no responsibility and makes no guarantees regarding air freight deliveries. Please allow seven working days before requesting tracking on lost or late shipments. In an effort to deliver Mi-T-M products to our customers in a timely manner, Mi-T-M developed a program where whole goods (pressure washers, air compressors, air compressor/generator combinations, air compressor/generator/welder combinations, portable generators, portable heaters, jobsite boxes, wet/dry vacuums and water pumps) and parts are shipped from separate locations in our facility. Our freight policy has not changed. Our customers are still responsible for outgoing freight on parts and whole goods. This may be altered by any minimum qualifying freight programs. Our goal is to process all orders as soon as we receive them, our system will no longer allow additional items to be added to a previously processed order. Any additional orders will be handled as new orders.

## Freight Terms

- All water treatment systems and parts – F.O.B. Peosta
- Any combination of pressure washers, air compressors, air compressor/generator combinations, air compressor/generator/welder combinations, portable generators, portable heaters, wet/dry vacuums or water pumps – may qualify for prepaid freight
- Jobsite boxes – prepaid on 1,000 lbs. or more
- Parts – prepaid and add
- Detergents – prepaid on twelve cases
- Trailer units – prepaid and add

## Warranty

All warranty claims and returns of goods for repair shall be governed by the express terms of the Mi-T-M warranty, as provided in the conditions of our warranty, and limited to the replacement of defective parts, as provided in the conditions of the Mi-T-M warranty. To submit a warranty claim online go to [www.mitm.com](http://www.mitm.com) and click on Warranty Claims (top right corner).

## Merchandise Return

Mi-T-M must be contacted before any product is returned. The customer will receive a Returned Goods Authorization (RGA) number prior to the item being returned. Mi-T-M reserves the right to refuse returned products. Products must be in new and resalable condition. Products must be current production components. All products must be returned freight prepaid at shippers expense. Products returned C.O.D. for any reason will be refused. Credit not to exceed original purchase price will be issued for approved returned products. Returns are subject to a 20% restocking fee.

## Submission of Claims

All damages to merchandise – either internal or external – must be reported to the carrier shipping such merchandise, to permit an inspection report to be filed immediately. Claims of shortage of cartons, crates or boxes must be properly submitted to the carrier; claims for errors or shortages of contents must be submitted to Mi-T-M within 24 hours after delivery of such merchandise.

**In a continued commitment to improve quality, Mi-T-M reserves the right to make component or design changes when necessary.**

<b>Cold Water Pressure Washers</b>	<b>p3-9</b>	<b>Air Compressor/Generator Combinations</b>	<b>p35-37</b>
CD Gasoline Series	p3	8-Gallon or Base-Mount Gasoline	p35
JP Gasoline Series	p3	30-Gallon Gasoline	p36
CA Gasoline Series	p4	30-Gallon Diesel	p37
CBA Gasoline Series	p4	<b>Air Compressor/Generator/Welder Combinations</b>	<b>p38</b>
JCW Gasoline Series	p5	20-Gallon Gasoline	p38
CW Premium Gasoline Series	p5	30-Gallon Gasoline	p38
CWC Premium Gasoline Series	p6	Base-Mount Gasoline	p38
CW Premium Diesel Series	p6	<b>Air Compressor Accessories</b>	<b>p39-43</b>
CD Electric Series	p7	<b>Portable Generators</b>	<b>p44-48</b>
JP Electric Series	p7	Inverters	p44
CW Premium Electric Series	p8	ChoreMaster® Series Gasoline	p45
CW Premium Electric Stationary Series	p9	3000 & 5000-Watt Gasoline	p46
<b>Hot Water Pressure Washers</b>	<b>p9-14</b>	6000, 7500 & 8000-Watt Gasoline	p46
HSP Gasoline Series	p9	14000-Watt Gasoline	p47
HS Gasoline/Diesel Series	p10	6000-Watt Diesel	p47
Single & Dual-Axle Trailers	p11	Portable Generator Accessories	p48
HSE Electric Series	p12	<b>Wet/Dry Vacuums</b>	<b>p49-51</b>
HAE All-Electric Series	p13	9-Gallon Vacuum, Accessories & Replacement Parts	p49
HG Natural Gas/LP Series	p14	13 & 18-Gallon Vacuums, Accessories & Replacement Parts	p50-51
<b>Pressure Washers Accessories</b>	<b>p15-21</b>	<b>Jobsite Boxes &amp; Accessories</b>	<b>p52</b>
<b>Water Transport Trailer</b>	<b>p22</b>	<b>Portable Heaters</b>	<b>p53-56</b>
<b>PWR Series</b>	<b>p23</b>	Kerosene Forced Air Heater	p53
<b>Air Compressors</b>	<b>p24-34</b>	Propane Forced Air Heater	p53
Work Pro® Series – 3, 4 & 5-Gallon Electric	p24	Gas-Fired Convection Heater	p54
Work Pro® Series – 5-Gallon Gasoline	p24	Kerosene Radiant Heater	p54
Work Pro® Series – 8-Gallon Electric/Gasoline	p25	Propane Tank-Top Radiant Heater	p55
5-Gallon Gasoline	p25	Propane Radiant Outdoor Patio Heater	p55
8-Gallon Single Stage Gasoline	p26	Propane Cabinet Utility Heater	p56
20-Gallon Single Stage Gasoline	p26	<b>Water Pumps</b>	<b>p57-58</b>
8-Gallon Two Stage Gasoline	p27	2-Inch Semi-Trash Pumps	p57
20-Gallon Two Stage Gasoline	p27	3-Inch Semi-Trash Pumps	p57
30 & 80-Gallon Two Stage Gasoline or Base-Mount	p28	3 & 4-Inch Trash Pumps	p58
30-Gallon Diesel	p29	<b>Ordering Information</b>	<b>p59</b>
5-Gallon Electric	p29		
8-Gallon Single Stage Electric	p30		
20-Gallon Single Stage Electric	p30		
80 & 120-Gallon Two Stage Electric Simplex	p31		
80 & 120-Gallon Two Stage Electric Duplex	p32		
80 & 120-Gallon Two Stage Electric			
Simplex and Duplex – M Series	p33		
Rotary Screw	p34		

POWERED by **HONDA**

Pressure Washers · Air Compressors · Portable Generators  
 Air Compressor/Generator Combinations  
 Air Compressor/Generator/Welder Combinations  
 Wet/Dry Vacuums · Jobsite Boxes · Portable Heaters  
 Water Pumps · Water Treatment Systems



50 Mi-T-M Drive  
 Peosta, IA 52068  
 800-553-9053 · 563-556-7484  
 Fax 563-556-1235  
 www.mitm.com  
 corp@mitm.com



©Copyright 2018, Mi-T-M® Corporation  
 64-6063/Mi7015/111517

Distributed by: